

**SOIL/SITE EVALUATION**  
**for ON-SITE WASTEWATER SYSTEM**

Owner:

Applicant:

Address:

Date Evaluated:

Proposed Facility: 3 bedroom home Design Flow (.1949): 360 gpd

Property Size:

Location of Site:

Property Recorded:

Water Supply:  Public  Individual  Well  Spring  Other  
 Evaluation Method:  Auger Boring  Pit  Cut  
 Type of Wastewater:  Sewage  Industrial Process  Mixed

P R O F I L E #	.1940 Landscape Position/ Slope%	Horizon Depth (IN.)	SOIL MORPHOLOGY .1941		OTHER PROFILE FACTORS				Profile Class & LTAR
			.1941 Structure/ Texture	.1941 Consistence Mineralogy	.1942 Soil Wetness/ Color	.1943 Soil Depth (IN.)	.1956 Sapra Class	.1944 Restr. Horiz	
1	LS 2-5%	0-3"	G L	VFL NS/NP					
			HAR @ 3"						
2			HAR @ 4"						
3		0-6"	G S	VFL NS/NP					
		6-12"	SBX C	F1 S/P	10YR 7/1 @ 10"				US
4		0-12"	G S	VFL NS/NP					
		12-18"	SBX C	F1 S/P	10YR 7/1 @ 14"				US
5		0-16"	G SL	VFL NS/NP					
		16-36"	SBX SCL	F2 S/S/P	10YR 7/1 @ 34"				PS .4
6		0-20"	G SL	VFL NS/NP					
		20-34"	SBX SCL	F2 S/S/P	CR @ 34"				PS .4
7		0-18"	G SL	VFL NS/NP					
		18-36"	SBX SCL	F2 S/S/P	CR @ 34"				PS .4
8		0-20"	G SL	VFL NS/NP					
		20-36"	SBX SCL	F2 S/S/P					PS .4

Description	Initial System	Repair System
Available Space (.1945)	<input checked="" type="checkbox"/>	<input checked="" type="checkbox"/>
System Type(s)	CON	25% REO.
Site LTAR	.4	.4

Other Factors (.1946):

Site Classification (.1948): PS

Evaluated By: DT

Others Present:

1x225' @ 18"

COMMENTS: \_\_\_\_\_

<u>LANDSCAPE POSITIONS</u>	<u>GROUP</u>	<u>TEXTURES</u>	<u>.1955 LTAR</u>	<u>CONSISTENCE MOIST</u>	<u>WET</u>
R-RIDGE	I	S-SAND	1.2 - 0.8	VFR-VERY FRIABLE	NS-NON-STICKY
S-SHOULDER SLOPE		LS-LOAMY SAND			
L-LINEAR SLOPE	II	SL-SANDY LOAM	0.8 - 0.6	FR-FRIABLE	SS-SLIGHTLY STICKY
FS-FOOT SLOPE		L-LOAM			
N-NOSE SLOPE	III	SI-SILT-	0.6 - 0.3	FI-FIRM	S-STICKY
H-HEAD SLOPE		SIL-SILT LOAM			
CC-CONCLAVE SLOPE		CL-CLAY LOAM			
CV-CONVEX SLOPE		SCL-SANDY CLAY LOAM			
T-TERRACE	IV	SIC-SILTY CLAY	0.4 - 0.1	VFI-VERY FIRM	VS-VERY STICKY
FP-FLOOD PLAN		SC-SANDY CLAY			
		SICL-SILTY CLAY LOAM		EFI-EXTREMELY FIRM	NP-NON-PLASTIC
					SP-SLIGHTLY STICKY
					P-PLASTIC
					VP-VERY PLASTIC

STRUCTURE

- SG-SINGLE GRAIN
- M-MASSIVE
- CR-CRUMB
- GR-GRANULAR
- SBK-SUBANGULAR BLOCKY
- ABK-ANGULAR BLOCKY
- PL-PLATY
- PR-PRISMATIC

MINERALOGY

- SLIGHTLY EXPANSIVE
- EXPANSIVE

Show profile locations and other site features (dimensions, reference or benchmark, and North).

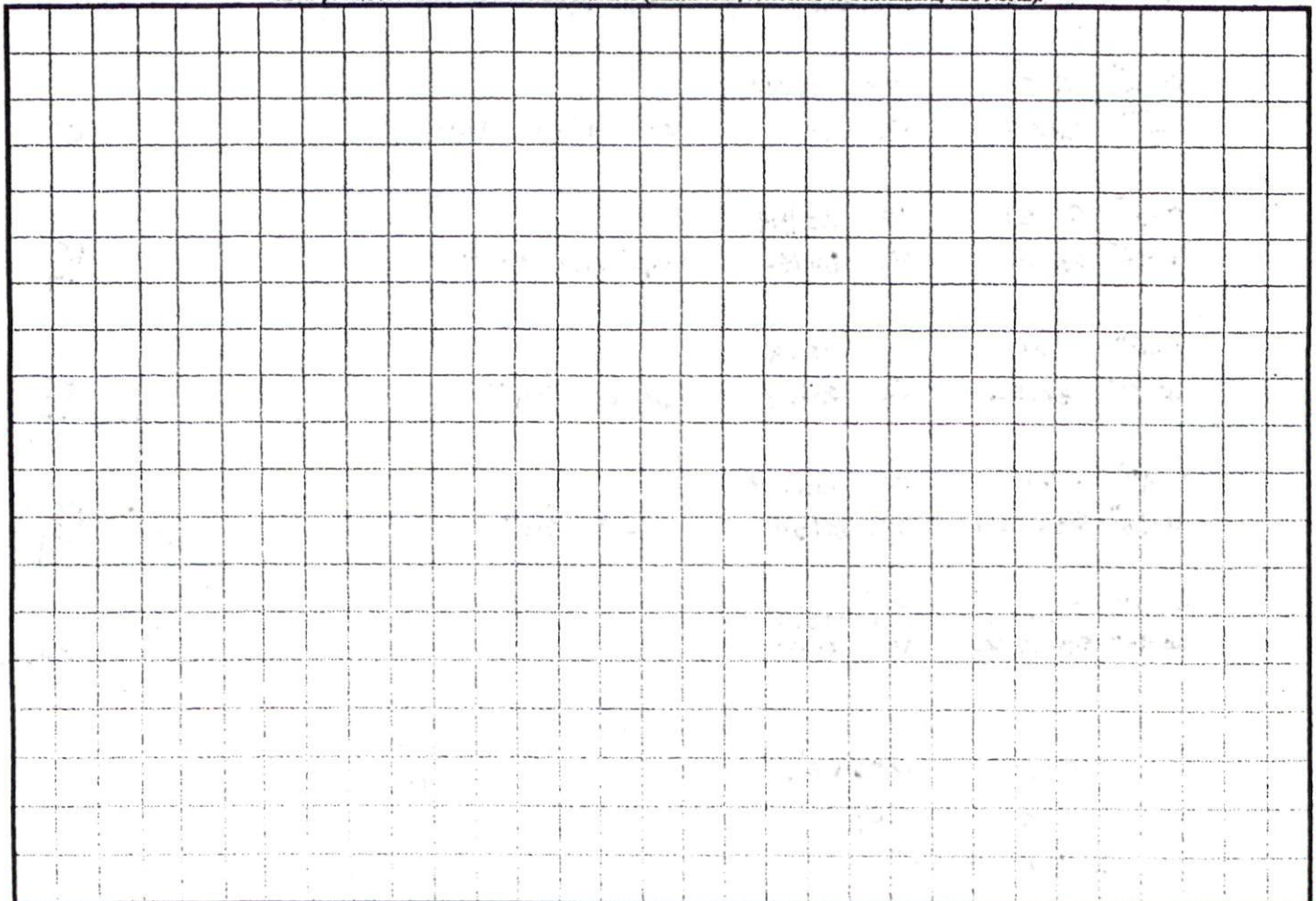

1=60

SITE PLAN APPROVAL

DISTRICT RAZOR USE SFP

#BEDROOMS 3

5-6-09

Date

[Signature]  
Zoning Administrator

242

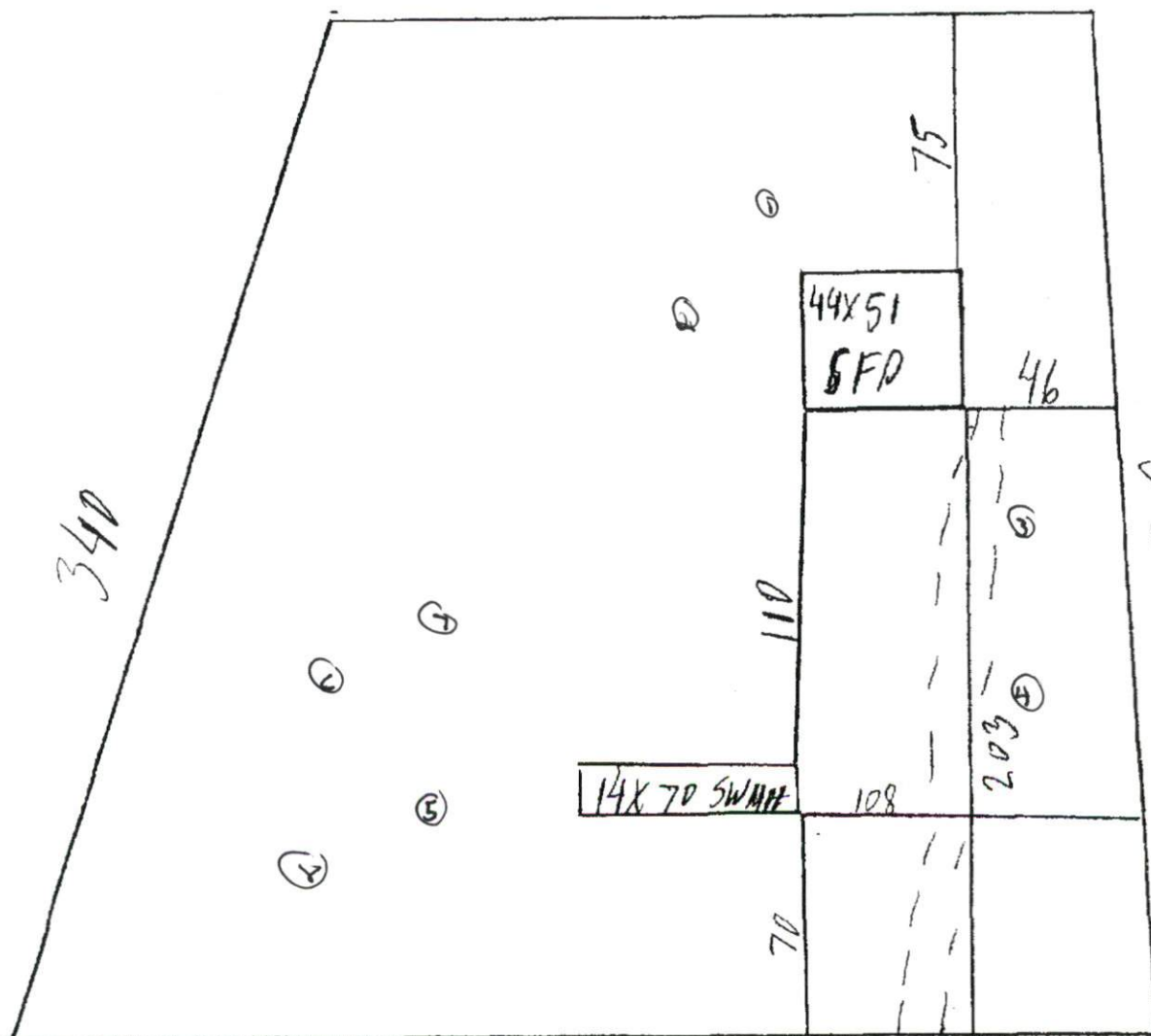

West HWY 27 East