

HTE# 09-500-21511

Harnett County Department of Public Health

25245

Improvement Permit

A building permit cannot be issued with only an Improvement Permit

ISSUED TO: CAVINCS Land
PROPERTY LOCATION: 1125
SUBDIVISION: Woodshire
LOT # 194
Type of Structure: SFO-56x40-3BR
Proposed Wastewater System Type: 25% Reduction System
Projected Daily Flow: 360 GPD
Number of bedrooms: 3
Number of Occupants: 6 max
Basement: No
Pump Required: May be required based on final location and elevations of facilities
Type of Water Supply: Public
Permit conditions: Meet on site for final layout maintain all set backs
Authorized State Agent: J. W. A. Date: 02-13-09

Construction Authorization

(Required for Building Permit)

The construction and installation requirements of Rules .1950, .1952, .1954, .1955, .1956, .1957, .1958, and .1959 are incorporated by references into this permit and shall be met.

ISSUED TO: CAVINCS Land
PROPERTY LOCATION: 1125
SUBDIVISION: Woodshire
LOT # 194
Facility Type: SFO-56x40-3BR
Basement? No
Type of Wastewater System: 25% Reduction System
Installation Requirements/Conditions:
Septic Tank Size: 1000 gallons
Pump Tank Size:
Number of trenches: 1
Exact length of each trench: 180 feet
Trench Spacing: 9 Feet on Center
Soil Cover: 6 inches
Pump Requirements:
Conditions:

**If applicable: I understand the system type specified is different from the type specified on the application. I accept the specifications of this permit.
Owner/Legal Representative Signature:
Date:

This Construction Authorization is subject to revocation if the site plan, plat, or the intended use changes. The Construction Authorization shall not be transferred when there is a change in ownership of the site.
Construction Authorization is subject to compliance with the provisions of the Laws and Rules for Sewage Treatment and Disposal and to the conditions of this permit.
SEE ATTACHED SITE SKETCH
Authorized State Agent: J. W. A. Date: 02-13-09
Construction Authorization Expiration Date: 02-13-2014

HTE# 09-500-21511

Permit # 25245

Harnett County Department of Public Health Site Sketch

ISSUED TO: Caviness Land

PROPERTY LOCATOR: 1125
SUBDIVISION: Woodshire LOT # 194

Authorized State Agent: J. Coan
102

Date: 02-13-09

Meet onsite for final layout
maintain all setback,
stub out plumbing shallow
at ground level or higher
where shown

Install 180' of 21%
Reduction system at
18 to 24" Deep.

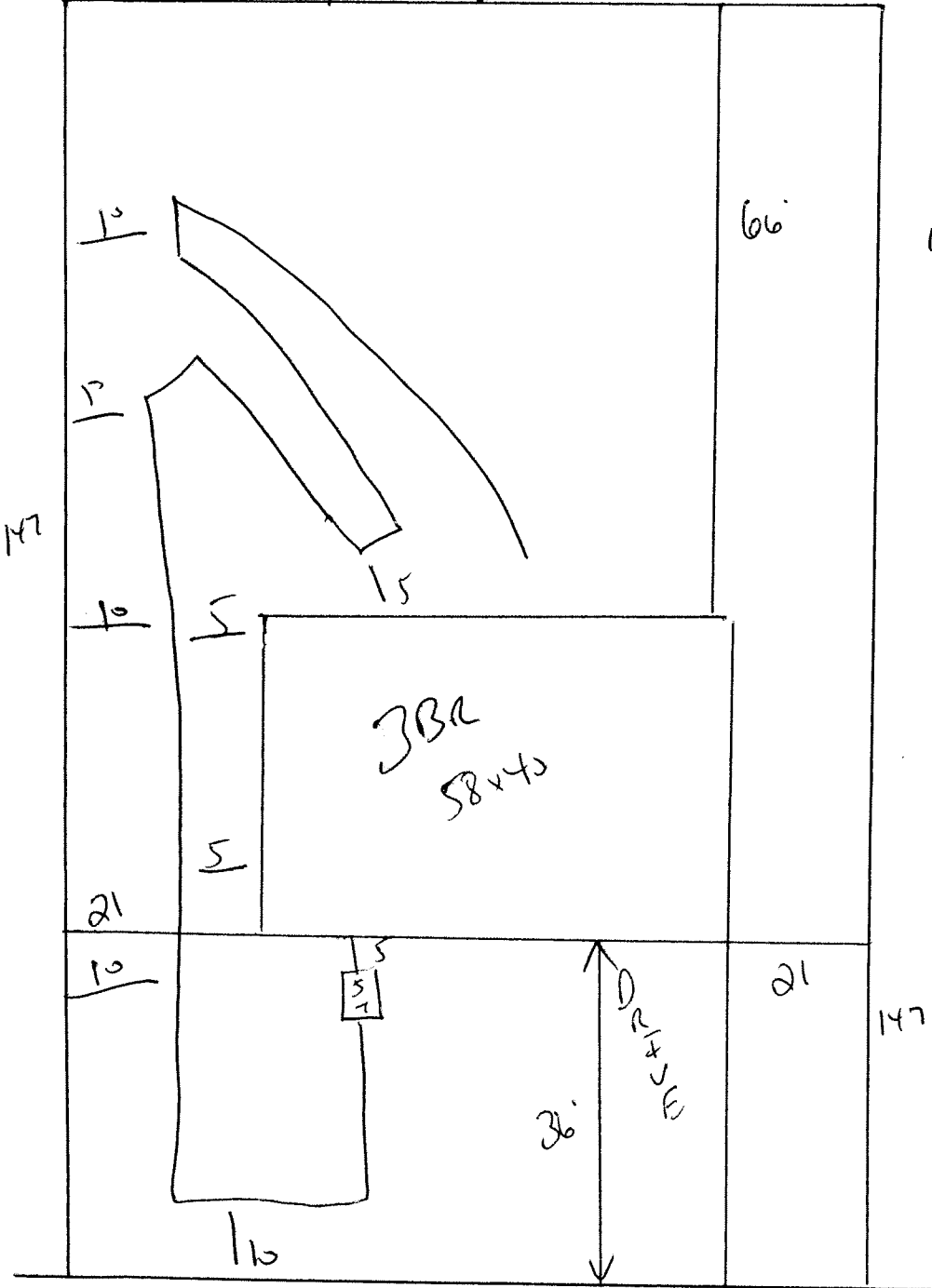

102
Blue Oak