

**SOIL/SITE EVALUATION
 for ON-SITE WASTEWATER SYSTEM**

Owner: 09-500-21418

Applicant:

Address:

Date Evaluated:

Proposed Facility: SFD

Design Flow (.1949): 240

Property Size:

Location of Site: 1109

Property Recorded:

Water Supply: Public [] Individual [] Well [] Spring [] Other
 Evaluation Method: [] Auger Boring [] Pit [] Cut
 Type of Wastewater: [] Sewage [] Industrial Process [] Mixed

P R O F I L E #	.1940 Landscape Position/ Slope%	Horizon Depth (IN.)	SOIL MORPHOLOGY .1941		OTHER PROFILE FACTORS				Profile Class & LTAR
			.1941 Structure/ Texture	.1941 Consistence Mineralogy	.1942 Soil Wetness/ Color	.1943 Soil Depth (IN.)	.1956 Sapro Class	.1944 Restr Horiz	
		0.08	Gr JL	VFR S-					.6
		0.24	Gr JL	VFR S-					.5
		24.28	SDH SCL	FR S-					
		0.18	Gr SL	VFR S-					
		14.36	SBK JCL	FR S-					.4
		36.40	SDK JL	FR S-					
		12.30	Gr JL	VFR S-					
		30.28	SDK JCL	FR S-					.5
		0.30	Gr SL	VFR S-					
		30.28	SDK XL	FR S-					

Description	Initial System	Repair System
Available Space (.1945)	/	/
System Type(s)	Gravel	Gravel
Site LTAR	.4	.4

Other Factors (.1946): _____
 Site Classification (.1948): P1
 Evaluated By: JW
 Others Present: JS

COMMENTS: _____

<u>LANDSCAPE POSITIONS</u>	<u>GROUP</u>	<u>TEXTURES</u>	<u>.1955 LTAR</u>	<u>CONSISTENCE MOIST</u>	<u>WET</u>
R-RIDGE	I	S-SAND	1.2 - 0.8	VFR-VERY FRIABLE	NS-NON-STICKY
S-SHOULDER SLOPE		LS-LOAMY SAND			
L-LINEAR SLOPE	II	SL-SANDY LOAM	0.8 - 0.6	FR-FRIABLE	SS-SLIGHTLY STICKY
FS-FOOT SLOPE		L-LOAM			
N-NOSE SLOPE	III	SI-SILT-	0.6 - 0.3	VFI-VERY FIRM	VS-VERY STICKY
H-HEAD SLOPE		SIL-SILT LOAM			
CC-CONCLAVE SLOPE		CL-CLAY LOAM			
CV-CONVEX SLOPE		SCL-SANDY CLAY LOAM			
T-TERRACE	IV	SIC-SILTY CLAY	0.4 - 0.1	EFI-EXTREMELY FIRM	NP-NON-PLASTIC
FP-FLOOD PLAN		C-CLAY			
		SC-SANDY CLAY			
<u>STRUCTURE</u>		<u>MINERALOGY</u>			
SG-SINGLE GRAIN		SLIGHTLY EXPANSIVE			
M-MASSIVE					
CR-CRUMB		EXPANSIVE			
GR-GRANULAR					
SBK-SUBANGULAR BLOCKY					
ABK-ANGULAR BLOCKY					
PL-PLATY					
PR-PRISMATIC					

Show profile locations and other site features (dimensions, reference or benchmark, and North).

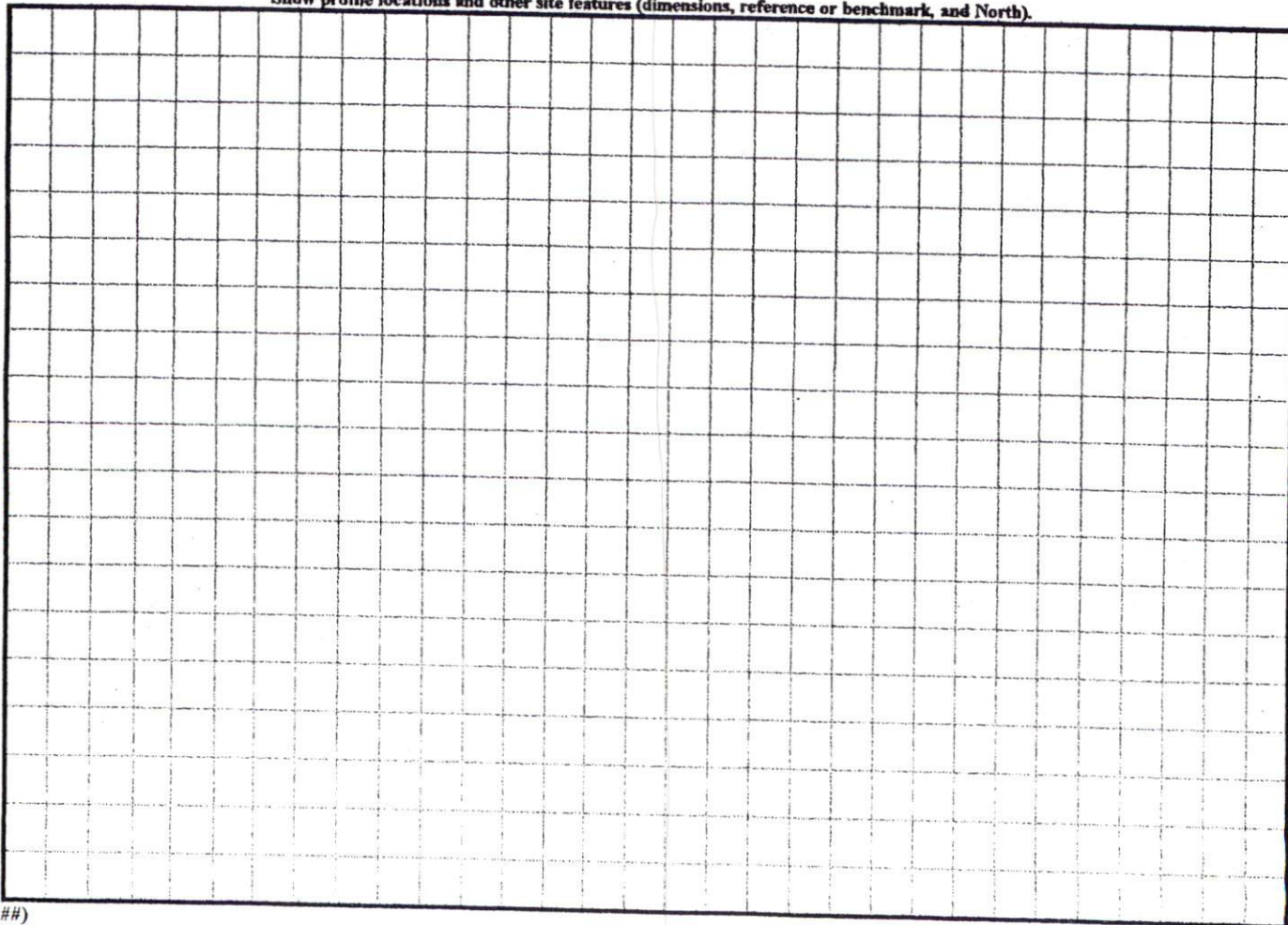

$$4 \overline{) 240} \\ \underline{24} \\ 0$$

$$3 \overline{) 600}$$

Pump
to GRAVEL

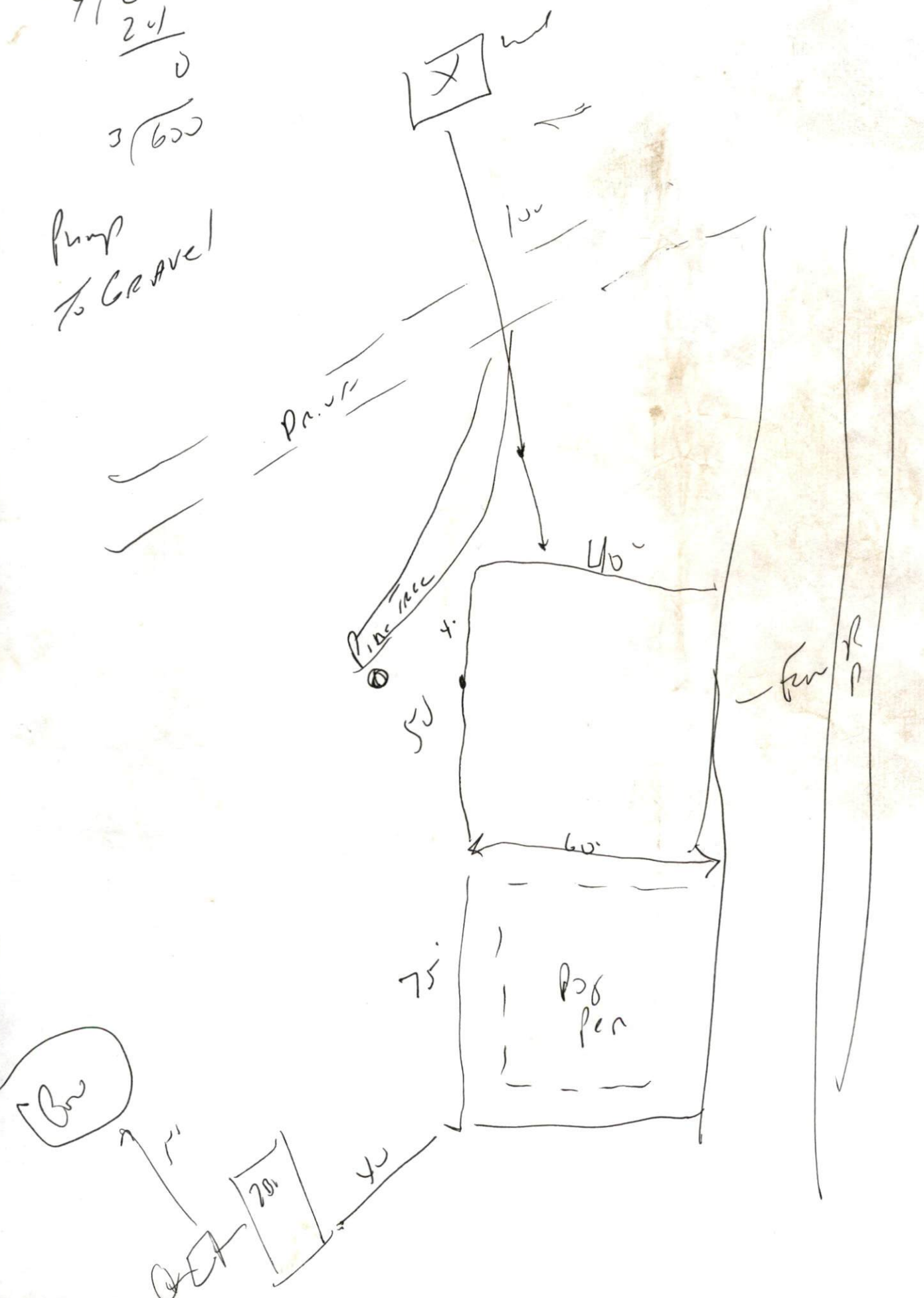

CAROLINA

STATE

REVIEW OFFICER OF HARNETT COUNTY
MAP OR PLAT TO WHICH THIS CERTIFICATION
IS ALL STATUTORY REQUIREMENTS FOR

03

Christine Leathe Wallace
REVIEW OFFICER

THE LOT(S) ON THIS PLAT HAVE BEEN
INSULANT. BASED ON THIS REVIEW,
THIS PLAT MEET APPROPRIATE REGUL
APPROVAL FOR EACH LOT REQUIRES ISS
HARNETT COUNTY HEALTH DEPARTMENT
AND SITING IN ACCORDANCE WITH REG
TIME OF PERMITTING. THIS CERTIFICAT
APPROVAL OR A PERMIT FOR ANY SITE V

03/31/03
DATE

[Signature]
ENVI

MINIMUM BUILDING SETBACKS
FRONT - 35'
SIDELINES - 10'
REAR - 25'

LOT 3
15.03 AC.

"POND"



D.B. 1072, PG. 808

DONALD
1929

NIP

900.00' 882.14' TOTAL
S 83°08'22"W

LOT 2
6.36 AC.

JURISDICTION
THE OWNER(S)
SHOWN HEREON
SUBDIVISION
MINIMUM
STREETS, ALLEYS
TO PUBLIC OR
SHOWN HEREON
JURISDICTION OF

701
NUMBER
[Signature]

975
S 55°

PE
D.B.