

HTE# 08 500-21336R

Harnett County Department of Public Health 23593

Improvement Permit

A building permit cannot be issued with only an Improvement Permit

ISSUED TO: CAVINESS LAND PROPERTY LOCATION: 1125
 SUBDIVISION FOREST OAKS LOT # 124
 NEW REPAIR EXPANSION
 Type of Structure: SFD-60x50-3BR Site Improvements required prior to Construction Authorization Issuance:
 Proposed Wastewater System Type: 25% Reduction system
 Projected Daily Flow: 360 GPD
 Number of bedrooms: 3 Number of Occupants: 6 max
 Basement Yes No
 Pump Required: Yes No May be required based on final location and elevations of facilities
 Type of Water Supply: Community Public Well Distance from well 100 feet Permit valid for: Five years
 Permit conditions: meet onsite for final layout- stub out plumbing shallow No expiration
At ground level or higher where shown. NOTE ALL UTILITIES MUST ENTER HOME ALONG
Right hand side (124/123 Property line)

Authorized State Agent: J. W. [Signature] Date: 02-09-09 SEE ATTACHED SITE SKETCH
 The issuance of this permit by the Health Department in no way guarantees the issuance of other permits. The permit holder is responsible for checking with appropriate governing bodies in meeting their requirements. This site is subject to revocation if the site plan, plat, or the intended use changes. The Improvement Permit shall not be affected by a change in ownership of the site. This permit is subject to compliance with the provisions of the Laws and Rules for Sewage Treatment and Disposal and to conditions of this permit.

Construction Authorization

(Required for Building Permit)

The construction and installation requirements of Rules .1950, .1952, .1954, .1955, .1956, .1957, .1958, and .1959 are incorporated by references into this permit and shall be met. Systems shall be installed in accordance with the attached system layout.

ISSUED TO: CAVINESS LAND PROPERTY LOCATION: 1125
 SUBDIVISION FOREST OAKS LOT # 124
 Facility Type: SFD-60x50-3BR New Expansion Repair
 Basement? Yes No Basement Fixtures? Yes No
 Type of Wastewater System** 25% Reduction system (Initial) Wastewater Flow: 360 GPD
 (See note below, if applicable) 25% Reduction sy. Repair (Repair)
At grade

Installation Requirements/Conditions

Septic Tank Size 1000 gallons Exact length of each trench 26' @ 90° each feet Trench Spacing: 9 Feet on Center
 Pump Tank Size _____ gallons Trenches shall be installed on contour at a Soil Cover: 6 inches
 Maximum Trench Depth of: 18 inches (Maximum soil cover shall not exceed 36" above the trench bottom)
 (Trench bottoms shall be level to +/-1/4" in all directions)
 Pump Requirements: _____ ft. TDH vs. _____ GPM Aggregate Depth: _____ inches below pipe
 Conditions: _____ inches above pipe
 _____ inches total

**If applicable: I understand the system type specified is different from the type specified on the application. I accept the specifications of this permit.

Owner/Legal Representative Signature: _____ Date: _____

This Construction Authorization is subject to revocation if the site plan, plat, or the intended use changes. The Construction Authorization shall not be transferred when there is a change in ownership of the site. This Construction Authorization is subject to compliance with the provisions of the Laws and Rules for Sewage Treatment and Disposal and to the conditions of this permit.

Authorized State Agent: J. W. [Signature] Date: 02-09-09 SEE ATTACHED SITE SKETCH
 Construction Authorization Expiration Date: 02-09-2014

HTE# 08500-~~21336~~ 21336R

Permit # 23593

Harnett County Department of Public Health Site Sketch

ISSUED TO: CAV West Land

PROPERTY LOCATOR: 1125

SUBDIVISION: FOREST OAKS

LOT # 124

Authorized State Agent: Jan [Signature]

Date: 02-29-09

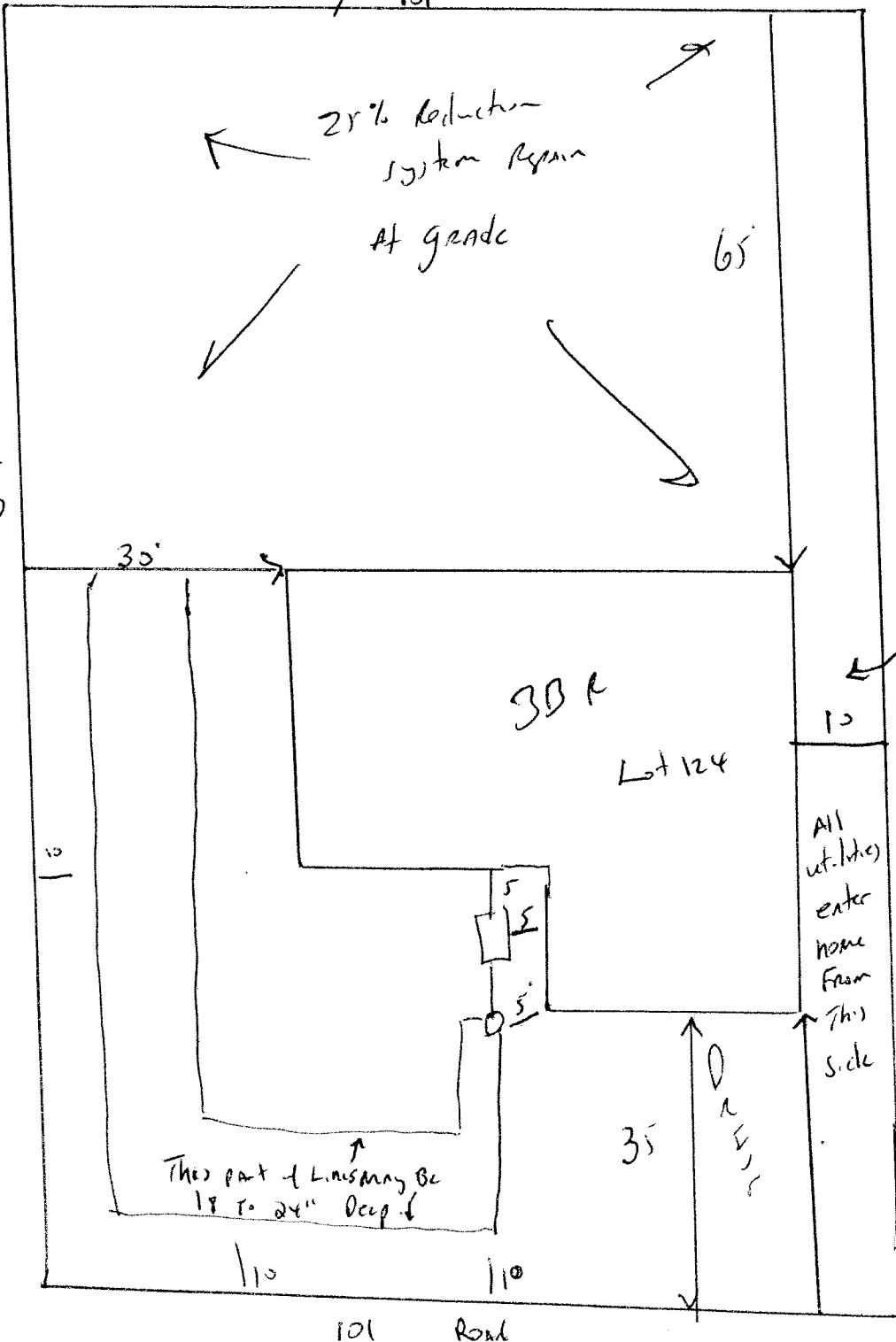

Meet onsite for Final Layout
 Maintain all setbacks
 STUB out Plumbing shallow - At ground level or higher where shown

Install 2 Lines 90' Each
 At 18" Deep. The 12' part of each line in front yard may be 18 to 24" Deep.

NOTE All utilities must enter home from lot 124/123 Property Line

All utilities enter home from this side

Lot 123

150'