

HTE# 08-500-21264

Harnett County Department of Public Health

25211

Improvement Permit

A building permit cannot be issued with only an Improvement Permit

ISSUED TO: Wester Const. PROPERTY LOCATION: 2138
 NEW REPAIR EXPANSION SUBDIVISION: Jamal Robertson LOT # 9
 Type of Structure: SFD-52x32-30n Site Improvements required prior to Construction Authorization Issuance:
 Proposed Wastewater System Type: 25% Reduction Sys
 Projected Daily Flow: 360 GPD
 Number of bedrooms: 3 Number of Occupants: 6 max
 Basement Yes No
 Pump Required: Yes No May be required based on final location and elevations of facilities
 Type of Water Supply: Community Public Well Distance from well 100 feet Permit valid for: Five years
 Permit conditions: Meet onsite for Final layout Maintain all setbacks No expiration
STUB out Plumbing shallow, At ground level or higher where shown

Authorized State Agent: [Signature] Date: 11-26-08 SEE ATTACHED SITE SKETCH
 The issuance of this permit by the Health Department in no way guarantees the issuance of other permits. The permit holder is responsible for checking with appropriate governing bodies in meeting their requirements. This site is subject to revocation if the site plan, plat, or the intended use changes. The Improvement Permit shall not be affected by a change in ownership of the site. This permit is subject to compliance with the provisions of the Laws and Rules for Sewage Treatment and Disposal and to conditions of this permit.

Construction Authorization

(Required for Building Permit)

The construction and installation requirements of Rules .1950, .1952, .1954, .1955, .1956, .1957, .1958, and .1959 are incorporated by references into this permit and shall be met. Systems shall be installed in accordance with the attached system layout.

ISSUED TO: Wester Const. PROPERTY LOCATION: 2138
 Facility Type: SFD-52x32-38a New Expansion Repair
 Basement? Yes No Basement Fixtures? Yes No
 Type of Wastewater System** 25% Reduction System (Initial) Wastewater Flow: 360 GPD
 (See note below, if applicable) 25% Reduction System (Repair)

Installation Requirements/Conditions
 Septic Tank Size 1000 gallons Number of trenches 1
 Pump Tank Size _____ gallons Exact length of each trench 300 feet Trench Spacing: 7 Feet on Center
 Trenches shall be installed on contour at a Soil Cover: 6 inches
 Maximum Trench Depth of: 18 inches (Maximum soil cover shall not exceed
 (Trench bottoms shall be level to +/-1/4" 36" above the trench bottom)
 in all directions)
 Pump Requirements: _____ ft. TDH vs. _____ GPM _____ inches below pipe
 Aggregate Depth: _____ inches above pipe
 Conditions: _____ inches total

**If applicable: I understand the system type specified is different from the type specified on the application. I accept the specifications of this permit.

Owner/Legal Representative Signature: _____ Date: _____

This Construction Authorization is subject to revocation if the site plan, plat, or the intended use changes. The Construction Authorization shall not be transferred when there is a change in ownership of the site. This Construction Authorization is subject to compliance with the provisions of the Laws and Rules for Sewage Treatment and Disposal and to the conditions of this permit. SEE ATTACHED SITE SKETCH

Authorized State Agent: [Signature] Date: 11-24-08
 Construction Authorization Expiration Date: 11-26-2013

HTE# 08-500-21264

Permit # 25211

Harnett County Department of Public Health Site Sketch

ISSUED TO: Water Cont.

PROPERTY LOCATOR: 2136

SUBDIVISION

Jane Robertson

LOT #

9

Authorized State Agent:

J. W. [Signature]

Date:

11-26-08

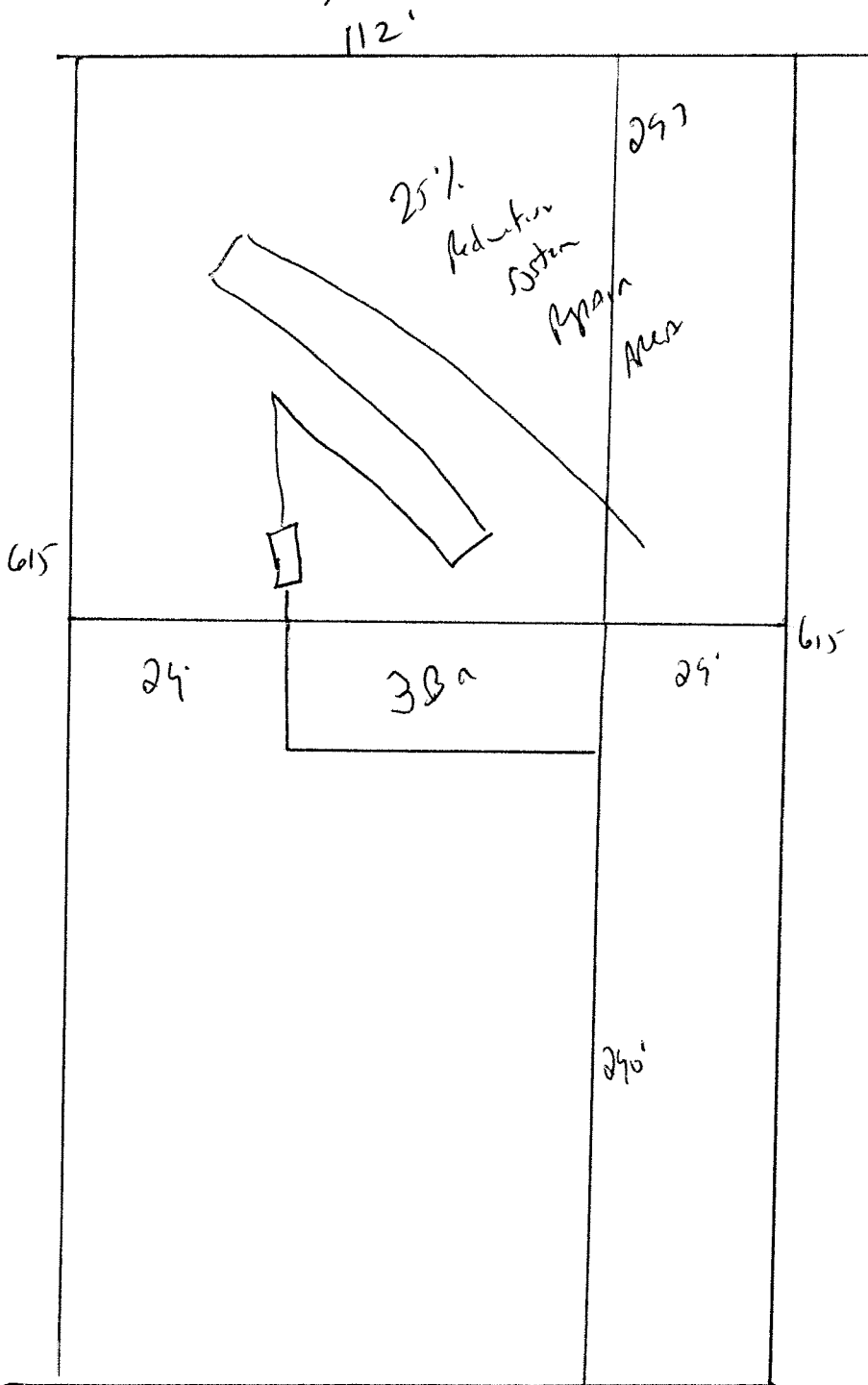

Meet onsite for Final Layout
 Maintain All Setbacks
 Stub Out Plumbing shallow
 At ground level or higher
 Where shown

Install 300' of 25% Reduction
 System at 18"

507124

112