

HTE# 08-5-21144

Hamilton County Department of Public Health

25050

Improvement Permit

A building permit cannot be issued with only an Improvement Permit

ISSUED TO: MICHAEL & PAMELA CAVNAR PROPERTY LOCATION: RAY RD SUBDIVISION _____ LOT # 1A

NEW REPAIR EXPANSION Type of Structure: SFD (76'x96') Site Improvements required prior to Construction Authorization Issuance: _____

Proposed Wastewater System Type: CONVENTIONAL

Projected Daily Flow: 480 GPD

Number of bedrooms: 4 Number of Occupants: 8 max

Basement Yes No

Pump Required: Yes No May be required based on final location and elevations of facilities

Type of Water Supply: Community Public Well Distance from well 100 feet Permit valid for: Five years No expiration

Permit conditions: _____

Authorized State Agent: [Signature] RS Date: 10/31/08 SEE ATTACHED SITE SKETCH

The issuance of this permit by the Health Department in no way guarantees the issuance of other permits. The permit holder is responsible for checking with appropriate governing bodies in meeting their requirements. This site is subject to revocation if the site plan, plat, or the intended use changes. The Improvement Permit shall not be affected by a change in ownership of the site. This permit is subject to compliance with the provisions of the Laws and Rules for Sewage Treatment and Disposal and to conditions of this permit.

Construction Authorization

(Required for Building Permit)

The construction and installation requirements of Rules .1950, .1952, .1954, .1955, .1956, .1957, .1958, and .1959 are incorporated by references into this permit and shall be met. Systems shall be installed in accordance with the attached system layout.

ISSUED TO: MICHAEL & PAMELA CAVNAR PROPERTY LOCATION: RAY RD SUBDIVISION _____ LOT # 1A

Facility Type: SFD (76'x96') New Expansion Repair

Basement? Yes No Basement Fixtures? Yes No

Type of Wastewater System** CONVENTIONAL (Initial) Wastewater Flow: 480 GPD

(See note below, if applicable) 25% REDUCTION SYSTEM (Repair)

Installation Requirements/Conditions	Number of trenches <u>4</u>	
Septic Tank Size <u>1000</u> gallons	Exact length of each trench <u>100</u> feet	Trench Spacing: <u>9</u> Feet on Center
Pump Tank Size _____ gallons	Trenches shall be installed on contour at a Maximum Trench Depth of: <u>30-18</u> inches (Trench bottoms shall be level to $\pm 1/4"$ in all directions)	Soil Cover: <u>18-6</u> inches (Maximum soil cover shall not exceed 36" above the trench bottom)
Pump Requirements: _____ ft. TDH vs. _____ GPM		Aggregate Depth: <u>6</u> inches below pipe <u>2</u> inches above pipe <u>12</u> inches total
Conditions: _____		

**If applicable: I understand the system type specified is different from the type specified on the application. I accept the specifications of this permit.

Owner/Legal Representative Signature: _____ Date: _____

This Construction Authorization is subject to revocation if the site plan, plat, or the intended use changes. The Construction Authorization shall not be transferred when there is a change in ownership of the site. This Construction Authorization is subject to compliance with the provisions of the Laws and Rules for Sewage Treatment and Disposal and to the conditions of this permit. SEE ATTACHED SITE SKETCH

Authorized State Agent: [Signature] RS Date: 10/31/08

Construction Authorization Expiration Date: 10/31/13

HTE# 08-5-21144

Permit # 25050

Harnett County Department of Public Health Site Sketch

ISSUED TO: MICHAEL & PAMELA CAYNA PROPERTY LOCATOR: RAY RD
SUBDIVISION _____ LOT # 1A

Authorized State Agent: ~~_____~~ RS (OLIVER TOLKSOFF) Date: 10/31/08

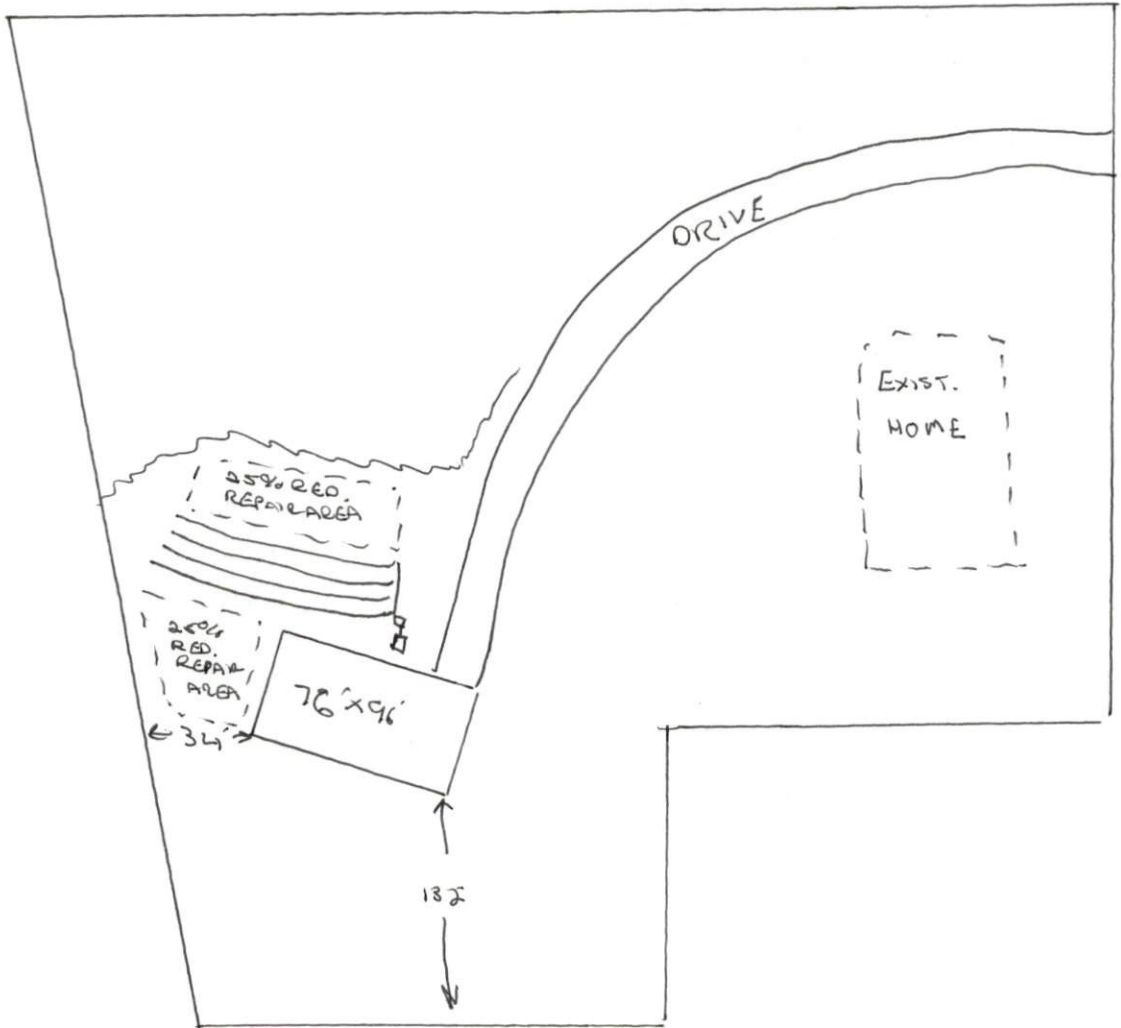

DRIVE