

HTE# 08-500 20877

Harnett County Department of Public Health

24998

Improvement Permit

A building permit cannot be issued with only an Improvement Permit

ISSUED TO: AQ Contracting PROPERTY LOCATION: 1139
NEW REPAIR EXPANSION SUBDIVISION Tingen Place LOT # 43

Type of Structure: SFO-47x50-3BR
Proposed Wastewater System Type: Pump to 25% Reduction Sys.
Projected Daily Flow: 360 GPD
Number of bedrooms: 3 Number of Occupants: 6 max

Basement Yes No
Pump Required: Yes No May be required based on final location and elevations of facilities
Type of Water Supply: Community Public Well Distance from well 100 feet Permit valid for: Five years
Permit conditions: Meet onsite for final layout maintain all set backs No expiration
STUB OUT Plumbing shallow, at ground level or higher where shown and if
18 to 24" ditch depth can be maintained then pump may not be required
Authorized State Agent: Jon White Date: 09-23-08 SEE ATTACHED SITE SKETCH

The issuance of this permit by the Health Department in no way guarantees the issuance of other permits. The permit holder is responsible for checking with appropriate governing bodies in meeting their requirements. This site is subject to revocation if the site plan, plat, or the intended use changes. The Improvement Permit shall not be affected by a change in ownership of the site. This permit is subject to compliance with the provisions of the Laws and Rules for Sewage Treatment and Disposal and to conditions of this permit.

Construction Authorization

(Required for Building Permit)

The construction and installation requirements of Rules .1950, .1952, .1954, .1955, .1956, .1957, .1958, and .1959 are incorporated by references into this permit and shall be met. Systems shall be installed in accordance with the attached system layout.

ISSUED TO: AQ Contracting PROPERTY LOCATION: 1139
SUBDIVISION Tingen Place LOT # 43

Facility Type: SFO-47x50-3BR New Expansion Repair
Basement? Yes No Basement Fixtures? Yes No
Type of Wastewater System** Pump to 25% Reduction system (Initial) Wastewater Flow: 360 GPD
(See note below, if applicable) Pump to 25% Reduction (Repair)

Installation Requirements/Conditions
Septic Tank Size 1000 gallons Number of trenches 1
Pump Tank Size 1000 gallons Exact length of each trench 180 feet Trench Spacing: 9 Feet on Center
Trenches shall be installed on contour at a Soil Cover: 6 inches
Maximum Trench Depth of: 18-24 inches (Maximum soil cover shall not exceed
(Trench bottoms shall be level to +/-1/4" 36" above the trench bottom)
in all directions)
Pump Requirements: _____ ft. TDH vs. _____ GPM _____ inches below pipe
Aggregate Depth: _____ inches above pipe
Conditions: _____ inches total

**If applicable: I understand the system type specified is different from the type specified on the application. I accept the specifications of this permit.

Owner/Legal Representative Signature: _____ Date: _____

This Construction Authorization is subject to revocation if the site plan, plat, or the intended use changes. The Construction Authorization shall not be transferred when there is a change in ownership of the site. This Construction Authorization is subject to compliance with the provisions of the Laws and Rules for Sewage Treatment and Disposal and to the conditions of this permit. SEE ATTACHED SITE SKETCH

Authorized State Agent: Jon White Date: 09-23-08
Construction Authorization Expiration Date: 09-23-2013

HTE# 08-500-20877

Permit # 24998

Harnett County Department of Public Health Site Sketch

ISSUED TO: AQ Contracting

PROPERTY LOCATOR: 1139

SUBDIVISION Tingen Place

LOT # 43

Authorized State Agent: [Signature]

Date: 09-23-08

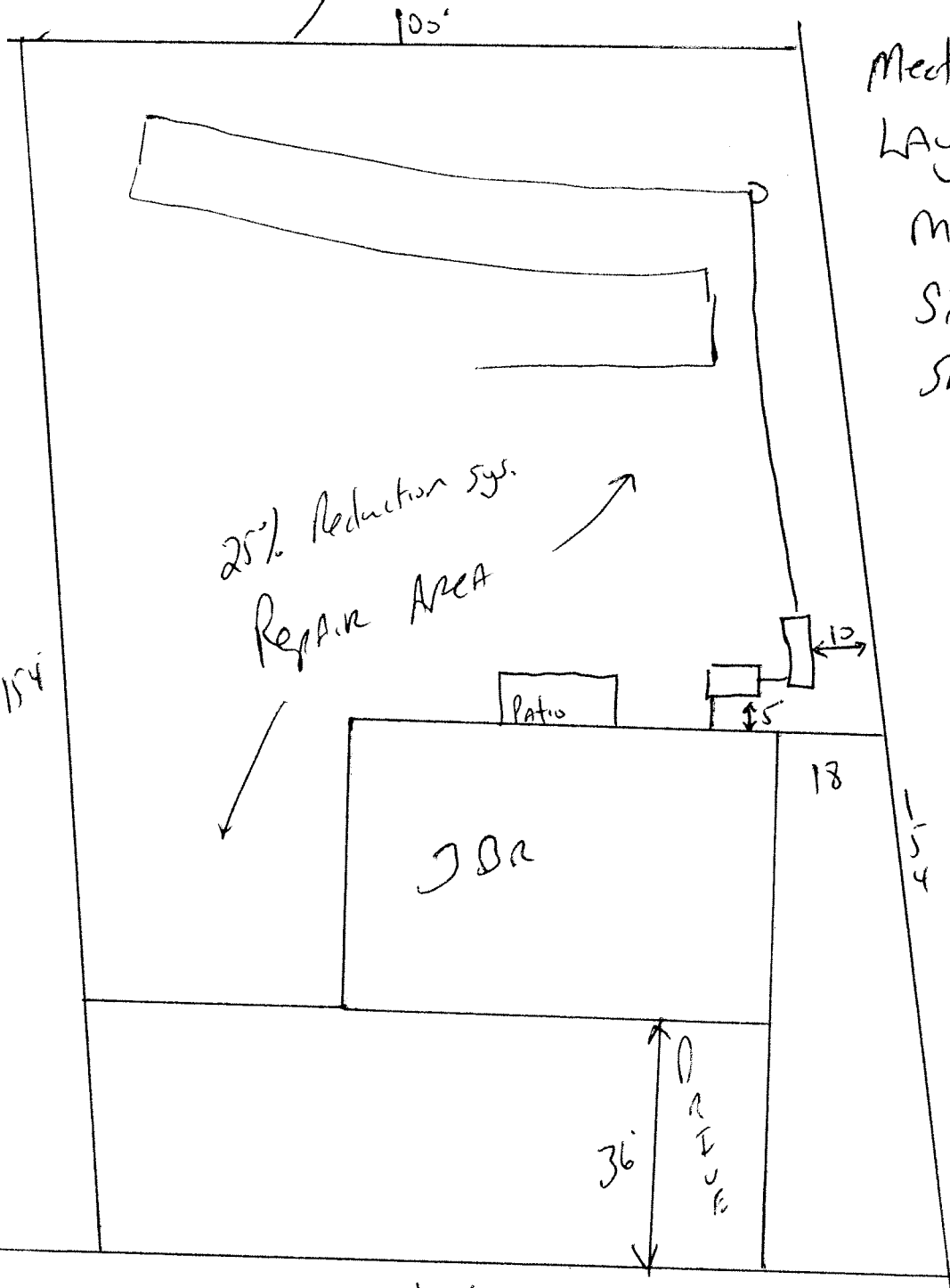

Meet onsite for final layout

MAINTAIN ALL set BACKS

STUB out Plumbing shallow, At ground level or higher where shown and if 18 to 24" Ditch Depths can be MAINTAINED

Pump MAY NOT be Required.

Install 180' of 25% Reduction system at 18 to 24" Deep.

100'
MIRRO COURT