

HTE# 08-500 20875

Harnett County Department of Public Health

24993

Improvement Permit

A building permit cannot be issued with only an Improvement Permit

ISSUED TO: AQ Contracting
PROPERTY LOCATION: 1139
SUBDIVISION: Tinsler Rd
LOT # 73
NEW [X] REPAIR [] EXPANSION []
Type of Structure: SFD-47x35-3BR
Proposed Wastewater System Type: Pump T-25% Reduction Sys.
Projected Daily Flow: 360 GPD
Number of bedrooms: 3 Number of Occupants: 6 max
Basement [] Yes [X] No

Pump Required: [X] Yes [] No [X] May be required based on final location and elevations of facilities
Type of Water Supply: [] Community [] Public [] Well Distance from well 100 feet
Permit valid for: [X] Five years [] No expiration
Permit conditions: Meet onsite for final layout MAINTAIN ALL SETBACKS
STUB out plumbing shallow AT GROUND level or higher where shown and
if 18 to 24" ditch depth can be maintained pump may not be required

Authorized State Agent: [Signature] Date: 09-18-08 SEE ATTACHED SITE SKETCH
The issuance of this permit by the Health Department in no way guarantees the issuance of other permits. The permit holder is responsible for checking with appropriate governing bodies in meeting their requirements. This site is subject to revocation if the site plan, plat, or the intended use changes. The Improvement Permit shall not be affected by a change in ownership of the site. This permit is subject to compliance with the provisions of the Laws and Rules for Sewage Treatment and Disposal and to conditions of this permit.

Construction Authorization

(Required for Building Permit)

The construction and installation requirements of Rules .1950, .1952, .1954, .1955, .1956, .1957, .1958, and .1959 are incorporated by references into this permit and shall be met. Systems shall be installed in accordance with the attached system layout.

ISSUED TO: AQ Contracting
PROPERTY LOCATION: 1139
SUBDIVISION: Tinsler Rd
LOT # 73
Facility Type: SFD-47x35-3BR [X] New [] Expansion [] Repair
Basement? [] Yes [X] No Basement Fixtures? [] Yes [X] No
Type of Wastewater System** Pump T-25% Reduction system (Initial) Wastewater Flow: 360 GPD
(See note below, if applicable [X]) 25% Reduction Sys. (Repair)

Installation Requirements/Conditions
Septic Tank Size 1000 gallons
Pump Tank Size 1000 gallons
Number of trenches 1
Exact length of each trench 180 feet
Trench Spacing: 9 Feet on Center
Soil Cover: 6 inches
Maximum Trench Depth of: 18.24 inches
(Trench bottoms shall be level to +/- 1/4" in all directions)
(Pump Requirements: _____ ft. TDH vs. _____ GPM)
Aggregate Depth: _____ inches below pipe
_____ inches above pipe
_____ inches total

**If applicable: I understand the system type specified is different from the type specified on the application. I accept the specifications of this permit.

Owner/Legal Representative Signature: _____ Date: _____

This Construction Authorization is subject to revocation if the site plan, plat, or the intended use changes. The Construction Authorization shall not be transferred when there is a change in ownership of the site. This Construction Authorization is subject to compliance with the provisions of the Laws and Rules for Sewage Treatment and Disposal and to the conditions of this permit. SEE ATTACHED SITE SKETCH

Authorized State Agent: [Signature] Date: 09-18-08
Construction Authorization Expiration Date: 09-18-2013

HTE# 08-500-20875

Permit # 24993

Harnett County Department of Public Health Site Sketch

ISSUED TO: AQ Contracting

PROPERTY LOCATOR: 1139

SUBDIVISION Tinsgen PLACE

LOT # 73

Authorized State Agent: J. L. [Signature]

Date: 09-18-08

SK1139
Tinsgen Rd
59'

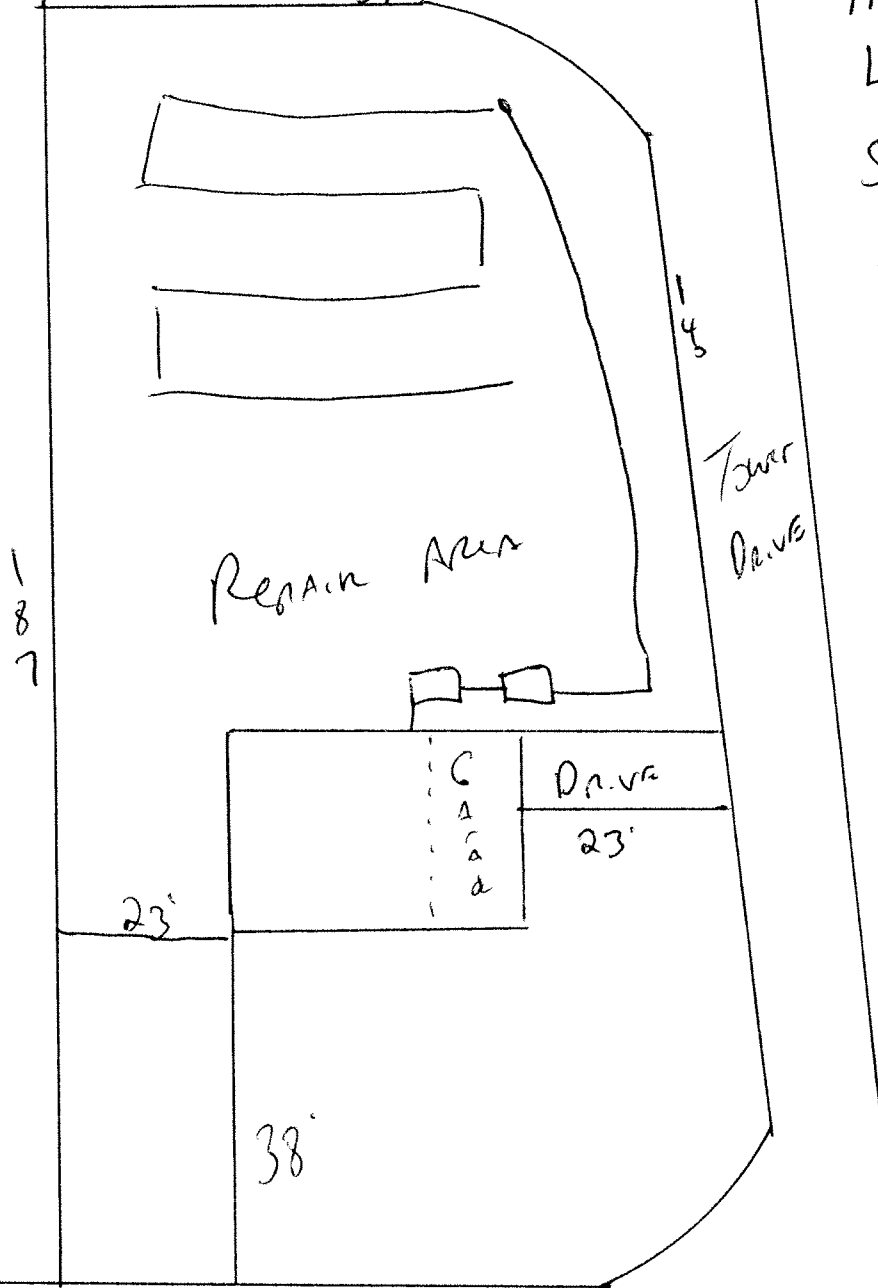

Meet onsite for Final
 Layout maintain All set Backs
 Stub out Plumbing shallow
 At ground level or higher where
 shown & if 18 to 24" ditch
 Depth can be maintained
 Then pump may not be
 Required.

Install 180' of 25% Reduction
 System at 18 to 24" Deep.

Sandy Tinsgen
 C.T.