

HTE# 08500-20817

Harnett County Department of Public Health

25054

Improvement Permit

A building permit cannot be issued with only an Improvement Permit

ISSUED TO: Cumberland Homes
NEW [X] REPAIR [] EXPANSION []
PROPERTY LOCATION: 1210
SUBDIVISION: Persimmon Hill LOT # 63
Type of Structure: SFD-54x51-4BR
Proposed Wastewater System Type: 25% Reduction Sys.
Projected Daily Flow: 480 GPD
Number of bedrooms: 4 Number of Occupants: 8 max
Basement [] Yes [X] No
Pump Required: [X] Yes [] No [] May be required based on final location and elevations of facilities
Type of Water Supply: [] Community [X] Public [] Well Distance from well 100 feet
Permit conditions: Meet on site - maintain all set back Permit valid for: [X] Five years [] No expiration

Authorized State Agent: J. L. Wain Date: 09-12-08 SEE ATTACHED SITE SKETCH

The issuance of this permit by the Health Department in no way guarantees the issuance of other permits. The permit holder is responsible for checking with appropriate governing bodies in meeting their requirements. This site is subject to revocation if the site plan, plat, or the intended use changes. The Improvement Permit shall not be affected by a change in ownership of the site. This permit is subject to compliance with the provisions of the Laws and Rules for Sewage Treatment and Disposal and to conditions of this permit.

Construction Authorization

(Required for Building Permit)

The construction and installation requirements of Rules .1950, .1952, .1954, .1955, .1956, .1957, .1958, and .1959 are incorporated by references into this permit and shall be met. Systems shall be installed in accordance with the attached system layout.

ISSUED TO: Cumberland Homes
PROPERTY LOCATION: 1210
SUBDIVISION: Persimmon Hill LOT # 63
Facility Type: SFD-54x51-4BR [X] New [] Expansion [] Repair []
Basement? [] Yes [X] No Basement Fixtures? [] Yes [X] No
Type of Wastewater System: Pump to 25% Reduction system (Initial) Wastewater Flow: 480 GPD
(See note below, if applicable) [X] 25% Reduction Sys. (Repair)

Installation Requirements/Conditions
Septic Tank Size 1000 gallons
Pump Tank Size 1000 gallons
Number of trenches 1
Exact length of each trench 350 feet
Trench Spacing: 9 Feet on Center
Soil Cover: 6 inches
Maximum Trench Depth of: inches
(Trench bottoms shall be level to +/- 1/4" in all directions)
(Pump Requirements: ft. TDH vs. GPM)
Aggregate Depth: inches below pipe, inches above pipe, inches total

**If applicable: I understand the system type specified is different from the type specified on the application. I accept the specifications of this permit.

Owner/Legal Representative Signature: Date:

This Construction Authorization is subject to revocation if the site plan, plat, or the intended use changes. The Construction Authorization shall not be transferred when there is a change in ownership of the site. This Construction Authorization is subject to compliance with the provisions of the Laws and Rules for Sewage Treatment and Disposal and to the conditions of this permit. SEE ATTACHED SITE SKETCH

Authorized State Agent: J. L. Wain Date: 09-12-08 Construction Authorization Expiration Date: 9-12-2013

HTE# 08-000-22817

Permit # 25054

Harnett County Department of Public Health Site Sketch

ISSUED TO: Cumberland Home

PROPERTY LOCATOR: 1210

SUBDIVISION Persimmon Hill

LOT # 63

Authorized State Agent: J. Loh

Date: 09-12-08

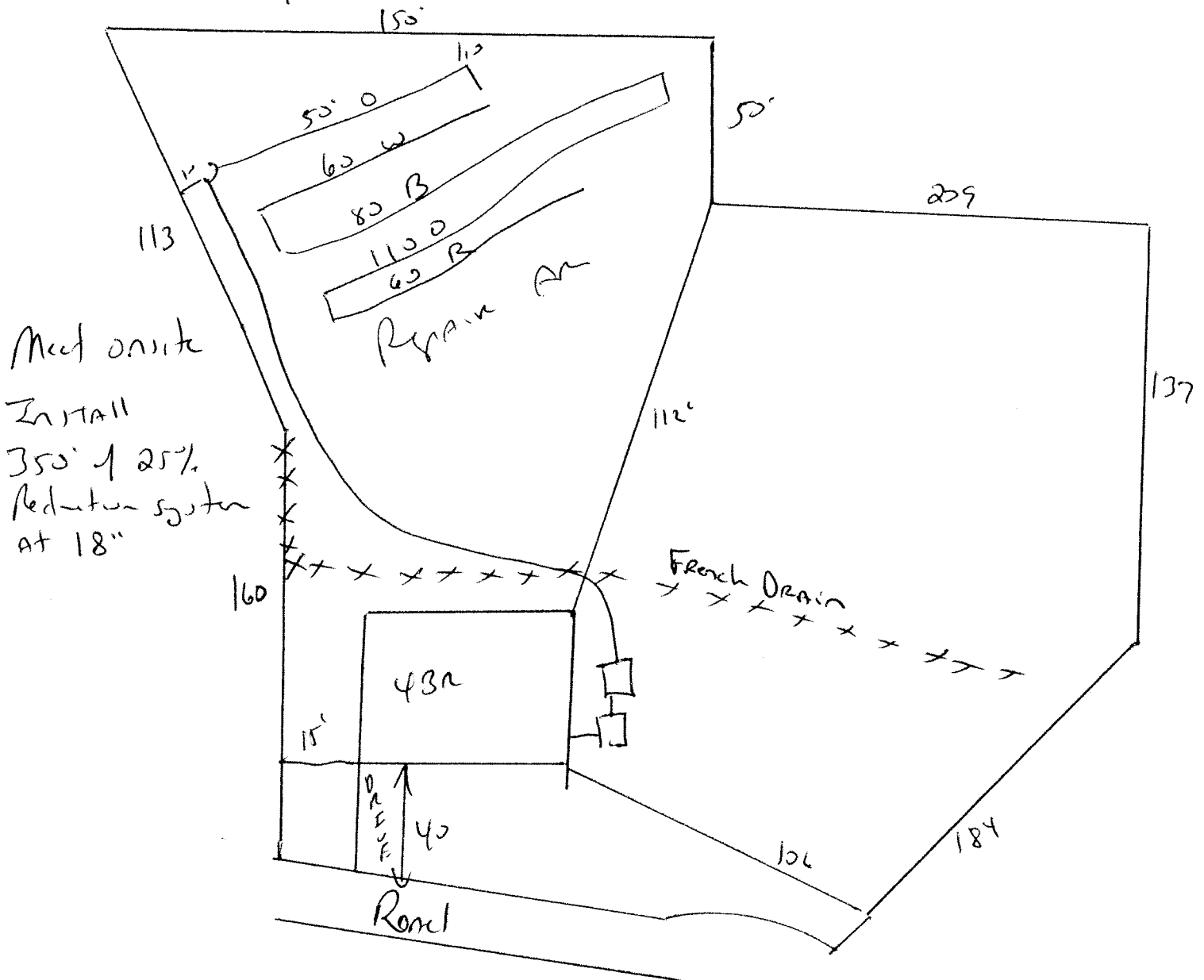

Meet onsite

Maintain all Setbacks