

Improvement Permit

A building permit cannot be issued with only an Improvement Permit

ISSUED TO: James Jackson PROPERTY LOCATION: 1139
NEW REPAIR EXPANSION SUBDIVISION: TINGEN PLACE LOT # 71
Type of Structure: SFD-~~31x32~~-3BR @ 28x28
Proposed Wastewater System Type: Pump to 25% Red. Syst
Projected Daily Flow: 360 GPD
Number of bedrooms: 3 Number of Occupants: 6 max
Basement Yes No

Site Improvements required prior to Construction Authorization Issuance:

Pump Required: Yes No May be required based on final location and elevations of facilities
Type of Water Supply: Community Public Well Distance from well 100 feet Permit valid for: Five years
Permit conditions: Meet on site for final layout maintain all set back No expiration
Stub out plumbing shallow at ground level or higher where shown and if 18 to 24" pipe depth can be maintained then pump may not be needed
Authorized State Agent: Joe Lars Date: 09-09-08 03-06-09 SEE ATTACHED SITE SKETCH

The issuance of this permit by the Health Department in no way guarantees the issuance of other permits. The permit holder is responsible for checking with appropriate governing bodies in meeting their requirements. This site is subject to revocation if the site plan, plat, or the intended use changes. The Improvement Permit shall not be affected by a change in ownership of the site. This permit is subject to compliance with the provisions of the Laws and Rules for Sewage Treatment and Disposal and to conditions of this permit.

Construction Authorization

(Required for Building Permit)

The construction and installation requirements of Rules .1950, .1952, .1954, .1955, .1956, .1957, .1958, and .1959 are incorporated by references into this permit and shall be met. Systems shall be installed in accordance with the attached system layout.

ISSUED TO: JAMES JACKSON PROPERTY LOCATION: 1139
Facility Type: SFD-^{28x28}~~31x32~~-3BR New Expansion Repair
Basement? Yes No Basement Fixtures? Yes No
Type of Wastewater System** pump to 25% Reduction system (Initial) Wastewater Flow: _____ GPD
(See note below, if applicable) pump to 25% Reduction system (Repair)

Installation Requirements/Conditions
Septic Tank Size 1000 gallons Number of trenches 1
Pump Tank Size 1000 gallons Exact length of each trench 180 feet Trench Spacing: 9 Feet on Center
If Needed Trenches shall be installed on contour at a Soil Cover: 6 inches
Maximum Trench Depth of: 18.24 inches (Maximum soil cover shall not exceed 36" above the trench bottom)
in all directions
Pump Requirements: _____ ft. TDH vs. _____ GPM _____ inches below pipe
Aggregate Depth: _____ inches above pipe
Conditions: Revised to 28x28 3BR Home on 03-06-09 JHL _____ inches total

**If applicable: I understand the system type specified is different from the type specified on the application. I accept the specifications of this permit.

Owner/Legal Representative Signature: _____ Date: _____

This Construction Authorization is subject to revocation if the site plan, plat, or the intended use changes. The Construction Authorization shall not be transferred when there is a change in ownership of the site. This Construction Authorization is subject to compliance with the provisions of the Laws and Rules for Sewage Treatment and Disposal and to the conditions of this permit. SEE ATTACHED SITE SKETCH

Authorized State Agent: Joe Lars Date: 09-09-08 03-06-09
Construction Authorization Expiration Date: 09-09-2013 03-06-2014

HTE# 08-500-20811 R

Permit # 24983

Harnett County Department of Public Health Site Sketch

ISSUED TO: James Jackson PROPERTY LOCATOR: 1139
SUBDIVISION: TWIGGEN PLACE LOT # 71

Authorized State Agent: J. L. ANI Date: 09-09-08
90 SR 1139 Revised 03-06-9

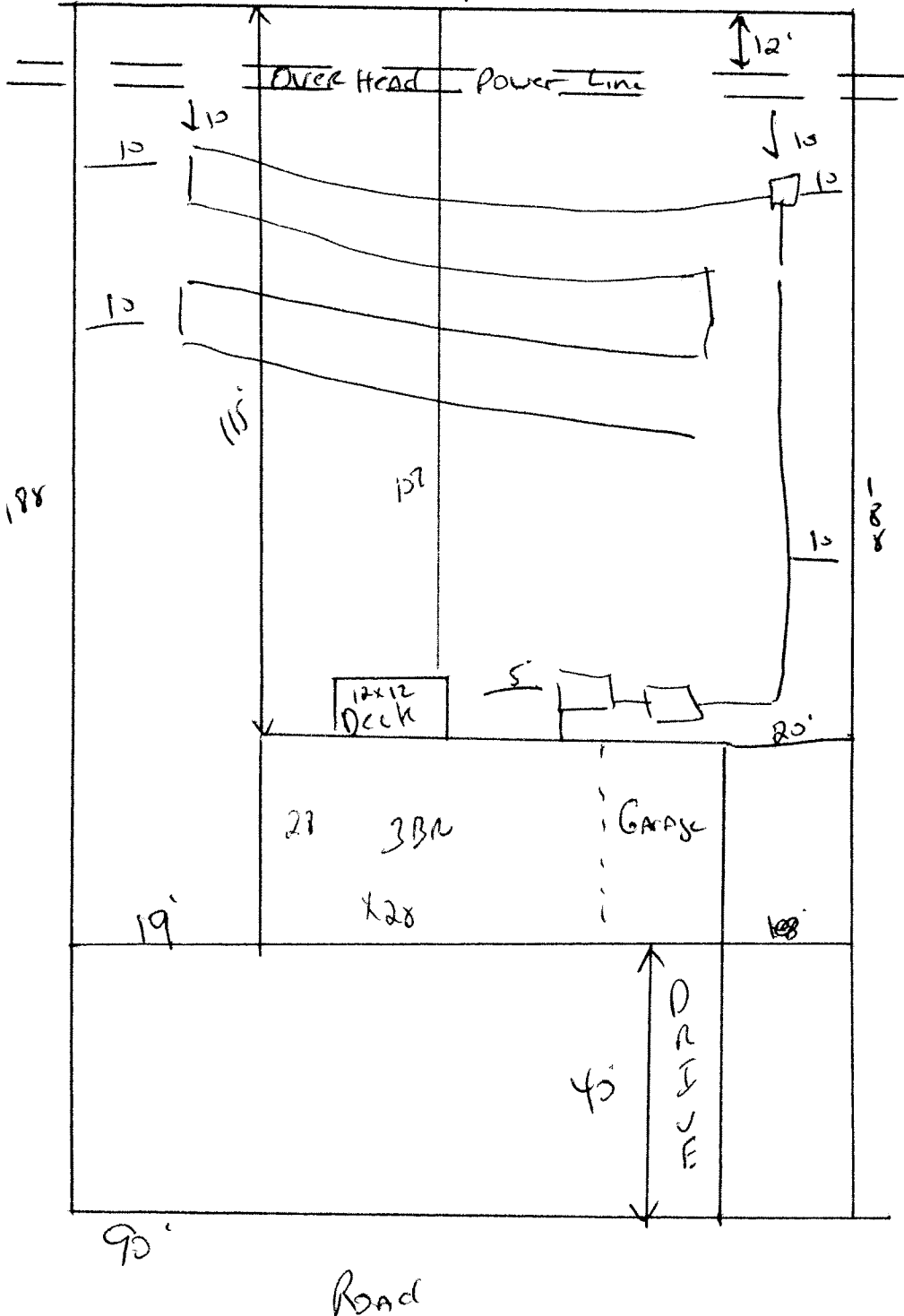

Meet onsite for
Final layout
maintain all
set Backs

STUB out Plumbing
Shallow At ground
Level or higher
Where shown And
if 18 to 24" Ditch
Depth CAN be
maintain pump
MAY ~~not~~ not
be needed

INSTALL 180' of
25% Reduction system
At 18 to 24" Deep.