

Improvement Permit

A building permit cannot be issued with only an Improvement Permit

ISSUED TO: Wynn Const. PROPERTY LOCATION: NC 27 SUBDIVISION: Tingen Pointe LOT # 82
Type of Structure: SFD-42x42 3BRmax
Proposed Wastewater System Type: Pump to 25% Reduction system
Projected Daily Flow: 360 max GPD
Number of bedrooms: 3 max Number of Occupants: max
Basement: No
Pump Required: Yes
Type of Water Supply: Public
Permit conditions: Meet onsite for Final layout - keep utilities in area shown...

Authorized State Agent: J. WARETS Date: 3-22-2010 SEE ATTACHED SITE SKETCH
The issuance of this permit by the Health Department in no way guarantees the issuance of other permits. The permit holder is responsible for checking with appropriate governing bodies in meeting their requirements. This site is subject to revocation if the site plan, plat, or the intended use changes. The Improvement Permit shall not be affected by a change in ownership of the site. This permit is subject to compliance with the provisions of the Laws and Rules for Sewage Treatment and Disposal and to conditions of this permit.

Construction Authorization

(Required for Building Permit)

The construction and installation requirements of Rules .1950, .1952, .1954, .1955, .1956, .1957, .1958, and .1959 are incorporated by references into this permit and shall be met. Systems shall be installed in accordance with the attached system layout.

ISSUED TO: Wynn Const. PROPERTY LOCATION: NC 27 SUBDIVISION: Tingen Pointe LOT # 82
Facility Type: SFD-42x42 3BRmax New
Basement: No
Type of Wastewater System: Pump to 25% Reduction system (Initial) Wastewater Flow: 360 max GPD
(See note below, if applicable) Pump to 25% Reduction sys (Repair)

Installation Requirements/Conditions
Septic Tank Size: 1000 gallons
Pump Tank Size: 1000 gallons
Number of trenches: 1
Exact length of each trench: 300 feet
Trench Spacing: 9 Feet on Center
Soil Cover: 6 inches
Maximum Trench Depth: 18 inches
(Pump Requirements: ft. TDH vs. GPM)
Aggregate Depth: inches below pipe, inches above pipe, inches total

**If applicable: I understand the system type specified is different from the type specified on the application. I accept the specifications of this permit.

Owner/Legal Representative Signature: Date:

This Construction Authorization is subject to revocation if the site plan, plat, or the intended use changes. The Construction Authorization shall not be transferred when there is a change in ownership of the site. This Construction Authorization is subject to compliance with the provisions of the Laws and Rules for Sewage Treatment and Disposal and to the conditions of this permit. SEE ATTACHED SITE SKETCH

Authorized State Agent: J. WARETS Date: 03-22-2010
Construction Authorization Expiration Date: 03-22-2015

HTE# 08-500-20786R

Permit # 25520

Harnett County Department of Public Health Site Sketch

ISSUED TO: Wynn cont.

PROPERTY LOCATOR: NC 27

SUBDIVISION Tingan Pointe

LOT # 82

Authorized State Agent: Jr W & REHS

Date: 3-22-2010

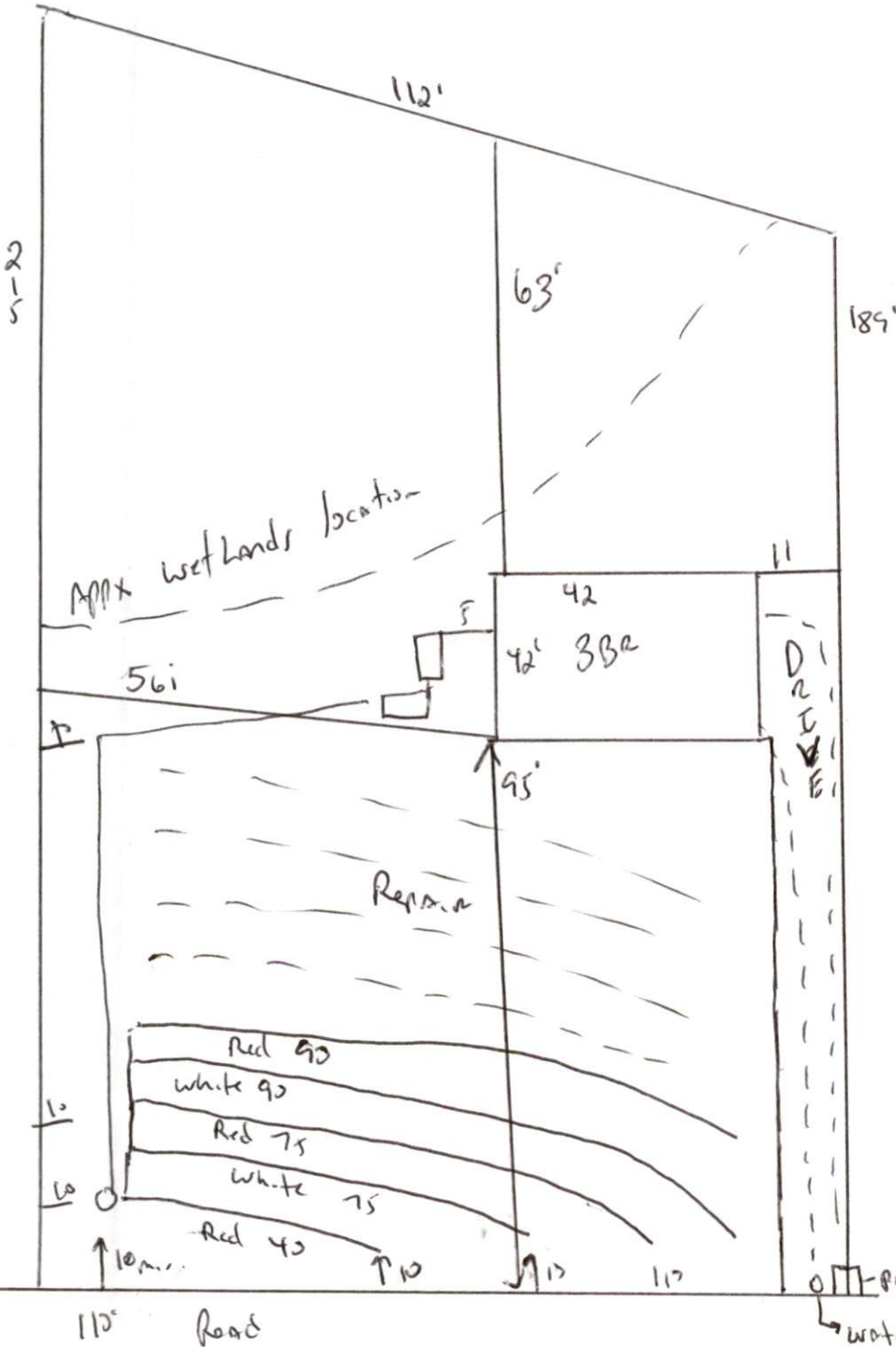

Meet onsite
 For Final Layout
 Maintain all setbacks
 Install 300' of 21%
 Reduction system at
 18" Deep.
 Keep Tanks out of
 wetlands Area 95'
 From any surface water
 Place utilities along
 Property Line with drive.
 Keep utilities 10' from
 Any part of septic system