

PERMIT # 24996

Operation Permit

New Installation Septic Tank Repair Nitrification Line Expansion

Name: (owner) Lynn Contri PROPERTY LOCATION: Ne 27
 System Installer: Randy Batten SUBDIVISION Tingen Point LOT # 83
 Registration # _____

Basement with plumbing: Garage Number of Bedrooms 3
 Type of Water Supply: Community Public Well Distance from well 100 feet
 System Type: Pumps Quick 4 IIIb Types V and VI Systems expire in 5 years.
 (In accordance with Table V a) Owner must contact Health Department 6 months prior to expiration for permit renewal.

This system has been installed in compliance with applicable North Carolina General Statutes, Rules for Sewage Treatment and Disposal, and all conditions of the Improvement Permit and Construction Authorization.

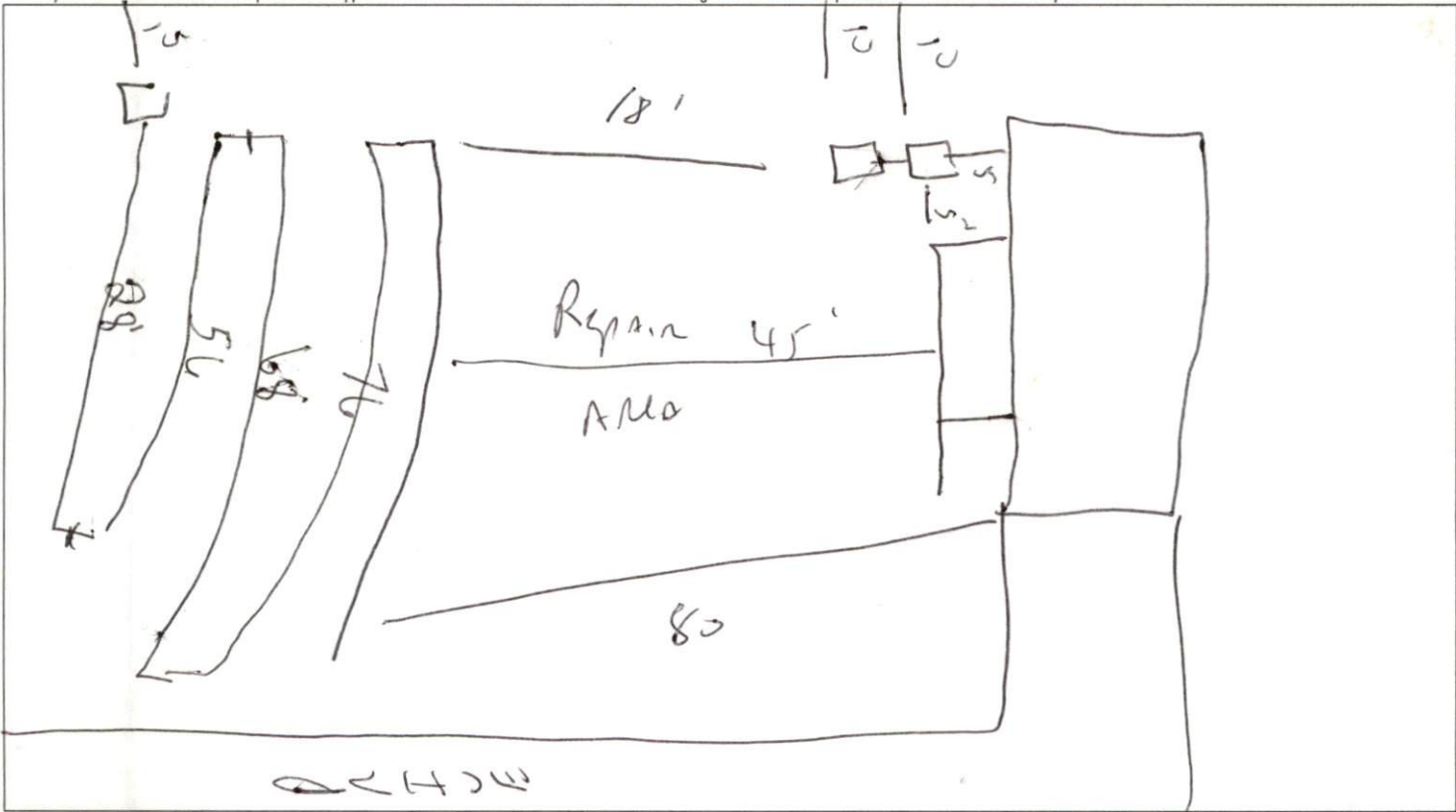

PERMIT CONDITIONS:

- I. Performance: System shall perform in accordance with Rule .1961.
- II. Monitoring: As required by Rule .1961.
- III. Maintenance: As required by Rule .1961. Other: _____
 Subsurface system operator required? Yes No
 If yes, see attached sheet for additional operation conditions, maintenance and reporting.
- IV. Operation: _____
- V. Other: _____

Following are the specifications for the sewage disposal system on the above captioned property.

Type of system: Conventional Other Pumps Quick 4 Septic Tank: 1000 gallons Pump Tank: 1000 gallons
 Subsurface Drainage Field: No. of ditches _____ exact length of each ditch 300 feet width of ditches 3 feet depth of ditches 18 inches
 French Drain Required: _____ linear feet

Authorized State Agent [Signature] REHS Date 11/13/09