

HTE# 08500-20784

# Harnett County Department of Public Health

24982

## Improvement Permit

A building permit cannot be issued with only an Improvement Permit

ISSUED TO: Wynn Const. PROPERTY LOCATION: DC 27  
 NEW  REPAIR  EXPANSION  SUBDIVISION: TINSEN Pointe LOT # 59  
 Type of Structure: SFD-49x50-3BR Site Improvements required prior to Construction Authorization Issuance:  
 Proposed Wastewater System Type: 25% Reduction Sys.  
 Projected Daily Flow: 360 GPD  
 Number of bedrooms: 3 Number of Occupants: 6 max  
 Basement  Yes  No  
 Pump Required:  Yes  No  May be required based on final location and elevations of facilities  
 Type of Water Supply:  Community  Public  Well Distance from well 100 feet Permit valid for:  Five years  
 Permit conditions: Meet onsite for Final layout - MAINTAIN ALL SETBACKS  No expiration  
STUB OUT PLUMBING SHALLOW AT GROUND LEVEL OR HIGHER WHERE SHOWN

Authorized State Agent: J. LAM Date: 09-03-08 SEE ATTACHED SITE SKETCH  
 The issuance of this permit by the Health Department in no way guarantees the issuance of other permits. The permit holder is responsible for checking with appropriate governing bodies in meeting their requirements. This site is subject to revocation if the site plan, plat, or the intended use changes. The Improvement Permit shall not be affected by a change in ownership of the site. This permit is subject to compliance with the provisions of the Laws and Rules for Sewage Treatment and Disposal and to conditions of this permit.

## Construction Authorization

(Required for Building Permit)

The construction and installation requirements of Rules .1950, .1952, .1954, .1955, .1956, .1957, .1958, and .1959 are incorporated by references into this permit and shall be met. Systems shall be installed in accordance with the attached system layout.

ISSUED TO: Wynn Const. PROPERTY LOCATION: DC 27  
 Facility Type: SFD-49x50-3BR  New  Expansion  Repair SUBDIVISION: TINSEN Pointe LOT # 59  
 Basement?  Yes  No Basement Fixtures?  Yes  No  
 Type of Wastewater System\*\* 25% Reduction System (Initial) Wastewater Flow: 360 GPD  
 (See note below, if applicable )

(Repair)

<b>Installation Requirements/Conditions</b>	Number of trenches <u>1</u>	
Septic Tank Size <u>1000</u> gallons	Exact length of each trench <u>230</u> feet	Trench Spacing: <u>9</u> Feet on Center
Pump Tank Size _____ gallons	Trenches shall be installed on contour at a	Soil Cover: <u>6</u> inches
	Maximum Trench Depth of: <u>18.24</u> inches	(Maximum soil cover shall not exceed
	(Trench bottoms shall be level to +/- 1/4"	36" above the trench bottom)
	in all directions)	
Pump Requirements: _____ ft. TDH vs. _____ GPM		Aggregate Depth: _____ inches below pipe
Conditions: _____		Aggregate Depth: _____ inches above pipe
		Aggregate Depth: _____ inches total

\*\*If applicable: I understand the system type specified is different from the type specified on the application. I accept the specifications of this permit.

Owner/Legal Representative Signature: \_\_\_\_\_ Date: \_\_\_\_\_

This Construction Authorization is subject to revocation if the site plan, plat, or the intended use changes. The Construction Authorization shall not be transferred when there is a change in ownership of the site. This Construction Authorization is subject to compliance with the provisions of the Laws and Rules for Sewage Treatment and Disposal and to the conditions of this permit. SEE ATTACHED SITE SKETCH

Authorized State Agent: J. LAM Date: 09-03-08  
 Construction Authorization Expiration Date: 09-07-2017

HTE# 08.500-20784

Permit # 24982

# Harnett County Department of Public Health Site Sketch

ISSUED TO: Wynn Const. PROPERTY LOCATOR: NC27  
SUBDIVISION: Tinsler Pointe LOT # 59

Authorized State Agent: [Signature] Date: 09.07.01

101

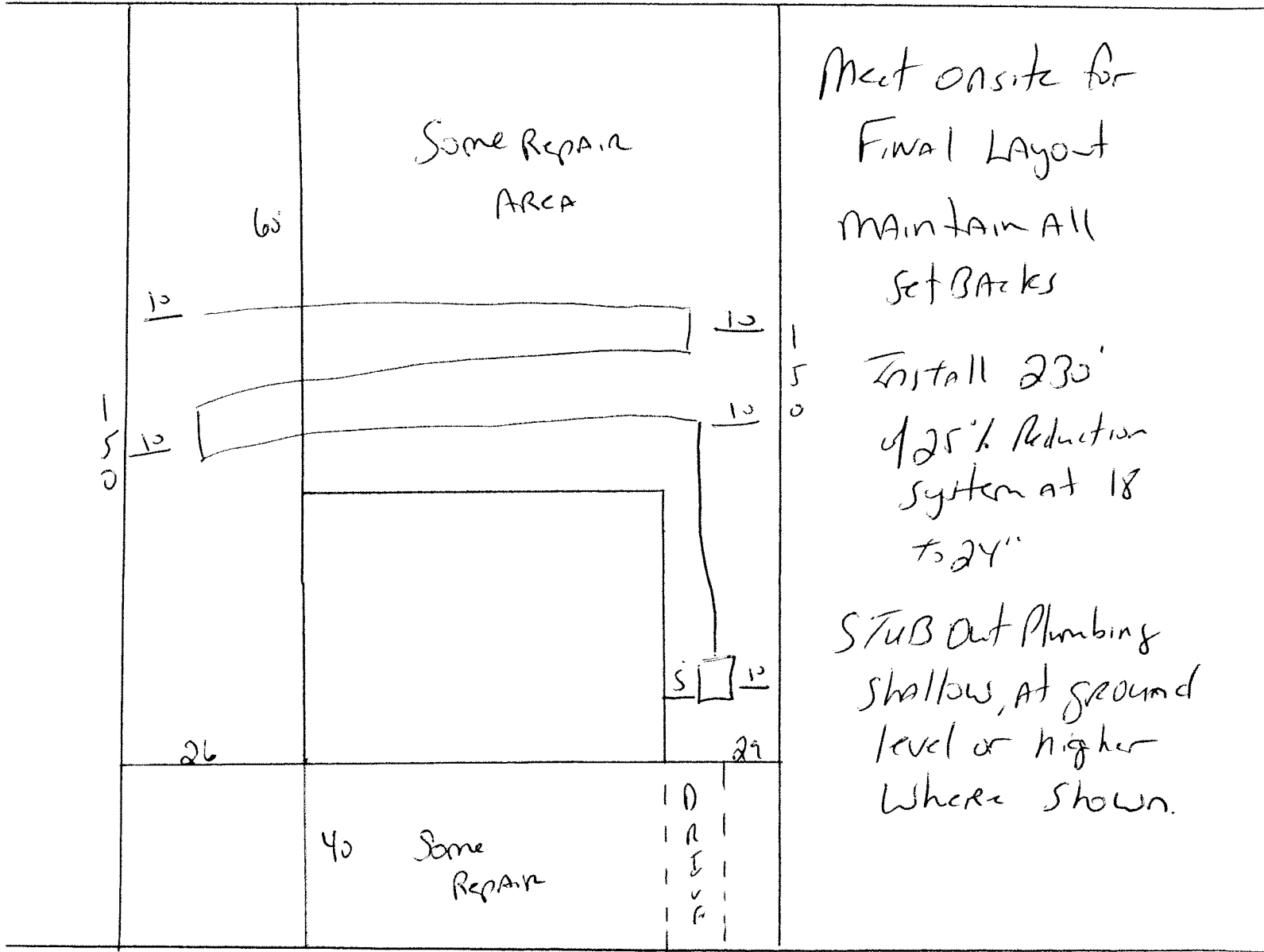

Meet onsite for  
Final Layout  
maintain all  
setbacks  
Install 230'  
of 25% Reduction  
system at 18  
to 24"  
STUB out Plumbing  
shallow, at ground  
level or higher  
where shown.

101  
Road