

**SOIL/SITE EVALUATION  
for ON-SITE WASTEWATER SYSTEM**

Owner: 08-500-20777

Applicant:

Address:

Date Evaluated:

Proposed Facility: SFD

Design Flow (.1949): 2.6

Property Size:

Location of Site: A127

Property Recorded:

Water Supply:  Public  Individual  Well  Spring  Other

Evaluation Method:  Auger Boring  Pit  Cut

Type of Wastewater:  Sewage  Industrial Process  Mixed

P R O F I L E #	.1940 Landscape Position/ Slope%	Horizon Depth (IN.)	SOIL MORPHOLOGY .1941		OTHER PROFILE FACTORS				Profile Class & LTAR
			.1941 Structure/ Texture	.1941 Consistence Mineralogy	.1942 Soil Wetness/ Color	.1943 Soil Depth (IN.)	.1956 Sapro Class	.1944 Restr Horiz	
3/2 )		12-20	GR SL	VFR SF					.5
		20-36	SM SCL	FR SF					
		0-12	GR SL	VFR SF					
		18-30	SM SCL	FR SF					.4
		30-30	SM SC	FI SF					
		11-30	GR SL	VFR SF					.5
		30-38	SM SCL	FR SC					
		0-21	GR SL	VFR SF					.5
		2-130	SM SCL	FR SF					
		0-18	GR SL	VFR SF					.4
		18-30	SM SCL	FR SF					
		30-36	SM SC	FI SF					

Description	Initial System	Repair System
Available Space (.1945)	—	—
System Type(s)	25%	25%
Site LTAR	.4	.4

Other Factors (.1946): \_\_\_\_\_  
 Site Classification (.1948): P1  
 Evaluated By: QV  
 Others Present: ME  
 TC

COMMENTS: \_\_\_\_\_  
 \_\_\_\_\_  
 \_\_\_\_\_

<u>LANDSCAPE POSITIONS</u>	<u>GROUP</u>	<u>TEXTURES</u>	<u>.1955 LTAR</u>	<u>CONSISTENCE MOIST</u>	<u>WET</u>
R-RIDGE	I	S-SAND	1.2 - 0.8	VFR-VERY FRIABLE FR-FRIABLE	NS-NON-STICKY SS-SLIGHTLY STICKY
S-SHOULDER SLOPE		LS-LOAMY SAND			
L-LINEAR SLOPE	II	SL-SANDY LOAM	0.8 - 0.6	FI-FIRM VFI-VERY FIRM	S-STICKY VS-VERY STICKY
FS-FOOT SLOPE		L-LOAM			
N-NOSE SLOPE	III	SI-SILT-	0.6 - 0.3	EFI-EXTREMELY FIRM	NP-NON-PLASTIC SP-SLIGHTLY STICKY
H-HEAD SLOPE		SIL-SILT LOAM			
CC-CONCLAVE SLOPE		CL-CLAY LOAM			
CV-CONVEX SLOPE		SCL-SANDY CLAY LOAM			
T-TERRACE		SICL-SILTY CLAY LOAM			
FP-FLOOD PLAN	IV	SIC-SILTY CLAY	0.4 - 0.1		
		C-CLAY			
		SC-SANDY CLAY			

STRUCTURE

- SG-SINGLE GRAIN
- M-MASSIVE
- CR-CRUMB
- GR-GRANULAR
- SBK-SUBANGULAR BLOCKY
- ABK-ANGULAR BLOCKY
- PL-PLATY
- PR-PRISMATIC

MINERALOGY

- SLIGHTLY EXPANSIVE
- EXPANSIVE

Show profile locations and other site features (dimensions, reference or benchmark, and North).

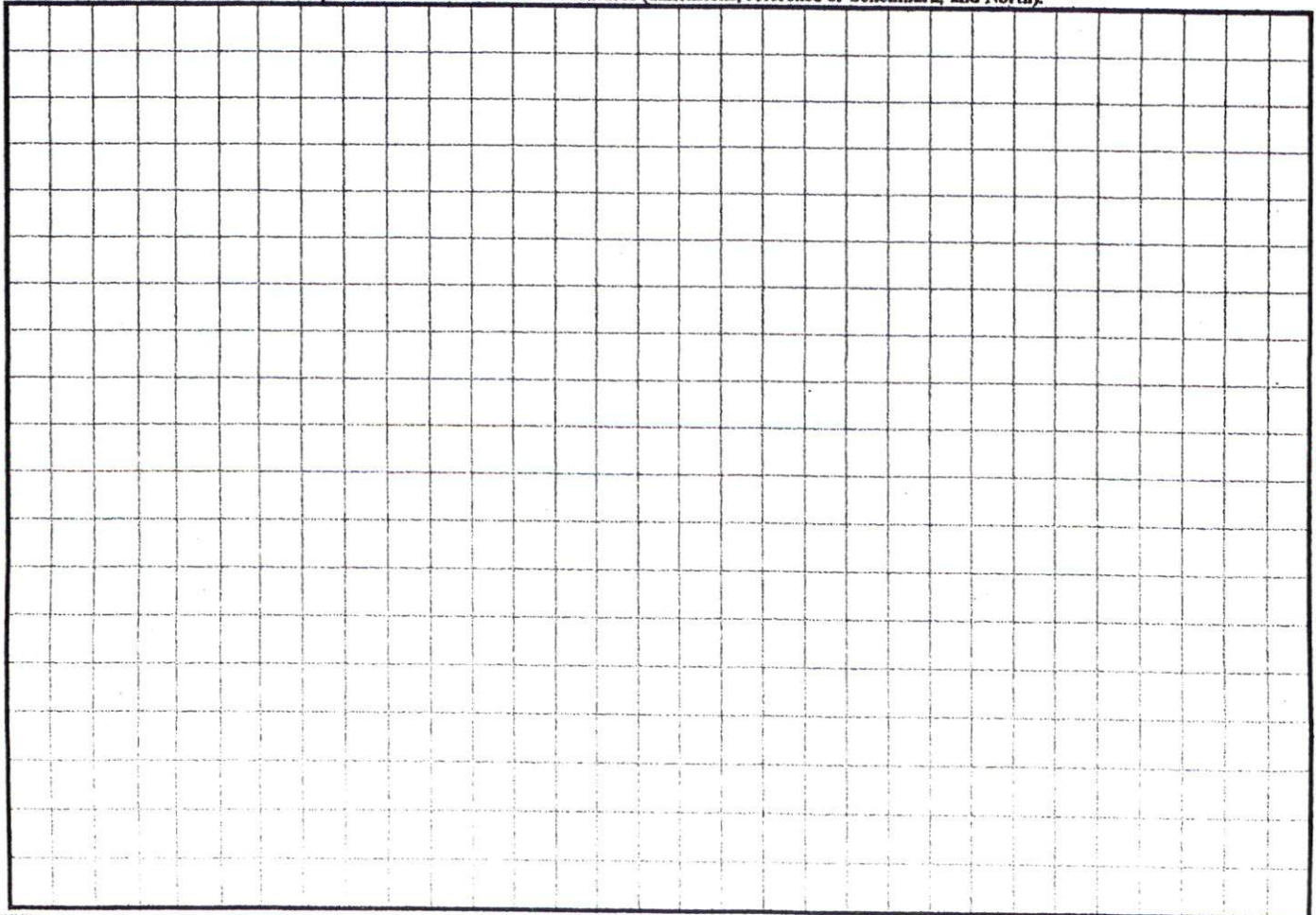

SOUTHEASTEN SOIL & ENVIRONMENTAL ASSOC, INC.

PROPOSED SUBSURFACE WASTE DISPOSAL SYSTEM DETAIL SHEET

SUBDIVISION Tinian Point

LOT 40

INITIAL SYSTEM Pump to Approved 25% reduction

REPAIR pump to approved 25% reduction

DISTRIBUTION serial

DISTRIBUTION serial

BENCHMARK 100.0

LOCATION Front elec box #10

NO. BEDROOMS 3

39/40  
proposed LTAR = 0.4 gal/ft<sup>2</sup>

<u>LINE</u>	<u>FLAG COLOR</u>	<u>ELEVATION</u>	<u>ACTUAL LENGTH</u>
-------------	-------------------	------------------	----------------------

*Fractal*

1	B	98.58	75'
2	Y	97.67	75'
3	W	96.75	75'
4	B	95.84	60'
			<u>285'</u>
5	Y	94.92	60'
6	W	93.17	60'
7	B	92.08	60'
8	Y	90.84	<del>60'</del>
			<u>240'</u>

BY M EAKER

DATE 08/2008

0-30 LS  
30-76+ SLL  
736"

0-20 LS  
20-70+ SLL  
0-20 36"

# Southeastern Soil & Environmental Associates, Inc.

P.O. Box 9321  
Fayetteville, NC 28311  
Phone/Fax (910) 822-4540  
Email mike@southeasternsoil.com

TINGEN POINT  
LOT 40  
PROPOSED SEPTIC

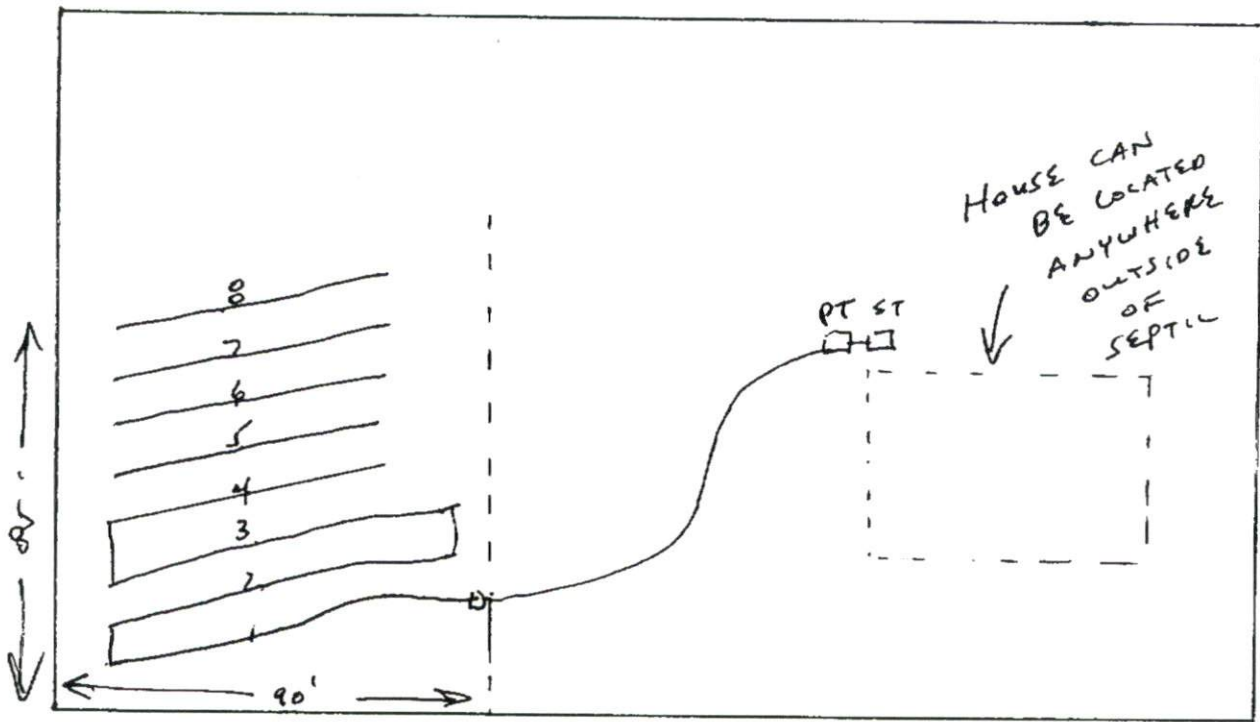

Septic AREA  
90' x 85'

1" = 40'