

September 2, 2008

Harnett County Government Complex
307 Cornelius Harnett Boulevard
Lillington, NC 27546

Wynn Construction
1696 Hayes Rd
Creedmoor, NC 27522

ph: 910-893-7547
fax: 910-893-9371

Re: Status of Improvement Permit Application **Tingen Point**
#08-5-20750 - Lt 42
#08-5-20777 - Lt 40
#08-5-20771 - Lt 39

To Whom It May Concern,

An attempt was made to evaluate your property for the purpose of issuing an Improvement Permit. The evaluation could not be completed for one or more of the following reasons.

- 1. Property lines/corners not marked or labeled (*\$25.00 fee incurred*)
- 2. House corners not marked or labeled (*\$25.00 fee incurred*)
- 3. Directions not clear to property (*\$25.00 fee incurred*)
- 4. Property needs brush or vegetation removed
- 5. Backhoe pits required
- 6. **Other – Move homes as shown and submit changes to Central Permitting.**

Your application will be put on hold until the selected items above have been addressed. When completed please call 910-893-7527 to confirm that the items mentioned have been corrected, we will then reschedule your property for evaluation.

Sincerely,

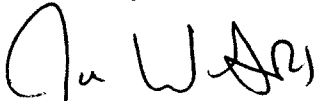

Joe West, R. S.
Environmental Health Specialist
Harnett County Department of Public Health

JW/sgs
Copy: Central Permitting

Southeastern Soil & Environmental Associates, Inc.

P.O. Box 9321
Fayetteville, NC 28311
Phone/Fax (910) 822-4540
Email mike@southeasternsoil.com

TINGEN Point
Lot 39
PROPOSED SEPTIC

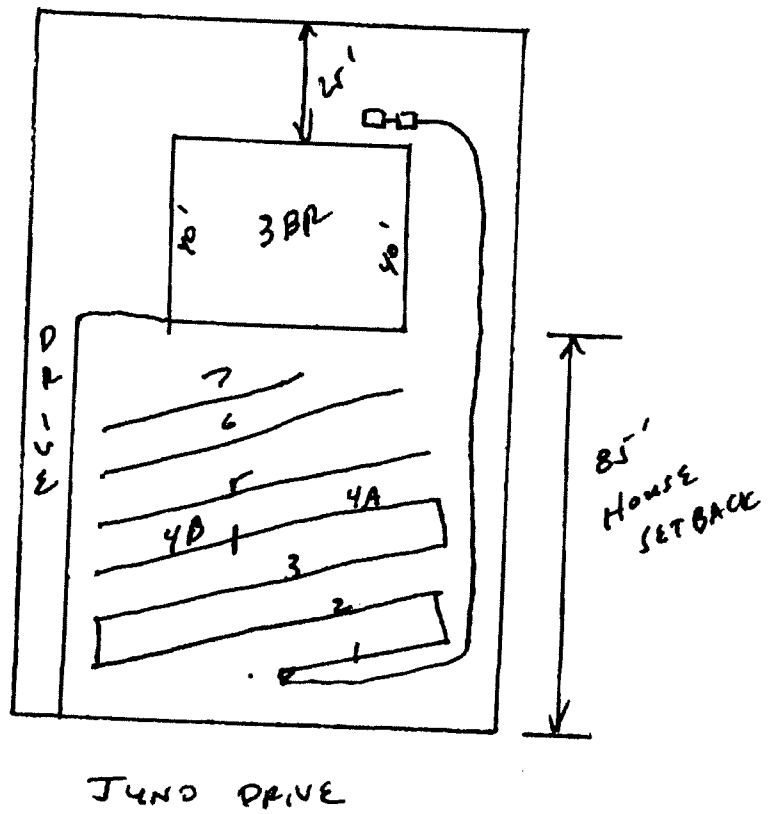

1" = 40'

Southeastern Soil & Environmental Associates, Inc.

P.O. Box 9321
Fayetteville, NC 28311
Phone/Fax (910) 822-4540
Email mike@southeasternsoil.com

TINGEN POINT
LOT 40
PROPOSED SEPTIC

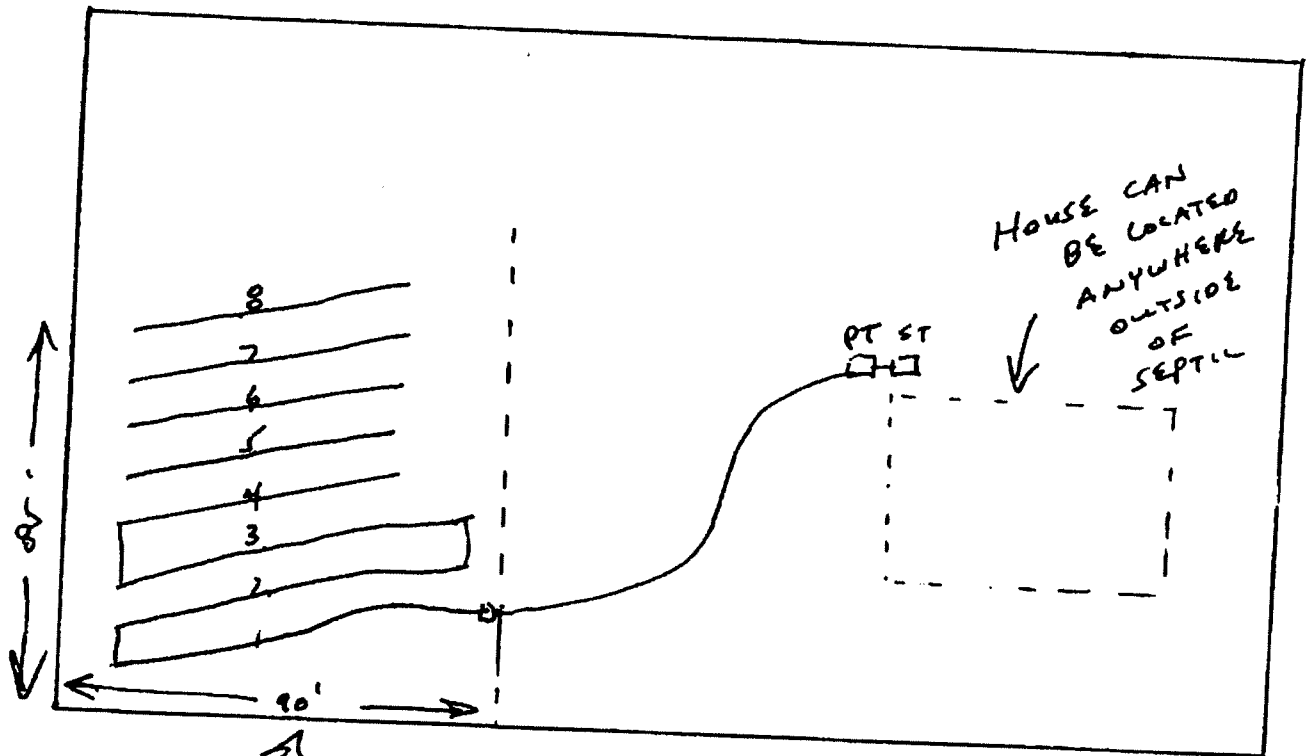

Septic AREA
90' x 85'

JUNG DRIVE

1" = 40'

Southeastern Soil & Environmental Associates, Inc.

P.O. Box 9321
Fayetteville, NC 28311
Phone/Fax (910) 822-4540
Email mika@southeasternsoil.com

TINCEN POINT
LOT 42
PROPOSED SEPTIC

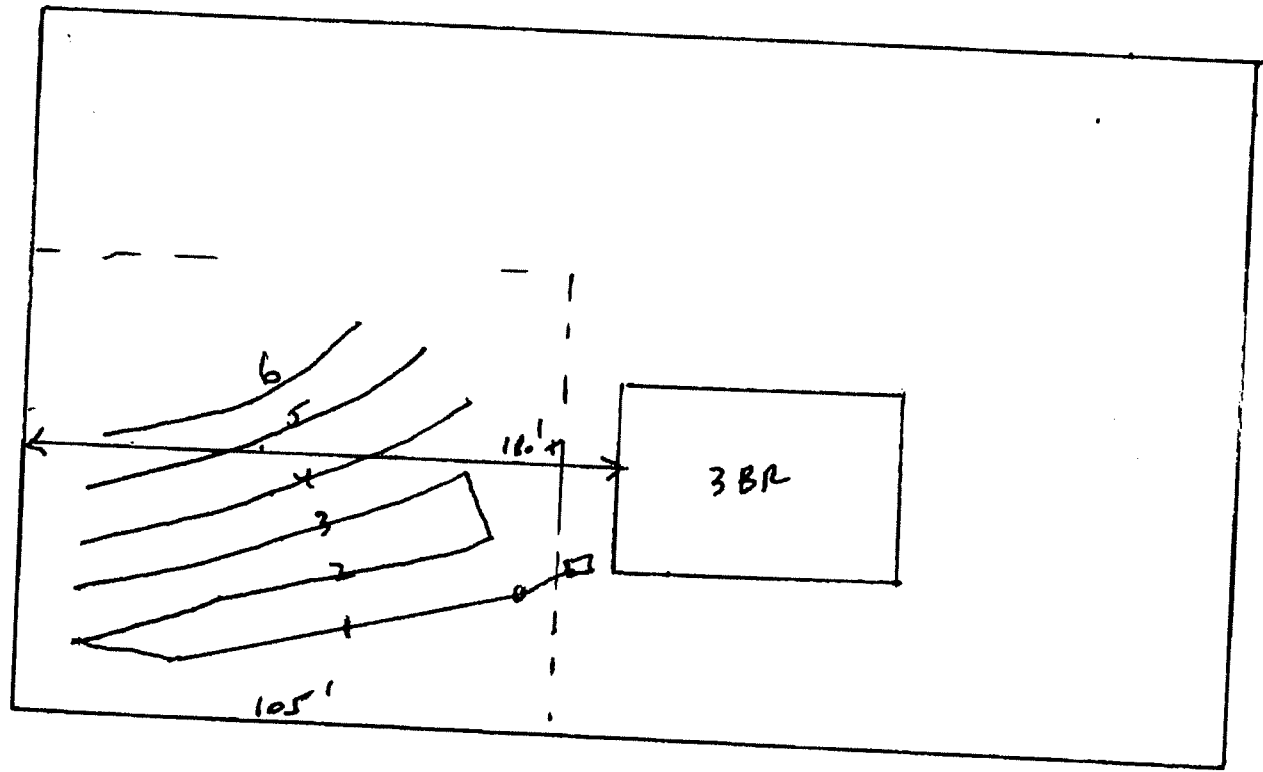

JUNO DRIVE

HOUSE AT LEAST 110' FROM
LEFT SIDE PROP. LINE

1" = 40'