

September 2, 2008

Harnett County Government Complex  
307 Cornelius Harnett Boulevard  
Lillington, NC 27546

Wynn Construction  
1696 Hayes Rd  
Creedmoor, NC 27522

ph: 910-893-7547  
fax: 910-893-9371

**Re: Status of Improvement Permit Application** **Tingen Point**  
#08-5-20750 - Lt 42  
#08-5-20777 - Lt 40  
#08-5-20771 - Lt 39

To Whom It May Concern,

An attempt was made to evaluate your property for the purpose of issuing an Improvement Permit. The evaluation could not be completed for one or more of the following reasons.

- 1. Property lines/corners not marked or labeled (*\$25.00 fee incurred*)
- 2. House corners not marked or labeled (*\$25.00 fee incurred*)
- 3. Directions not clear to property (*\$25.00 fee incurred*)
- 4. Property needs brush or vegetation removed
- 5. Backhoe pits required
- 6. **Other – Move homes as shown and submit changes to Central Permitting.**

Your application will be put on hold until the selected items above have been addressed. When completed please call 910-893-7527 to confirm that the items mentioned have been corrected, we will then reschedule your property for evaluation.

Sincerely,

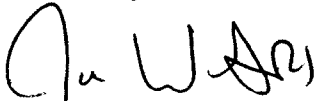

Joe West, R. S.  
Environmental Health Specialist  
Harnett County Department of Public Health

JW/sgs  
Copy: Central Permitting

# Southeastern Soil & Environmental Associates, Inc.

P.O. Box 9321  
Fayetteville, NC 28311  
Phone/Fax (910) 822-4540  
Email mike@southeasternsoil.com

TINGEN Point  
Lot 39  
PROPOSED SEPTIC

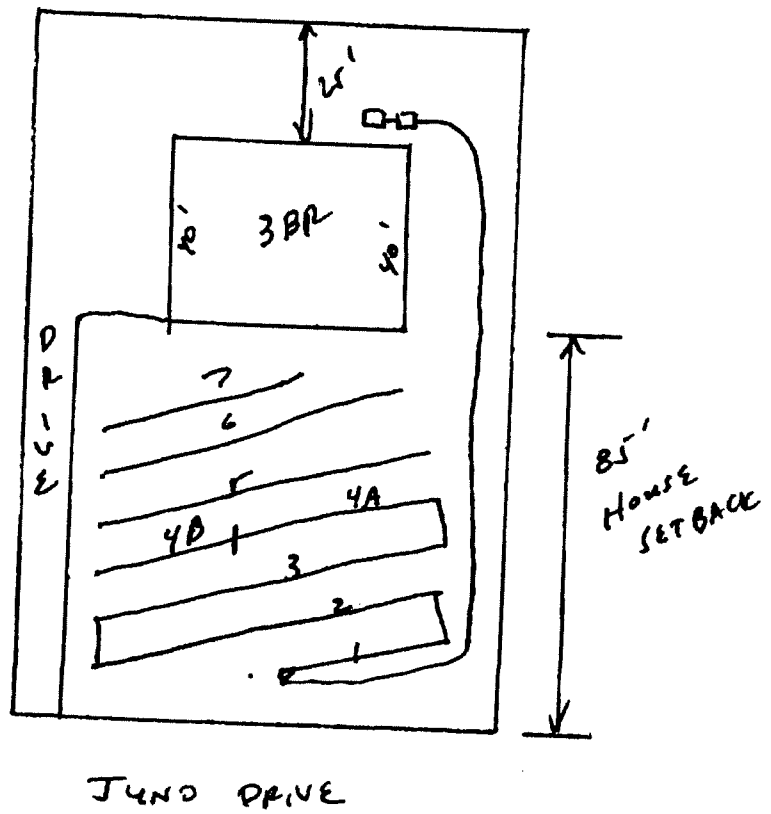

1" = 40'

# Southeastern Soil & Environmental Associates, Inc.

P.O. Box 9321  
Fayetteville, NC 28311  
Phone/Fax (910) 822-4540  
Email [mike@southeasternsoil.com](mailto:mike@southeasternsoil.com)

TINGEN POINT  
LOT 40  
PROPOSED SEPTIC

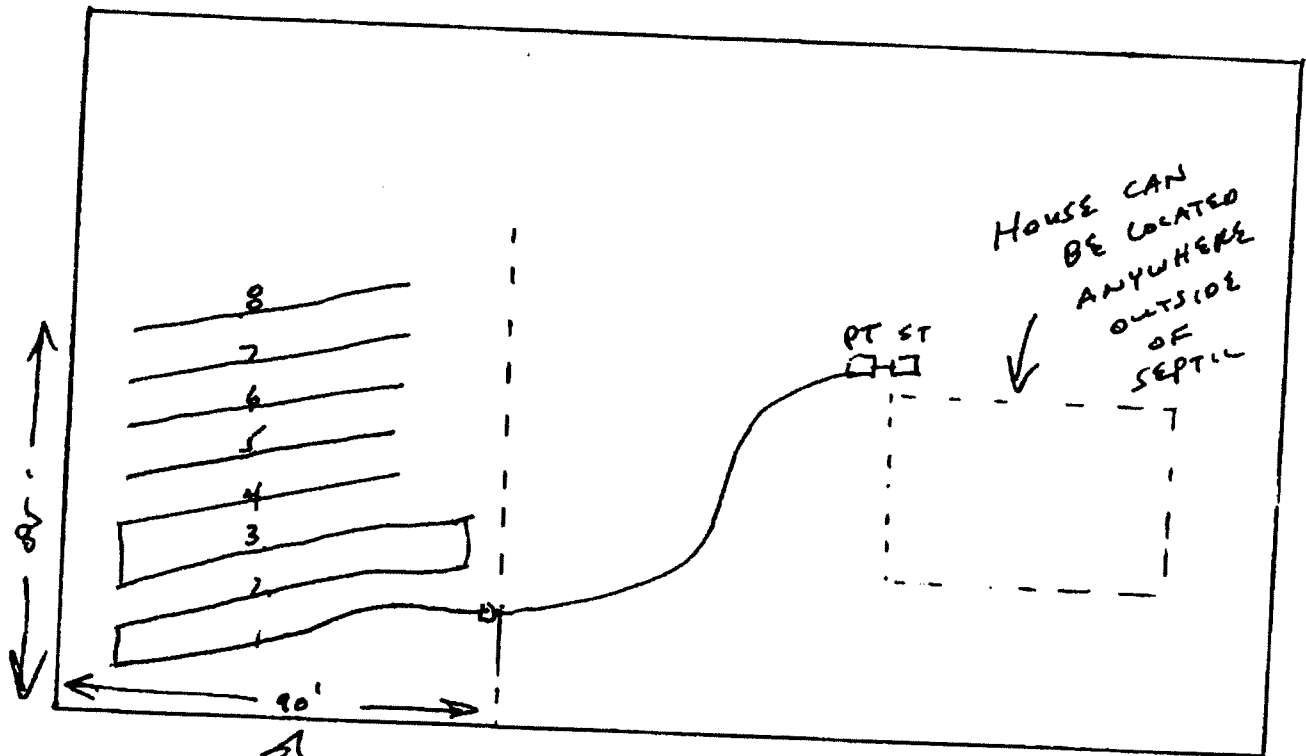

Septic AREA  
90' x 85'

1" = 40'

# Southeastern Soil & Environmental Associates, Inc.

P.O. Box 9321  
Fayetteville, NC 28311  
Phone/Fax (910) 822-4540  
Email mika@southeasternsoil.com

TINCEN POINT  
LOT 42  
PROPOSED SEPTIC

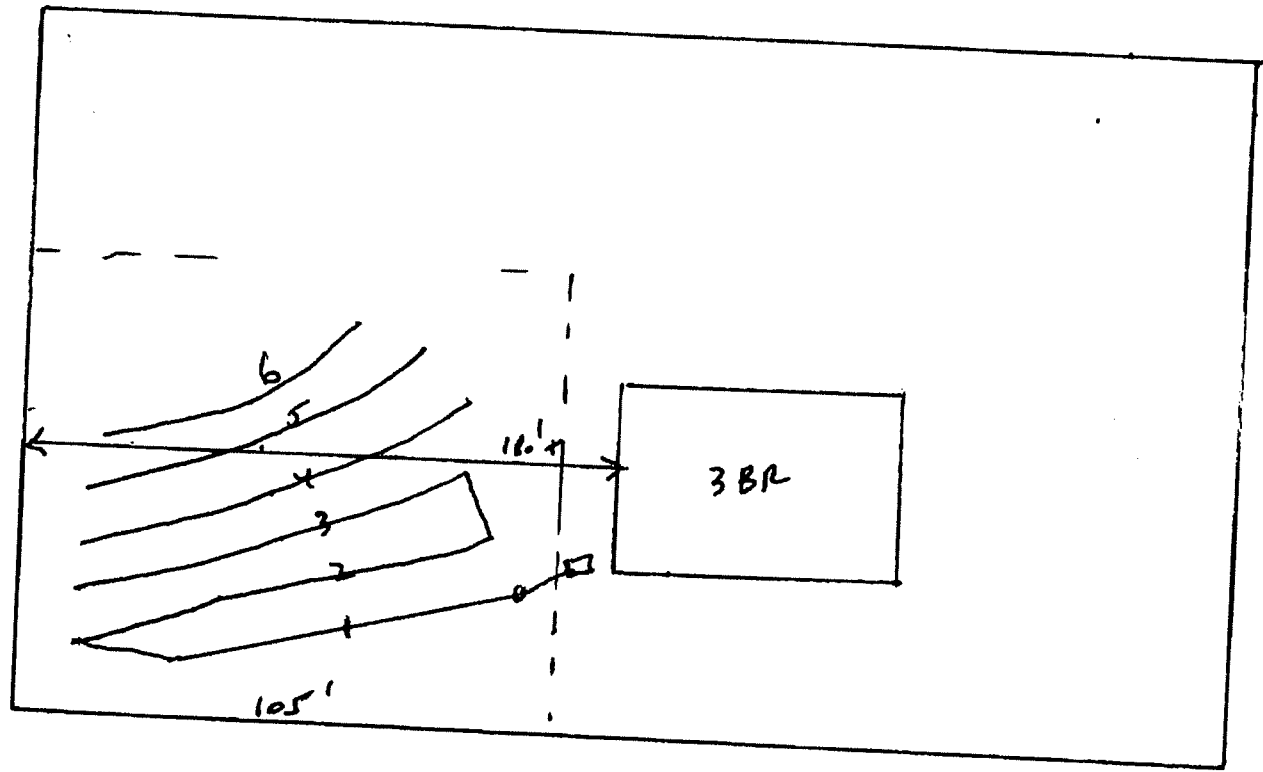

JUNO DRIVE

HOUSE AT LEAST 110' FROM  
LEFT SIDE PROP. LINE

1" = 40'