

Improvement Permit

A building permit cannot be issued with only an Improvement Permit

ISSUED TO: Cumberland Homes PROPERTY LOCATION: 1111
 NEW REPAIR EXPANSION SUBDIVISION: Ashcroft LOT # 124
 Type of Structure: SFD-39x44-3BR Site Improvements required prior to Construction Authorization Issuance:
 Proposed Wastewater System Type: 25% Reduction Sys.
 Projected Daily Flow: 360 GPD
 Number of bedrooms: 3 Number of Occupants: 6 max
 Basement Yes No
 Pump Required: Yes No May be required based on final location and elevations of facilities
 Type of Water Supply: Community Public Well Distance from well 100 feet Permit valid for: Five years
 Permit conditions: Meet onsite for final layout maintain all set back stub out plumbing shallow at ground level or higher where shown No expiration

Authorized State Agent: J. W. [Signature] Date: 09-10-08 SEE ATTACHED SITE SKETCH
 The issuance of this permit by the Health Department in no way guarantees the issuance of other permits. The permit holder is responsible for checking with appropriate governing bodies in meeting their requirements. This site is subject to revocation if the site plan, plat, or the intended use changes. The Improvement Permit shall not be affected by a change in ownership of the site. This permit is subject to compliance with the provisions of the Laws and Rules for Sewage Treatment and Disposal and to conditions of this permit.

Construction Authorization

(Required for Building Permit)

The construction and installation requirements of Rules .1950, .1952, .1954, .1955, .1956, .1957, .1958, and .1959 are incorporated by references into this permit and shall be met. Systems shall be installed in accordance with the attached system layout.

ISSUED TO: Cumberland Homes PROPERTY LOCATION: 1111
 Facility Type: SFD-39x44-3BR New Expansion Repair SUBDIVISION: Ashcroft LOT # 124
 Basement? Yes No Basement Fixtures? Yes No
 Type of Wastewater System** 25% Reduction system (Initial) Wastewater Flow: 360 GPD
 (See note below, if applicable) 25% Reduction system (Repair)

Installation Requirements/Conditions
 Septic Tank Size 1000 gallons Number of trenches 1
 Pump Tank Size _____ gallons Exact length of each trench 180 feet Trench Spacing: 9 Feet on Center
 Trenches shall be installed on contour at a Soil Cover: 6 inches
 Maximum Trench Depth of: 18.21 inches (Maximum soil cover shall not exceed 36" above the trench bottom)
 (Trench bottoms shall be level to +/- 1/4" in all directions)
 Pump Requirements: _____ ft. TDH vs. _____ GPM Aggregate Depth: _____ inches below pipe
 Conditions: _____ inches above pipe
 _____ inches total

**If applicable: I understand the system type specified is different from the type specified on the application. I accept the specifications of this permit.

Owner/Legal Representative Signature: _____ Date: _____

This Construction Authorization is subject to revocation if the site plan, plat, or the intended use changes. The Construction Authorization shall not be transferred when there is a change in ownership of the site. This Construction Authorization is subject to compliance with the provisions of the Laws and Rules for Sewage Treatment and Disposal and to the conditions of this permit. SEE ATTACHED SITE SKETCH

Authorized State Agent: J. W. [Signature] Date: 09-10-08
 Construction Authorization Expiration Date: 09-10-2013

HTE# 08-500-20765

Permit # 25052

Harnett County Department of Public Health Site Sketch

ISSUED TO: Cumberland Homes

PROPERTY LOCATOR: 1111
SUBDIVISION: Asheford

LOT # 124

Authorized State Agent: Ju Lites

Date: 09-10-08

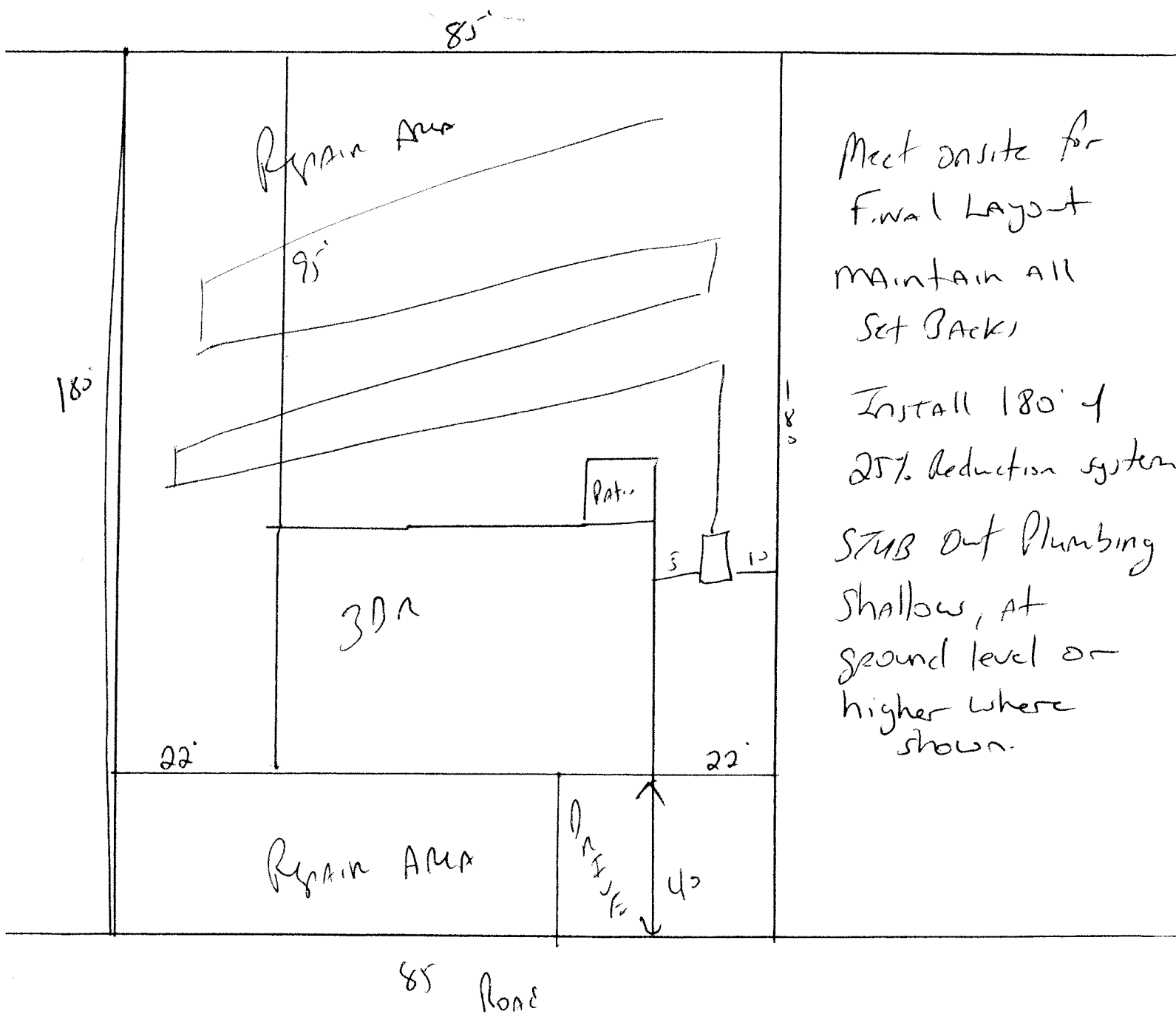

Meet onsite for
Final Layout
Maintain all
Set Backs
Install 180' of
25% Reduction system
Stub out Plumbing
Shallow, at
ground level or
higher where
shown.