

HTE# 08-5-20632

# Harnett County Department of Public Health

24828

## Improvement Permit

A building permit cannot be issued with only an Improvement Permit

ISSUED TO: MARY HUGHES PROPERTY LOCATION: Hwy 401 N  
 NEW  REPAIR  EXPANSION  SUBDIVISION: MILLBRANCH LOT # 19  
 Type of Structure: SFD Site Improvements required prior to Construction Authorization Issuance: \_\_\_\_\_  
 Proposed Wastewater System Type: 25% REDUCTION  
 Projected Daily Flow: 360 GPD  
 Number of bedrooms: 3 Number of Occupants: 6 max  
 Basement  Yes  No  
 Pump Required:  Yes  No  May be required based on final location and elevations of facilities  
 Type of Water Supply:  Community  Public  Well Distance from well \_\_\_\_\_ feet  
 Permit conditions: \_\_\_\_\_ Permit valid for:  Five years  No expiration

Authorized State Agent: James E. Marshall Date: 8-1-08 SEE ATTACHED SITE SKETCH  
 The issuance of this permit by the Health Department in no way guarantees the issuance of other permits. The permit holder is responsible for checking with appropriate governing bodies in meeting their requirements. This site is subject to revocation if the site plan, plat, or the intended use changes. The Improvement Permit shall not be affected by a change in ownership of the site. This permit is subject to compliance with the provisions of the Laws and Rules for Sewage Treatment and Disposal and to conditions of this permit.

## Construction Authorization

(Required for Building Permit)

The construction and installation requirements of Rules .1950, .1952, .1954, .1955, .1956, .1957, .1958, and .1959 are incorporated by references into this permit and shall be met. Systems shall be installed in accordance with the attached system layout.

ISSUED TO: MARY HUGHES PROPERTY LOCATION: Hwy 401 N  
 Facility Type: SFD  New  Expansion  Repair  
 Basement?  Yes  No Basement Fixtures?  Yes  No  
 Type of Wastewater System\*\* 25% REDUCTION System (Initial) Wastewater Flow: 360 GPD  
 (See note below, if applicable )  
25% REDUCTION System (Repair)  
**Installation Requirements/Conditions**  
 Septic Tank Size 1000 gallons Number of trenches 3  
 Pump Tank Size \_\_\_\_\_ gallons Exact length of each trench 120 feet Trench Spacing: 9 Feet on Center  
 Trenches shall be installed on contour at a Soil Cover: 6 inches  
 Maximum Trench Depth of: 22'-28" to 22' inches (Maximum soil cover shall not exceed 36" above the trench bottom)  
 (Trench bottoms shall be level to +1-1/4" in all directions)  
 Pump Requirements: \_\_\_\_\_ ft. TDH vs. \_\_\_\_\_ GPM Aggregate Depth: 6 inches below pipe  
 \_\_\_\_\_ inches above pipe  
 \_\_\_\_\_ inches total

\*\*If applicable: I understand the system type specified is different from the type specified on the application. I accept the specifications of this permit.

Owner/Legal Representative Signature: \_\_\_\_\_ Date: \_\_\_\_\_

This Construction Authorization is subject to revocation if the site plan, plat, or the intended use changes. The Construction Authorization shall not be transferred when there is a change in ownership of the site. This Construction Authorization is subject to compliance with the provisions of the Laws and Rules for Sewage Treatment and Disposal and to the conditions of this permit. SEE ATTACHED SITE SKETCH

Authorized State Agent: James E. Marshall Date: 8-1-08  
 Construction Authorization Expiration Date: 8-1-13

HTE# 08-5-20632

Permit # 24828

# Harnett County Department of Public Health Site Sketch

ISSUED TO: DARY HUGHES PROPERTY LOCATOR: Hwy 401 N  
SUBDIVISION MILL BRANCH LOT # 19

Authorized State Agent: James E. Mahant Date: 8-1-08

\* Contractor to meet  
on SITE prior to  
INSTALL.

\* LINES MAY BE  
WIDER THAN 9'  
ON CENTERS TO  
ACHIEVE PROPER  
DEPTHS.

\* START DITCHES  
AT 22" AND GO TO  
28" DEEP AND GO  
BACK TO 22"!

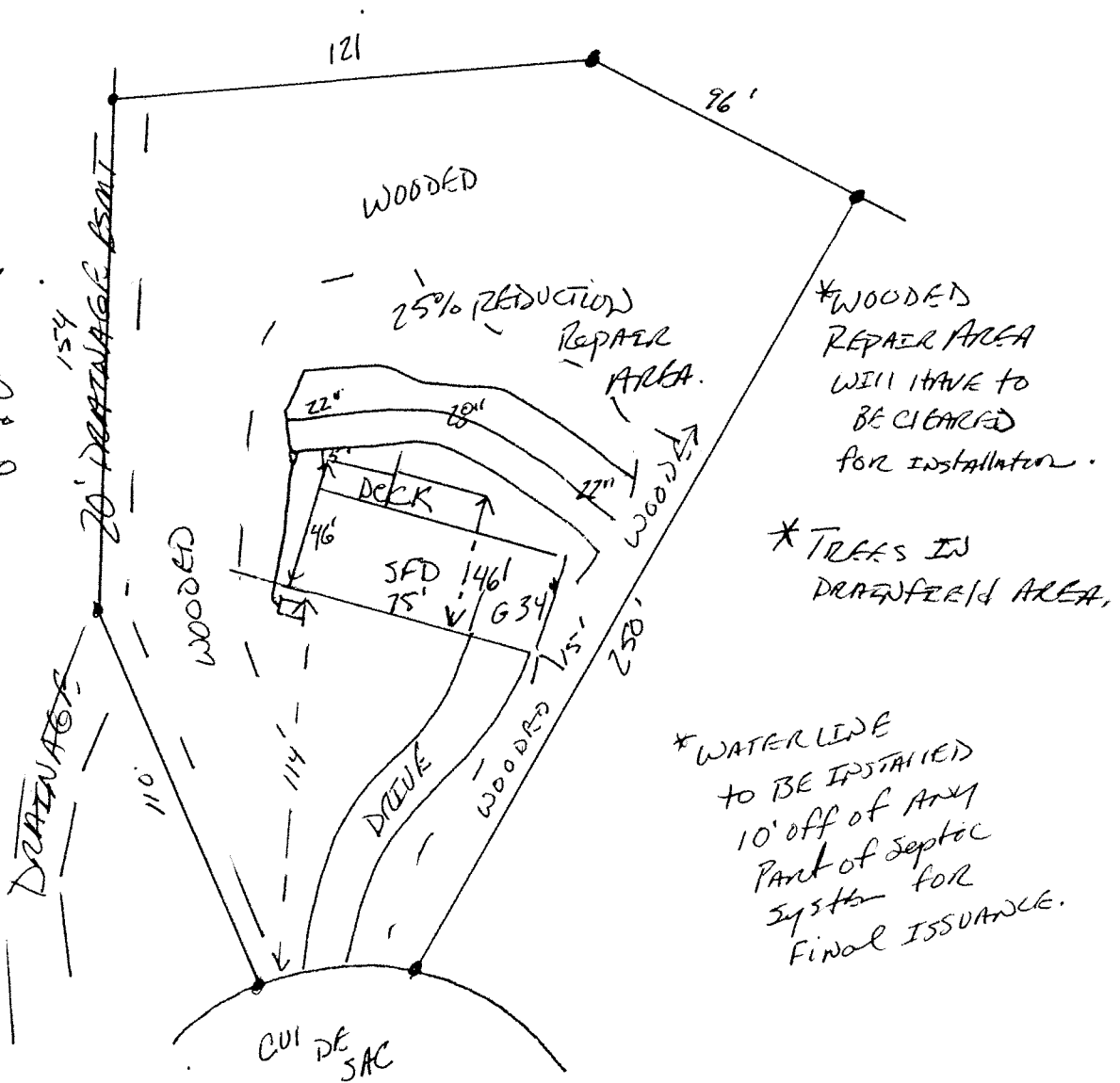

\* WOODED  
REPAIR AREA  
WILL HAVE TO  
BE CLEARED  
FOR INSTALLATION.

\* TREES IN  
DRAINAGE AREA,

\* WATER LINE  
TO BE INSTALLED  
10' OFF OF ANY  
PART OF SEPTIC  
SYSTEM FOR  
FINAL ISSUANCE.