

HTE# 08-500-20564

Harnett County Department of Public Health

24961

Improvement Permit

A building permit cannot be issued with only an Improvement Permit

ISSUED TO: Cumberland Home PROPERTY LOCATION: 1111  
NEW  REPAIR  EXPANSION  SUBDIVISION: Asheford LOT # 64

Type of Structure: SFD-50x37-30A

Proposed Wastewater System Type: Pump to 25% Reducer

Projected Daily Flow: 360 GPD

Number of bedrooms: 3 Number of Occupants: 6 max

Basement  Yes  No

Pump Required:  Yes  No  May be required based on final location and elevations of facilities

Type of Water Supply:  Community  Public  Well Distance from well 100 feet

Permit valid for:  Five years  No expiration

Permit conditions: STUD at Plumbing shallow where shown at Grand level or higher maintain ALL set BACKS meet orite

Authorized State Agent: J. L. Williams Date: 08-18-08 SEE ATTACHED SITE SKETCH

The issuance of this permit by the Health Department in no way guarantees the issuance of other permits. The permit holder is responsible for checking with appropriate governing bodies in meeting their requirements. This site is subject to revocation if the site plan, plat, or the intended use changes. The Improvement Permit shall not be affected by a change in ownership of the site. This permit is subject to compliance with the provisions of the Laws and Rules for Sewage Treatment and Disposal and to conditions of this permit.

Construction Authorization

(Required for Building Permit)

The construction and installation requirements of Rules .1950, .1952, .1954, .1955, .1956, .1957, .1958, and .1959 are incorporated by references into this permit and shall be met. Systems shall be installed in accordance with the attached system layout.

ISSUED TO: Cumberland Home PROPERTY LOCATION: 1111  
SUBDIVISION: Asheford LOT # 64

Facility Type: SFD-50x37-30A  New  Expansion  Repair

Basement?  Yes  No Basement Fixtures?  Yes  No

Type of Wastewater System\*\* Pump to 25% Red. system (Initial) Wastewater Flow: 360 GPD

(See note below, if applicable)  25% Reduction system (Repair)

Installation Requirements/Conditions

Septic Tank Size 1000 gallons

Pump Tank Size 1000 gallons

Number of trenches 1

Exact length of each trench 180 feet

Trenches shall be installed on contour at a

Maximum Trench Depth of: 18.24 inches

(Trench bottoms shall be level to +/-1/4"

in all directions)

Trench Spacing: 7 Feet on Center

Soil Cover: 6 inches

(Maximum soil cover shall not exceed

36" above the trench bottom)

Pump Requirements: \_\_\_\_\_ ft. TDH vs. \_\_\_\_\_ GPM

\_\_\_\_\_ inches below pipe

Aggregate Depth: \_\_\_\_\_ inches above pipe

Conditions: \_\_\_\_\_ inches total

\*\*If applicable: I understand the system type specified is different from the type specified on the application. I accept the specifications of this permit.

Owner/Legal Representative Signature: \_\_\_\_\_ Date: \_\_\_\_\_

This Construction Authorization is subject to revocation if the site plan, plat, or the intended use changes. The Construction Authorization shall not be transferred when there is a change in ownership of the site. This

Construction Authorization is subject to compliance with the provisions of the Laws and Rules for Sewage Treatment and Disposal and to the conditions of this permit.

SEE ATTACHED SITE SKETCH

Authorized State Agent: J. L. Williams Date: 08-18-08  
Construction Authorization Expiration Date: 08-18-2017

HTE# 08500-20564

Permit # 24961

# Harnett County Department of Public Health Site Sketch

ISSUED TO: Cumberland Homes

PROPERTY LOCATOR: 1111  
SUBDIVISION: Ashcroft

LOT # 64

Authorized State Agent: J. W. [Signature]

Date: 08-18-08

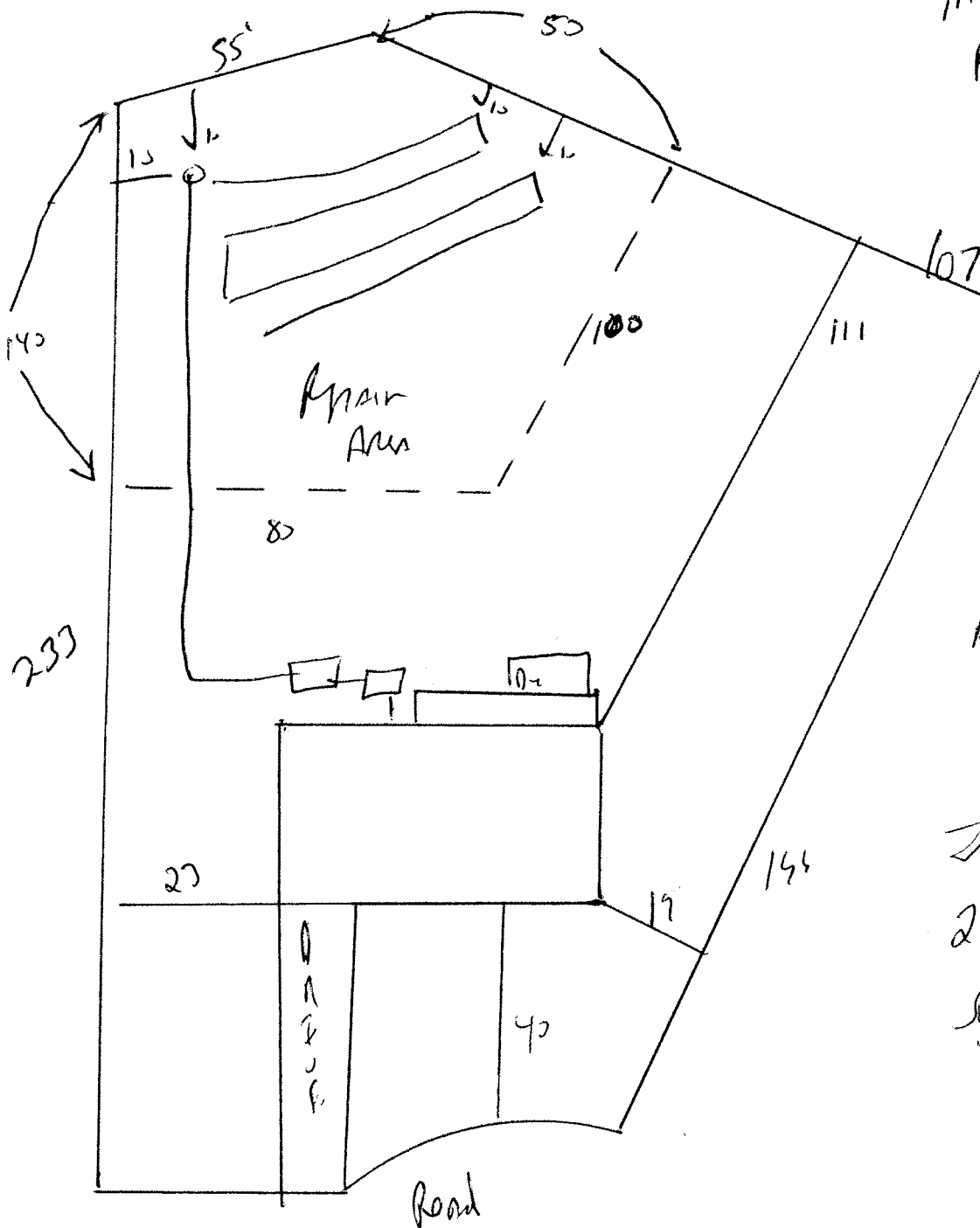

Meet onsite for  
Final Layout  
maintain All  
set Backs

STUB OUT  
Plumbing shallow  
At ground level  
or higher where  
shown

Install 180' of  
25% Reduction  
System at 18 to 24'