

July 23, 2008

Wynn Const
2550 Capital Dr., Suite 105
Creedmor, NC 27522

Harnett County Government Complex
307 Cornelius Harnett Boulevard
Lillington, NC 27546

ph: 910-893-7547
fax: 910-893-9371

RE: Harnett County Land Use Application HTE 08-5-20485
Lt 6 Pioneer Farms
HTE 08-5-20487
Lt 18 Pioneer Farms

To Whom It May Concern:

An attempt was made to evaluate your property for the purpose of issuing an Improvement Permit. The evaluation could not be completed for one or more of the following reasons.

- 1. Property lines/corners not marked or labeled ~ *\$25.00 fee incurred*
- 2. House corners not marked or labeled ~ *\$25.00 fee incurred*
- 3. Directions not clear to property ~ *\$25.00 fee incurred*
- 4. Property needs brush or vegetation removed
- 5. Backhoe pits required
- 6. Other *Change house location as shown on attached. Submit a new plot plan to Central Permitting.*

Your application will be put on hold until the selected items above have been addressed. When completed please call 910-893-7547 to confirm that the items mentioned have been corrected, we will then reschedule your property for evaluation.

Sincerely,

Joe West, R.S.
Environmental Health Specialist
Harnett County Department of Public Health
Environmental Health

JW/sgw

Copy: Central Permitting

08-500 - 20485
Lot #6 Pioneer Farms
Wynn Court.

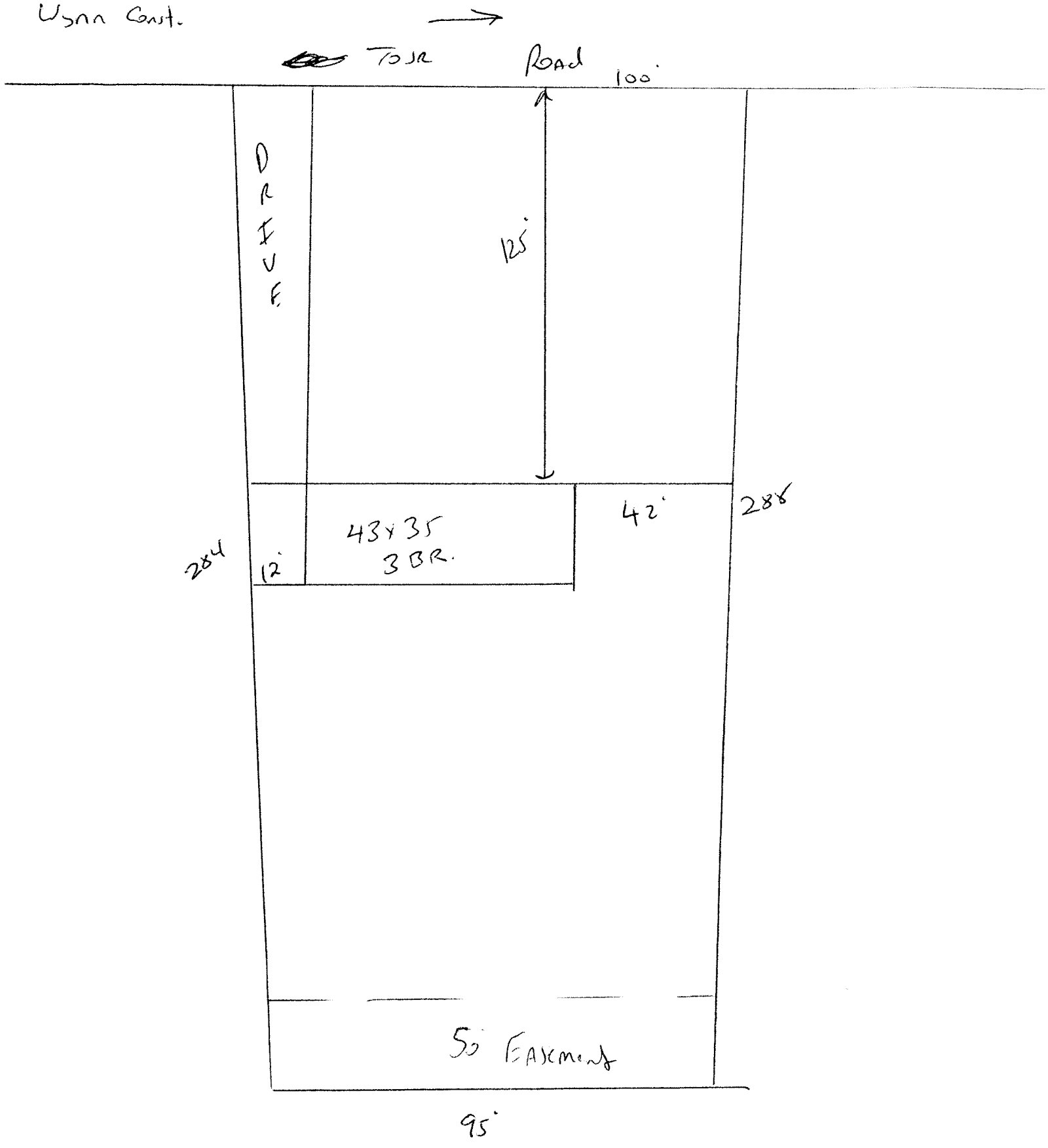

08.500 20487

Lot #18 Pioneer Farms

Wynn Cont.

← To SR

Road

