

HTE# 08-5-20301R

Harnett County Department of Public Health 24577

Improvement Permit

A building permit cannot be issued with only an Improvement Permit

ISSUED TO: Comfort Homes, Inc. PROPERTY LOCATION: SR 1412 Christian Light Rd
 NEW REPAIR 67 EXPANSION SUBDIVISION: Forest Trails LOT # 112
 Type of Structure: SFD 72 x 47' 40" BM Site Improvements required prior to Construction Authorization Issuance:
 Proposed Wastewater System Type: 25% Reduction System
 Projected Daily Flow: 360 GPD
 Number of bedrooms: 3 Number of Occupants: 6 max
 Basement Yes No
 Pump Required: Yes No May be required based on final location and elevations of facilities
 Type of Water Supply: Community Public Well Distance from well 100 feet Permit valid for: Five years
 Permit conditions: _____ No expiration

Authorized State Agent: Bryan McSwain, R.S. Date: 7/17/2008 10/20/2009 BM SEE ATTACHED SITE SKETCH
 The issuance of this permit by the Health Department in no way guarantees the issuance of other permits. The permit holder is responsible for checking with appropriate governing bodies in meeting their requirements. This site is subject to revocation if the site plan, plat, or the intended use changes. The Improvement Permit shall not be affected by a change in ownership of the site. This permit is subject to compliance with the provisions of the Laws and Rules for Sewage Treatment and Disposal and to conditions of this permit.

Construction Authorization

(Required for Building Permit)

The construction and installation requirements of Rules .1950, .1952, .1954, .1955, .1956, .1957, .1958, and .1959 are incorporated by references into this permit and shall be met. Systems shall be installed in accordance with the attached system layout.

ISSUED TO: Comfort Homes, Inc. PROPERTY LOCATION: SR 1412
 Facility Type: SFD New Expansion Repair
 Basement? Yes No Basement Fixtures? Yes No
 Type of Wastewater System** 25% Reduction System (Initial) Wastewater Flow: 360 GPD
 (See note below, if applicable)
25% Reduction System (Repair)

Installation Requirements/Conditions

Septic Tank Size 1000 gallons Exact length of each trench 4x80 feet Trench Spacing: 9 Feet on Center
 Pump Tank Size _____ gallons Trenches shall be installed on contour at a Soil Cover: 6 inches
 Maximum Trench Depth of: 18 inches (Maximum soil cover shall not exceed 36" above the trench bottom)
 (Trench bottoms shall be level to +/- 1/4" in all directions)
 Pump Requirements: _____ ft. TDH vs. _____ GPM _____ inches below pipe
 Aggregate Depth: _____ inches above pipe
 Conditions: Drain lines to be run on contour + NO DEEPER than 18 inches
Trench spacing may be greater than 9 ft. on center

**If applicable: I understand the system type specified is different from the type specified on the application. I accept the specifications of this permit.

Owner/Legal Representative Signature: _____ Date: _____

This Construction Authorization is subject to revocation if the site plan, plat, or the intended use changes. The Construction Authorization shall not be transferred when there is a change in ownership of the site. This Construction Authorization is subject to compliance with the provisions of the Laws and Rules for Sewage Treatment and Disposal and to the conditions of this permit.

Authorized State Agent: Bryan McSwain, R.S. Date: 7/17/2008 10/20/2009 BM SEE ATTACHED SITE SKETCH
 Construction Authorization Expiration Date: 7/17/2013 10/20/2014

HTE# 08-5-20301 R

Permit # 24577

Harnett County Department of Public Health Site Sketch

ISSUED TO: Comfort Homes, Inc.

PROPERTY LOCATION: SR1412 Christina Light Rd.
SUBDIVISION Forest Trails LOT # 112

Authorized State Agent: Ryan McSwain, L.S.

Date: 7/17/2009 10/20/2009 *DM*

*System layout may differ from sketch due to contour of land

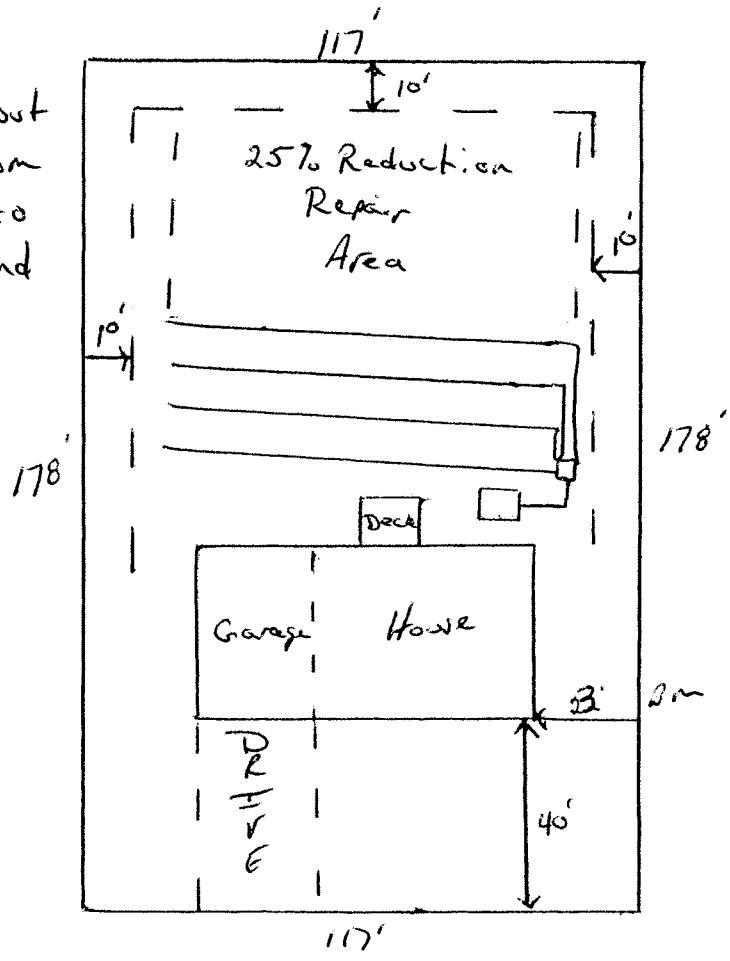

Kinsman Court