

HTE# 08-500-20004

Harnett County Department of Public Health

24783

Improvement Permit

A building permit cannot be issued with only an Improvement Permit

ISSUED TO: Israel Lucas PROPERTY LOCATION: 1141
NEW REPAIR EXPANSION SUBDIVISION: Sunset Ridge LOT # 168

Type of Structure: SFD-50x44-30n Site Improvements required prior to Construction Authorization Issuance:
Proposed Wastewater System Type: Pump to 25% Red. Syst.
Projected Daily Flow: 360 GPD

Number of bedrooms: 3 Number of Occupants: 4 max
Basement Yes No
Pump Required: Yes No May be required based on final location and elevations of facilities

Type of Water Supply: Community Public Well Distance from well 50 feet Permit valid for: Five years
Permit conditions: STUB OUT PLUMBING SHALLOW - AT GRADE LEVEL OR HIGHER WHERE SHOWN AND IF 18" DIA. DITCH SYSTEMS CAN BE MAINTAINED THEN PUMP MAY NOT BE REQUIRED MEET ON-SITE No expiration

Authorized State Agent: J. Lucas Date: 05-21-08 SEE ATTACHED SITE SKETCH

The issuance of this permit by the Health Department in no way guarantees the issuance of other permits. The permit holder is responsible for checking with appropriate governing bodies in meeting their requirements. This site is subject to revocation if the site plan, plat, or the intended use changes. The Improvement Permit shall not be affected by a change in ownership of the site. This permit is subject to compliance with the provisions of the Laws and Rules for Sewage Treatment and Disposal and to conditions of this permit.

Construction Authorization

(Required for Building Permit)

The construction and installation requirements of Rules .1950, .1952, .1954, .1955, .1956, .1957, .1958, and .1959 are incorporated by references into this permit and shall be met. Systems shall be installed in accordance with the attached system layout.

ISSUED TO: Israel Lucas PROPERTY LOCATION: 1141
FACILITY TYPE: SFD-50x44-30n New Expansion Repair
SUBDIVISION: Sunset Ridge LOT # 168

Basement? Yes No Basement Fixtures? Yes No
Type of Wastewater System** Pump to 25% Reduction system (Initial) Wastewater Flow: 360 GPD
(See note below, if applicable) 25% Reduction system (Repair)

Installation Requirements/Conditions
Septic Tank Size 1000 gallons
Pump Tank Size 1000 gallons
Number of trenches 1
Exact length of each trench 180 feet
Trenches shall be installed on contour at a
Maximum Trench Depth of: 18.24 inches
(Trench bottoms shall be level to +/-1/4" in all directions)
Trench Spacing: 9 Feet on Center
Soil Cover: 6 inches
(Maximum soil cover shall not exceed 36" above the trench bottom)

Pump Requirements: _____ ft. TDH vs. _____ GPM
Aggregate Depth: _____ inches below pipe
_____ inches above pipe
_____ inches total

**If applicable: I understand the system type specified is different from the type specified on the application. I accept the specifications of this permit.

Owner/Legal Representative Signature: _____ Date: _____

This Construction Authorization is subject to revocation if the site plan, plat, or the intended use changes. The Construction Authorization shall not be transferred when there is a change in ownership of the site. This Construction Authorization is subject to compliance with the provisions of the Laws and Rules for Sewage Treatment and Disposal and to the conditions of this permit. SEE ATTACHED SITE SKETCH

Authorized State Agent: J. Lucas Date: 05-21-08
Construction Authorization Expiration Date: 05-21-2013

HTE# 08-500-20004

Permit # 24783

Harnett County Department of Public Health Site Sketch

ISSUED TO: Israel Lucas PROPERTY LOCATOR: 1141
SUBDIVISION: Sunset Ridge LOT # 168

Authorized State Agent: J-LA Date: 05-21-08

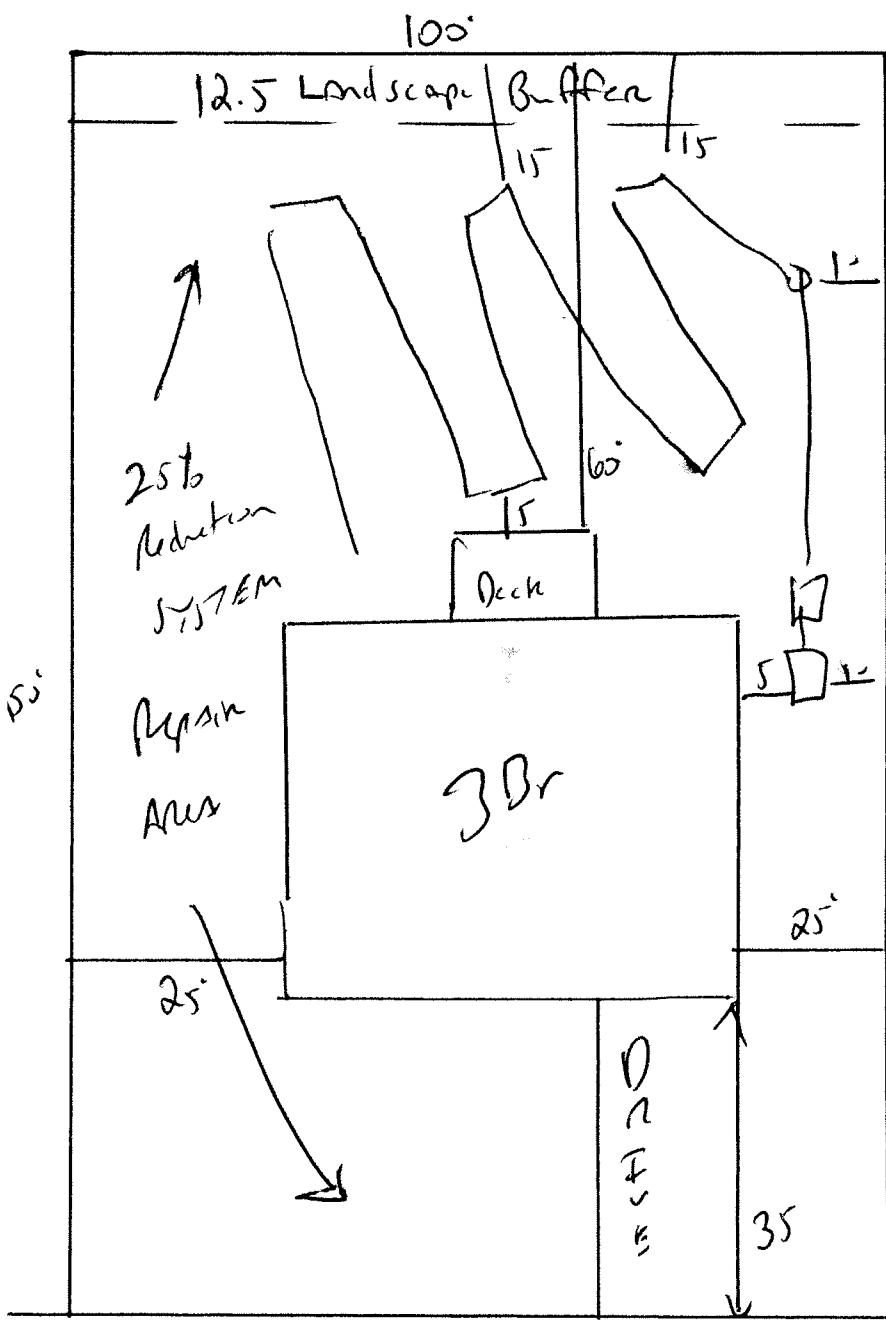

STUB OUT Plumbing
Shallow, At ground
level or higher and
IF 18 to 24" Ditch Depth
can be maintained then
Pump may not be required
Meet onsite
MAINTAIN ALL Jet Backs
Install 180' of 25%
Reduction system at
18 to 24" Dep.