

HTE# 08-500-20001

Harnett County Department of Public Health

24780

Improvement Permit

A building permit cannot be issued with only an Improvement Permit

ISSUED TO: Israel Lucas PROPERTY LOCATION: 1141
 SUBDIVISION: Sunset Ridge LOT # 159
 Type of Structure: NEW REPAIR EXPANSION
 Type of Structure: SFD 44x63 - 3BR
 Proposed Wastewater System Type: 25% Reduction System
 Projected Daily Flow: 360 GPD
 Number of bedrooms: 3 Number of Occupants: 6 max
 Basement Yes No
 Pump Required: Yes No May be required based on final location and elevations of facilities
 Type of Water Supply: Community Public Well Distance from well 50 feet Permit valid for: Five years
 Permit conditions: Meet on site maintain all set back No expiration
STUD out plumbing shallows at ground level or higher where shown
All utilities along left side property line lot 158/159 property line
 Authorized State Agent: J. Lucas Date: 05-21-08 SEE ATTACHED SITE SKETCH

The issuance of this permit by the Health Department in no way guarantees the issuance of other permits. The permit holder is responsible for checking with appropriate governing bodies in meeting their requirements. This site is subject to revocation if the site plan, plat, or the intended use changes. The Improvement Permit shall not be affected by a change in ownership of the site. This permit is subject to compliance with the provisions of the Laws and Rules for Sewage Treatment and Disposal and to conditions of this permit.

Construction Authorization

(Required for Building Permit)

The construction and installation requirements of Rules .1950, .1952, .1954, .1955, .1956, .1957, .1958, and .1959 are incorporated by references into this permit and shall be met. Systems shall be installed in accordance with the attached system layout.

ISSUED TO: Israel Lucas PROPERTY LOCATION: 1141
 SUBDIVISION: Sunset Ridge LOT # 159
 Facility Type: SFD 44x63 - 3BR New Expansion Repair
 Basement? Yes No Basement Fixtures? Yes No
 Type of Wastewater System** 25% Reduction System (Initial) Wastewater Flow: 360 GPD
 (See note below, if applicable 25% Reduction System (Repair))

Installation Requirements/Conditions
 Septic Tank Size 1000 gallons Number of trenches 1
 Pump Tank Size _____ gallons Exact length of each trench 180 feet Trench Spacing: 9 Feet on Center
 Trenches shall be installed on contour at a Soil Cover: 6 inches
 Maximum Trench Depth of: 18.24 inches (Maximum soil cover shall not exceed 36" above the trench bottom)
 (Trench bottoms shall be level to +/-1/4" in all directions)
 Pump Requirements: _____ ft. TDH vs. _____ GPM _____ inches below pipe
 Aggregate Depth: _____ inches above pipe
 Conditions: _____ inches total

**If applicable: I understand the system type specified is different from the type specified on the application. I accept the specifications of this permit.

Owner/Legal Representative Signature: _____ Date: _____

This Construction Authorization is subject to revocation if the site plan, plat, or the intended use changes. The Construction Authorization shall not be transferred when there is a change in ownership of the site. This Construction Authorization is subject to compliance with the provisions of the Laws and Rules for Sewage Treatment and Disposal and to the conditions of this permit. SEE ATTACHED SITE SKETCH

Authorized State Agent: J. Lucas Date: 05-21-08
 Construction Authorization Expiration Date: 05-21-2013

HTE# 08-500-20001

Permit # 24780

Harnett County Department of Public Health Site Sketch

ISSUED TO: Israel Lucas PROPERTY LOCATOR: 1141
SUBDIVISION: Sunset Ridge LOT # 159

Authorized State Agent: [Signature] Date: 05-21-08

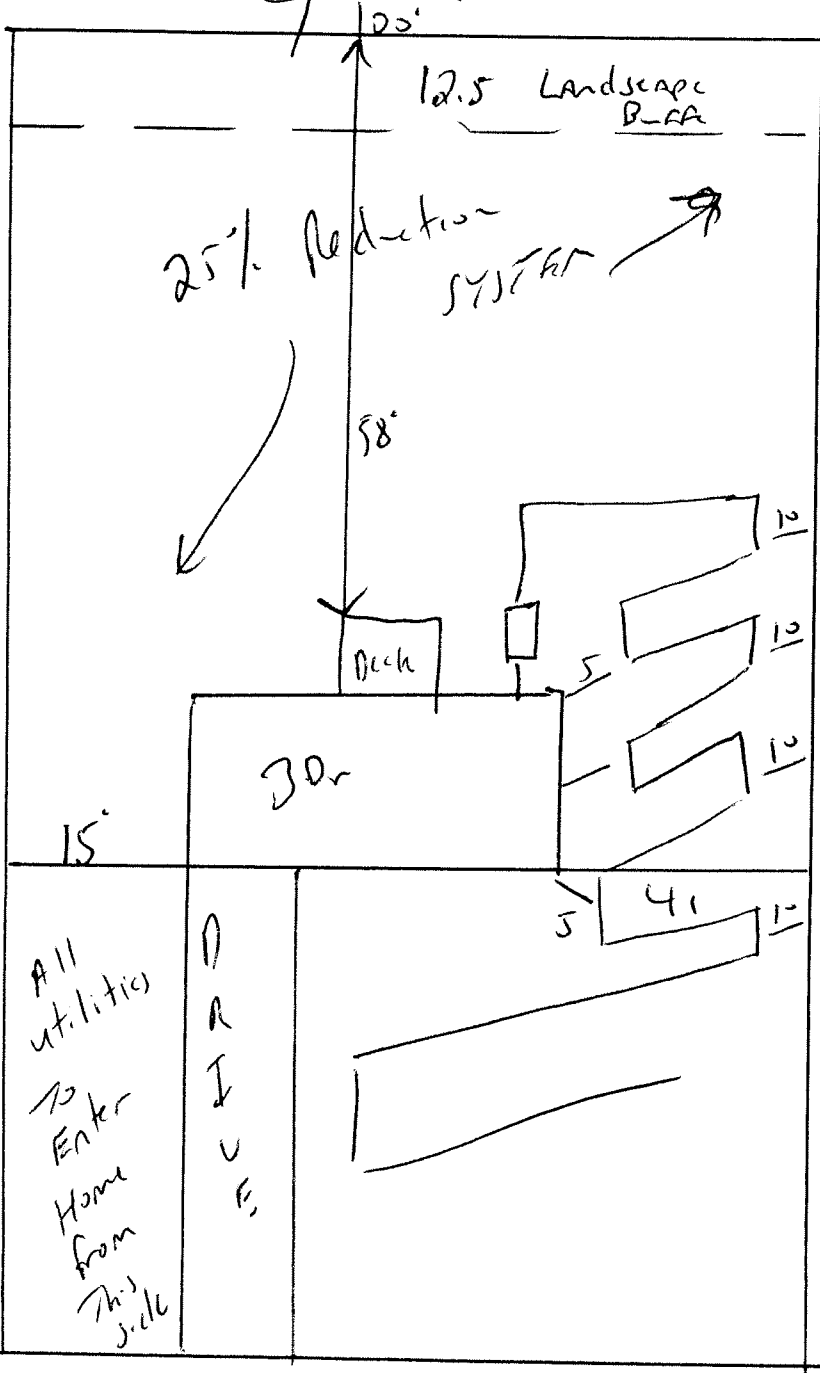

STUB out Plumbing
Shallows at ground level or higher where shown.

Maintain All set Backs
Meet on site

Install 180' of 25%
Reduction system at
18 to 24" Deep.

21 105