

HTE# 08-500-19982

Harnett County Department of Public Health

24792

Improvement Permit

A building permit cannot be issued with only an Improvement Permit

ISSUED TO: Kenneth Cummings PROPERTY LOCATION: 1125
 NEW REPAIR EXPANSION SUBDIVISION: Woodshire LOT # 218
 Type of Structure: SFD - 25x61 30m Site Improvements required prior to Construction Authorization Issuance:
 Proposed Wastewater System Type: 25% Reduction System
 Projected Daily Flow: 360 GPD
 Number of bedrooms: 3 Number of Occupants: 6 max
 Basement Yes No
 Pump Required: Yes No May be required based on final location and elevations of facilities
 Type of Water Supply: Community Public Well Distance from well 50 feet Permit valid for: Five years
 Permit conditions: STUD out Plumbing shallow at ground level or higher No expiration
where shown. meet on site maintain all setbacks

Authorized State Agent: J. Waters Date: 05-27-08 SEE ATTACHED SITE SKETCH
 The issuance of this permit by the Health Department in no way guarantees the issuance of other permits. The permit holder is responsible for checking with appropriate governing bodies in meeting their requirements. This site is subject to revocation if the site plan, plat, or the intended use changes. The Improvement Permit shall not be affected by a change in ownership of the site. This permit is subject to compliance with the provisions of the Laws and Rules for Sewage Treatment and Disposal and to conditions of this permit.

Construction Authorization

(Required for Building Permit)

The construction and installation requirements of Rules .1950, .1952, .1954, .1955, .1956, .1957, .1958, and .1959 are incorporated by references into this permit and shall be met. Systems shall be installed in accordance with the attached system layout.

ISSUED TO: Kenneth Cummings PROPERTY LOCATION: 1125
 Facility Type: SFD - 25x61 New Expansion Repair
 Basement? Yes No Basement Fixtures? Yes No
 Type of Wastewater System** 25% Reduction System (Initial) Wastewater Flow: 360 GPD
 (See note below, if applicable
100' of Panel Block (Repair)
 Installation Requirements/Conditions
 Septic Tank Size 1000 gallons Number of trenches 1
 Pump Tank Size _____ gallons Exact length of each trench 150 feet Trench Spacing: 9 Feet on Center
 Trenches shall be installed on contour at a _____ inches Soil Cover: 6 inches
 Maximum Trench Depth of: 12 to 18 inches (Maximum soil cover shall not exceed
 (Trench bottoms shall be level to +/- 1/4" 36" above the trench bottom)
 in all directions)
 Pump Requirements: _____ ft. TDH vs. _____ GPM _____ inches below pipe
 Aggregate Depth: _____ inches above pipe
 Conditions: _____ inches total

**If applicable: I understand the system type specified is different from the type specified on the application. I accept the specifications of this permit.

Owner/Legal Representative Signature: _____ Date: _____

This Construction Authorization is subject to revocation if the site plan, plat, or the intended use changes. The Construction Authorization shall not be transferred when there is a change in ownership of the site. This Construction Authorization is subject to compliance with the provisions of the Laws and Rules for Sewage Treatment and Disposal and to the conditions of this permit. SEE ATTACHED SITE SKETCH

Authorized State Agent: J. Waters Date: 5-27-08
 Construction Authorization Expiration Date: 5-27-2013

HTE# 08.500-19982

Permit # 24792

Harnett County Department of Public Health Site Sketch

ISSUED TO: Kenneth Cummins PROPERTY LOCATOR: 1125
SUBDIVISION: Woodshire LOT # 218

Authorized State Agent: J. L. [Signature] Date: 05 27 08

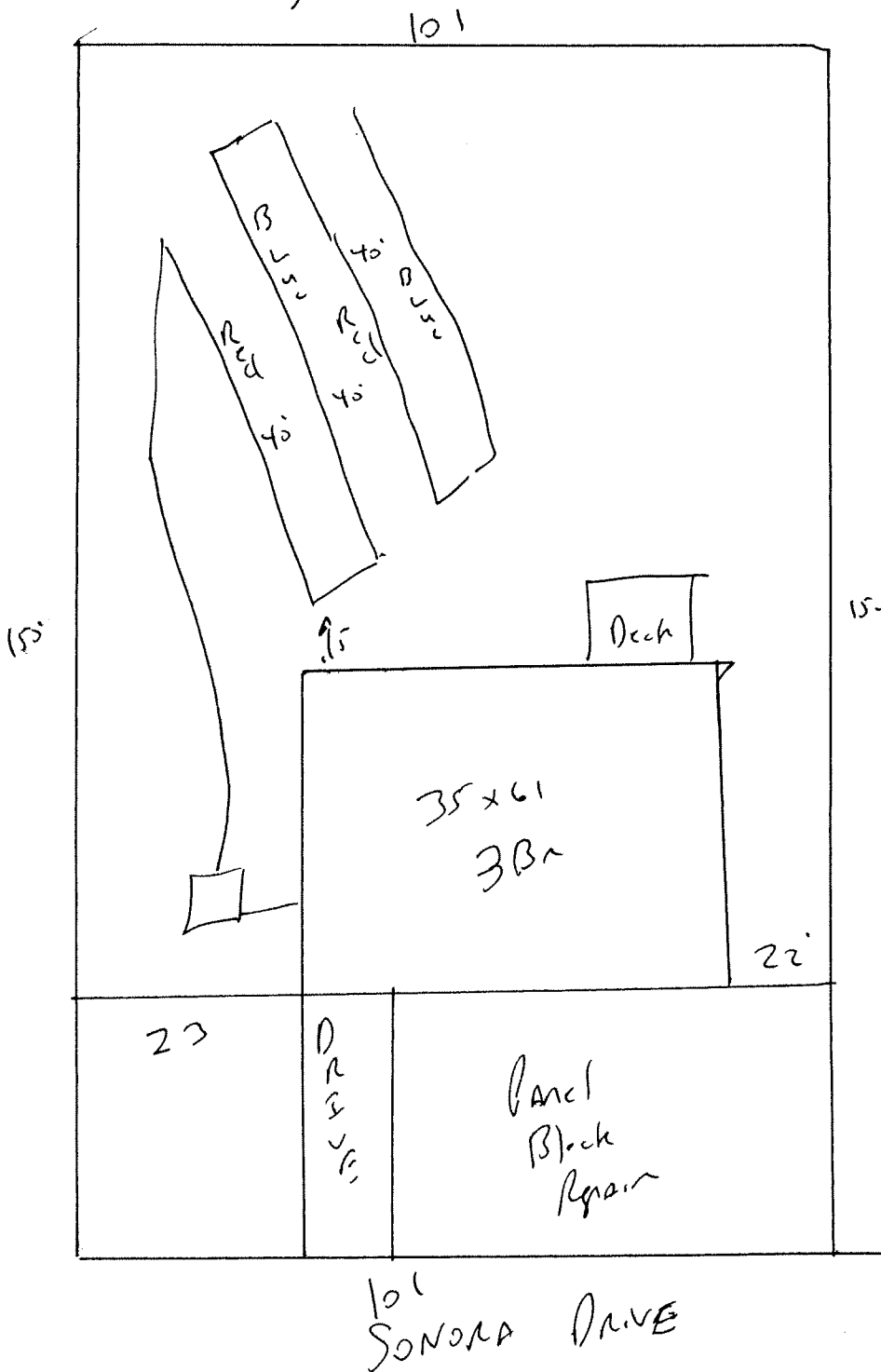

STAB out Plumbing
shallow, at ground
level or higher where
shown

Meet onsite
maintain all
set back

18" max. ditch
Depth

Install ~~150'~~
25% Reduction system
at 18" max ditch
Depth