

HTE# 08-50019882R

Harnett County Department of Public Health

24898

Improvement Permit

A building permit cannot be issued with only an Improvement Permit

ISSUED TO: STANCI Builders
PROPERTY LOCATION: Tinjen Rd
SUBDIVISION: Pattoni Pant
LOT # 154
Type of Structure: SFD- 40x60- 3BR
Proposed Wastewater System Type: 25% Reduction system
Projected Daily Flow: 360 GPD
Number of bedrooms: 3 Number of Occupants: 6 max
Basement: No
Pump Required: No
Type of Water Supply: Public
Permit conditions: Meet on site for final layout - STUB out plumbing shallow at ground level or higher where shown - maintain all set backs
Authorized State Agent: J. Lan Date: 08-05-08 SEE ATTACHED SITE SKETCH

Construction Authorization

(Required for Building Permit)

The construction and installation requirements of Rules .1950, .1952, .1954, .1955, .1956, .1957, .1958, and .1959 are incorporated by references into this permit and shall be met.

ISSUED TO: STANCI Builders
PROPERTY LOCATION: Tinjen Rd
SUBDIVISION: Pattoni Pant
LOT # 154
Facility Type: SFD 40x60- 3BR New
Basement? No
Type of Wastewater System: 25% Reduction system
(Initial) Wastewater Flow: 360 GPD
(See note below, if applicable) Panel Blocks (Repair)

Installation Requirements/Conditions

Septic Tank Size 1000 gallons
Pump Tank Size
Number of trenches 1
Exact length of each trench 150 feet
Trench Spacing: 9 Feet on Center
Soil Cover: 6 inches
Maximum Trench Depth of: 18.24 inches
Pump Requirements: ft. TDH vs. GPM
Aggregate Depth: inches below pipe, inches above pipe, inches total

**If applicable: I understand the system type specified is different from the type specified on the application. I accept the specifications of this permit.

Owner/Legal Representative Signature: Date:

This Construction Authorization is subject to revocation if the site plan, plat, or the intended use changes. The Construction Authorization shall not be transferred when there is a change in ownership of the site. This Construction Authorization is subject to compliance with the provisions of the Laws and Rules for Sewage Treatment and Disposal and to the conditions of this permit. SEE ATTACHED SITE SKETCH

Authorized State Agent: J. Lan Date: 08-05-08
Construction Authorization Expiration Date: 08-05-2013

HTE# 08 500-1988 2R

Permit # 24898

Harnett County Department of Public Health Site Sketch

ISSUED TO: Steel Builders

PROPERTY LOCATOR: Troyer Rd

SUBDIVISION: Patterson Point

LOT # 154

Authorized State Agent: J. L. [Signature]

Date: 08-05-08

True Blue

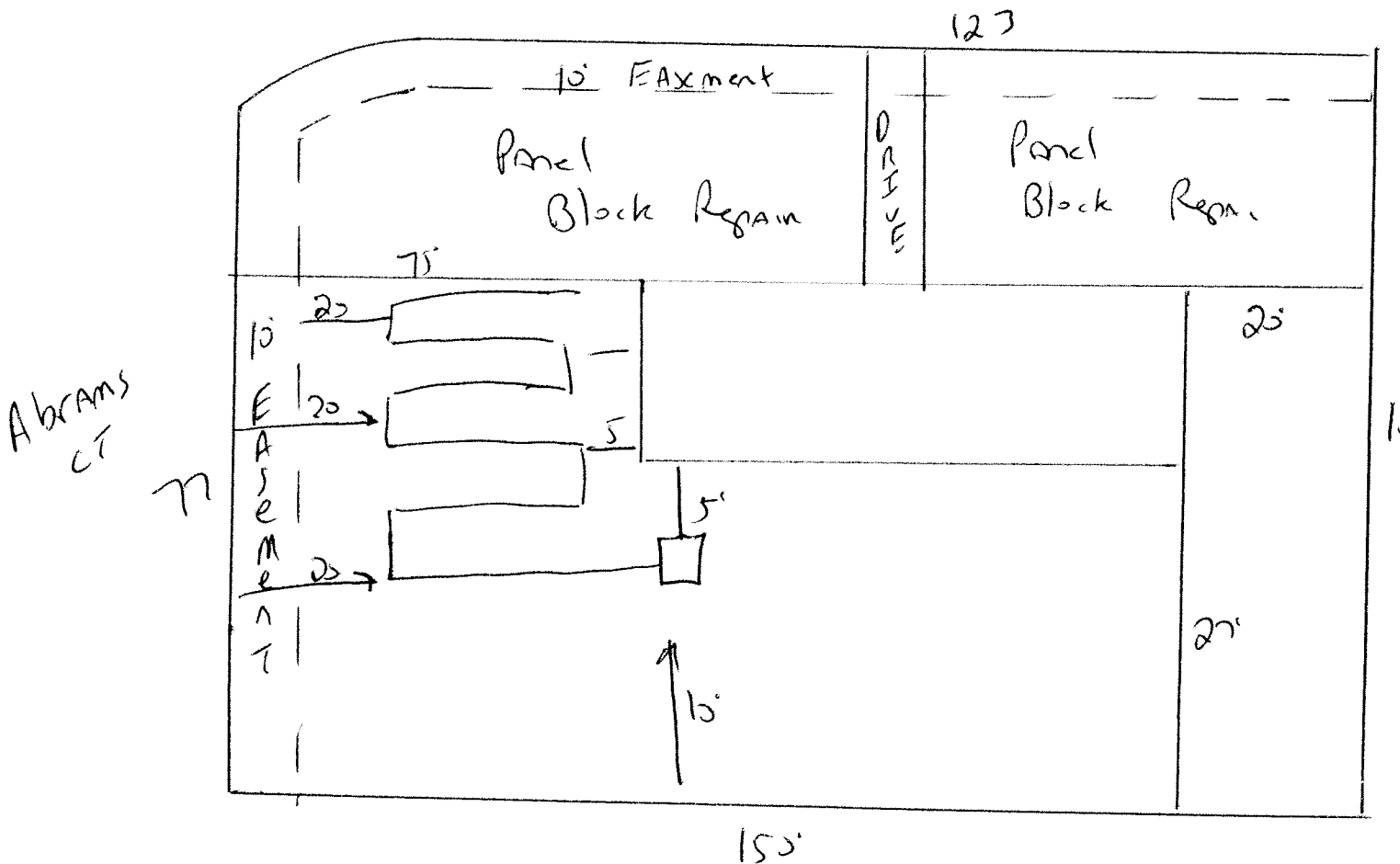

Meet onsite for Final Layout maintain All set Backs
 install 150' of 25% Reduction system at 18"-24" Deep
 stub out Plumbing shallow, at ground level or higher
 where shown
 Do not drive or Park on any part of septic system