

SCANNED  
4-27-08  
DATE

Initial Application Date: ~~4-16-08~~  
5-5-08

Application # 085-0019879R

COUNTY OF HARNETT LAND USE APPLICATION  
Central Permitting 108 E. Front Street, Lillington, NC 27546 Phone: (910) 893-7525 Fax: (910) 893-2793 www.harnett.org

LANDOWNER: Stancil Builders, Inc. Mailing Address: 4666 Stancil Road  
City: Angier State: NC Zip: 27501 Home #: 639-2073 Contact #: 639-2073

APPLICANT: Stancil Builders, Inc. Mailing Address: 4666 Stancil Road  
City: Angier State: NC Zip: 27501 Home #: 639-2073 Contact #: 639-2073  
\*Please fill out applicant information if different than landowner

PROPERTY LOCATION: State Road #: 1141 State Road Name: Micro Tower Road  
Parcel: 039597 0225 04 PIN: 9597-40-8981.000

Zoning: BA-202 Subdivision: Patterson Point II Lot #: 122 Lot Size: 1.347 acre  
Flood Plain: X Panel: N/A Watershed: N/A Deed Book/Page: 22711860 Plat Book/Page: 20081148

SPECIFIC DIRECTIONS TO THE PROPERTY FROM LILLINGTON: US 401, right on Hwy 27, left on  
DOC's rd., right on Micro Tower Rd, sitd on right

- PROPOSED USE:
- SFD (Size 40 x 100) # Bedrooms 3 # Baths 2 Basement (w/wo bath) \_\_\_\_\_ Garage  Deck  Crawl Space/ Slab
  - Modular: \_\_\_ On frame \_\_\_ Off frame (Size \_\_\_ x \_\_\_) # Bedrooms \_\_\_ # Baths \_\_\_ Garage \_\_\_ (site built? \_\_\_) Deck \_\_\_ (site built? \_\_\_)
  - Multi-Family Dwelling No. Units \_\_\_\_\_ No. Bedrooms/Unit \_\_\_\_\_
  - Manufactured Home: \_\_\_ SW \_\_\_ DW \_\_\_ TW (Size \_\_\_ x \_\_\_) # Bedrooms \_\_\_ Garage \_\_\_ (site built? \_\_\_) Deck \_\_\_ (site built? \_\_\_)
  - Business Sq. Ft. Retail Space \_\_\_\_\_ Type \_\_\_\_\_ # Employees: \_\_\_\_\_ Hours of Operation: \_\_\_\_\_
  - Industry Sq. Ft. \_\_\_\_\_ Type \_\_\_\_\_ # Employees: \_\_\_\_\_ Hours of Operation: \_\_\_\_\_
  - Church Seating Capacity \_\_\_\_\_ # Bathrooms \_\_\_\_\_ Kitchen \_\_\_\_\_
  - Home Occupation (Size \_\_\_ x \_\_\_) # Rooms \_\_\_\_\_ Use \_\_\_\_\_ Hours of Operation: \_\_\_\_\_
  - Accessory/Other (Size \_\_\_ x \_\_\_) Use \_\_\_\_\_
  - Addition to Existing Building (Size \_\_\_ x \_\_\_) Use \_\_\_\_\_ Closets in addition (\_\_\_)yes (\_\_\_)no

Water Supply:  County (\_\_\_) Well (No. dwellings \_\_\_) (\_\_\_) Other  
Sewage Supply:  New Septic Tank (Need to fill out New Tank Checklist) (\_\_\_) Existing Septic Tank (\_\_\_) County Sewer (\_\_\_) Other  
Property owner of this tract of land own land that contains a manufactured home w/in five hundred feet (500') of tract listed above? (\_\_\_)YES NO

Structures on this tract of land: Single family dwellings 1 prop Manufactured Homes \_\_\_\_\_ Other (specify) \_\_\_\_\_

Required Residential Property Line Setbacks:		Comments:
Front	Minimum <u>35</u> Actual <u>50</u>	<u>R 5-5-08 Move house VCB</u> <u>Conf # 090252</u>
Rear	<u>25</u> <del>155</del> <u>60</u>	
Side	<u>10</u> <del>45</del> <u>20</u>	
Corner/Sidestreet	<u>20</u>	
Nearest Building on same lot	<u>10</u> <u>NIA</u>	

If permits are granted I agree to conform to all ordinances and the laws of the State of North Carolina regulating such work and the specifications of plans submitted. I hereby state that the foregoing statements are accurate and correct to the best of my knowledge. This permit is subject to revocation if false information is provided on this form.

Brenda Salduter V.P.  
Signature of Owner or Owner's Agent

4-16-08  
Date

\*\*This application expires 6 months from the initial date if no permits have been issued\*\*

A RECORDED SURVEY MAP, RECORDED DEED (OR OFFER TO PURCHASE) AND PLAT ARE REQUIRED WHEN APPLYING FOR LAND USE APPLICATION

Please use Blue or Black Ink ONLY

~~0850019879R~~

1" = 50'

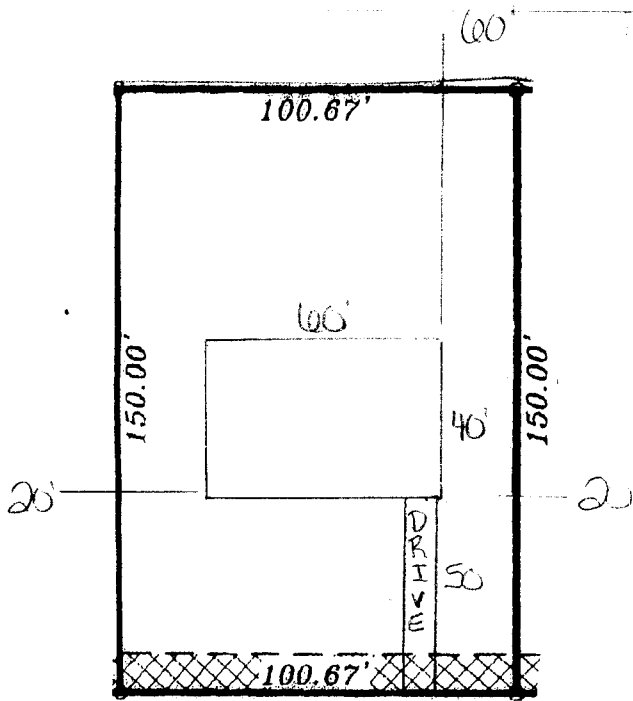

True Blue Dr.

Revised 5-2-08

Lot 122 Patton's Point II

102 True Blue Dr.

#08-50019879

SITE PLAN APPROVAL  
DISTRICT RA 20B USE SFP  
#BEDROOMS 3  
5-5-08 V.C. Brown  
Date Zoning Administrator