

SCANNED  
4-11-08  
DATE

Initial Application Date: ~~4-16-08~~  
5-5-08

Application # 0850019877R

COUNTY OF HARNETT LAND USE APPLICATION  
Central Permitting 108 E. Front Street, Lillington, NC 27546 Phone: (910) 893-7525 Fax: (910) 893-2793 www.harnett.org

LANDOWNER: Stancel Builders, Inc. Mailing Address: 4666 Stancel Road  
City: Angier State: NC Zip: 27501 Home #: 639-2073 Contact #: 639-2073

APPLICANT: Stancel Builders, Inc. Mailing Address: 4666 Stancel Rd.  
City: Angier State: NC Zip: 27501 Home #: 639-2073 Contact #: 639-2073  
\*Please fill out applicant information if different than landowner

PROPERTY LOCATION: State Road #: 1141 State Road Name: Micro Tower Rd.  
Parcel: 039597 0225 02 PIN: 9597-40-8981.000

Zoning: BA-202 Subdivision: Patton's Point II Lot #: 120 Lot Size: .347 acre  
Flood Plain: X Panel: N/A Watershed: N/A Deed Book/Page: 2271/816W Plat Book/Page: 2009/1148

SPECIFIC DIRECTIONS TO THE PROPERTY FROM LILLINGTON: US 401, right on Hwy 27, left on  
Doc's Rd, right on Micro Tower Rd, SD on right

PROPOSED USE:

- SFD (Size 40 x 100) # Bedrooms 3 # Baths 2 Basement (w/wo bath) \_\_\_\_\_ Garage  Deck  Crawl Space Slab
- Modular: \_\_\_ On frame \_\_\_ Off frame (Size \_\_\_ x \_\_\_) # Bedrooms \_\_\_ # Baths \_\_\_ Garage \_\_\_ (site built? \_\_\_) Deck \_\_\_ (site built? \_\_\_)
- Multi-Family Dwelling No. Units \_\_\_\_\_ No. Bedrooms/Unit \_\_\_\_\_
- Manufactured Home: \_\_\_ SW \_\_\_ DW \_\_\_ TW (Size \_\_\_ x \_\_\_) # Bedrooms \_\_\_ Garage \_\_\_ (site built? \_\_\_) Deck \_\_\_ (site built? \_\_\_)
- Business Sq. Ft. Retail Space \_\_\_\_\_ Type \_\_\_\_\_ # Employees: \_\_\_\_\_ Hours of Operation: \_\_\_\_\_
- Industry Sq. Ft. \_\_\_\_\_ Type \_\_\_\_\_ # Employees: \_\_\_\_\_ Hours of Operation: \_\_\_\_\_
- Church Seating Capacity \_\_\_\_\_ # Bathrooms \_\_\_\_\_ Kitchen \_\_\_\_\_
- Home Occupation (Size \_\_\_ x \_\_\_) # Rooms \_\_\_\_\_ Use \_\_\_\_\_ Hours of Operation: \_\_\_\_\_
- Accessory/Other (Size \_\_\_ x \_\_\_) Use \_\_\_\_\_
- Addition to Existing Building (Size \_\_\_ x \_\_\_) Use \_\_\_\_\_ Closets in addition ( ) yes ( ) no

Water Supply:  County ( ) Well (No. dwellings \_\_\_) ( ) Other

Sewage Supply:  New Septic Tank (Need to fill out New Tank Checklist) ( ) Existing Septic Tank ( ) County Sewer ( ) Other

Property owner of this tract of land own land that contains a manufactured home w/in five hundred feet (500') of tract listed above? ( ) YES  NO

Structures on this tract of land: Single family dwellings 1 proposed Manufactured Homes \_\_\_\_\_ Other (specify) \_\_\_\_\_

Required Residential Property Line Setbacks:			Comments:
Front	Minimum <u>35</u>	Actual <u>50</u>	<u>R 5-5-08 Move house VCB</u> <u>Conf # 090250</u>
Rear	<u>25</u>	<u>157 65</u>	
Side	<u>10</u>	<u>35 20</u>	
Corner/Sidestreet	<u>20</u>		
Nearest Building on same lot	<u>10</u>	<u>NIA</u>	

If permits are granted I agree to conform to all ordinances and the laws of the State of North Carolina regulating such work and the specifications of plans submitted. I hereby state that the foregoing statements are accurate and correct to the best of my knowledge. This permit is subject to revocation if false information is provided on this form.

Dorinda Saldator V.P.  
Signature of Owner or Owner's Agent

4-16-08  
Date

**\*\*This application expires 6 months from the initial date if no permits have been issued\*\***

A RECORDED SURVEY MAP, RECORDED DEED (OR OFFER TO PURCHASE) AND PLAT ARE REQUIRED WHEN APPLYING FOR LAND USE APPLICATION

Please use Blue or Black Ink ONLY

085 or 19877 R

1" = 50'

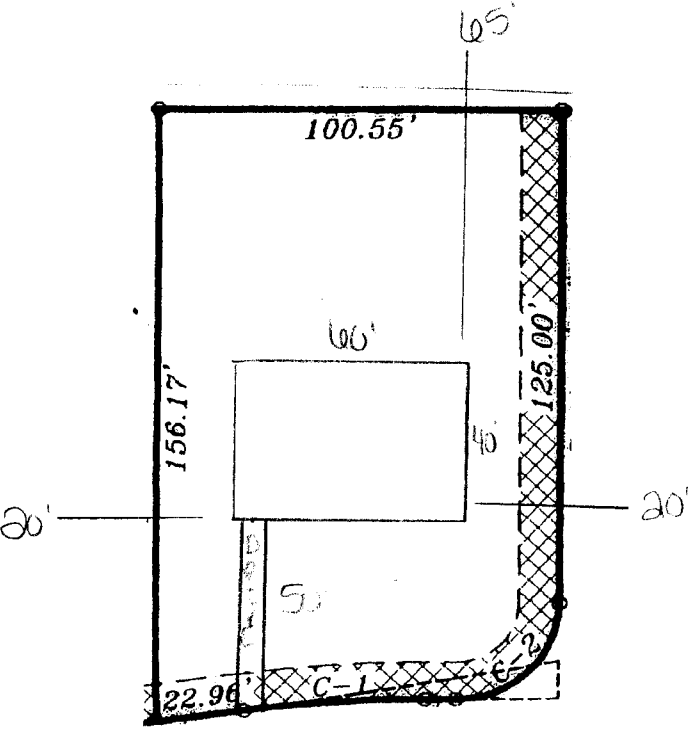

True Blue Dr.

Revised 5-2-08

Lot 120 Patten's Point II

150 True Blue Dr.

# 08-50019877

SITE PLAN APPROVAL

DISTRICT RA 20B USE SFD

#BEDROOMS 3

Date 5-5-08

T. C. [Signature]  
Zoning Administrator

Date