

SOUTHEASTEN SOIL & ENVIRONMENTAL ASSOC, INC.

PROPOSED SUBSURFACE WASTE DISPOSAL SYSTEM DETAIL SHEET

SUBDIVISION *Persimmon Hill*

LOT *43*

INITIAL SYSTEM *PPBPi*

REPAIR *LPP*

DISTRIBUTION *D-box*

DISTRIBUTION *MANIFOLD*

BENCHMARK *190.0*

LOCATION

NO. BEDROOMS *4*

<u>LINE</u>	<u>FLAG COLOR</u>	<u>ELEVATION</u>	<u>ACTUAL LENGTH</u>
<i>1 A+B</i>	<i>B</i>	<i>103.42</i>	<i>100' (2-50' segments)</i>
<i>2 A+B</i>	<i>R</i>	<i>103.33</i>	<i>100' (2-50' segments)</i>
<i>4 @ 50' segments of Panel Block</i>			

BY *M EAKER*

DATE *04/20/08*

Southeastern Soil & Environmental Associates, Inc.

P.O. Box 9321
Fayetteville, NC 28311
Phone/Fax (910) 822-4540

Persimmon Hill

Lot 43

PROPOSED SEPTIC LAYOUT

200' PANEL BLOCK (initial)

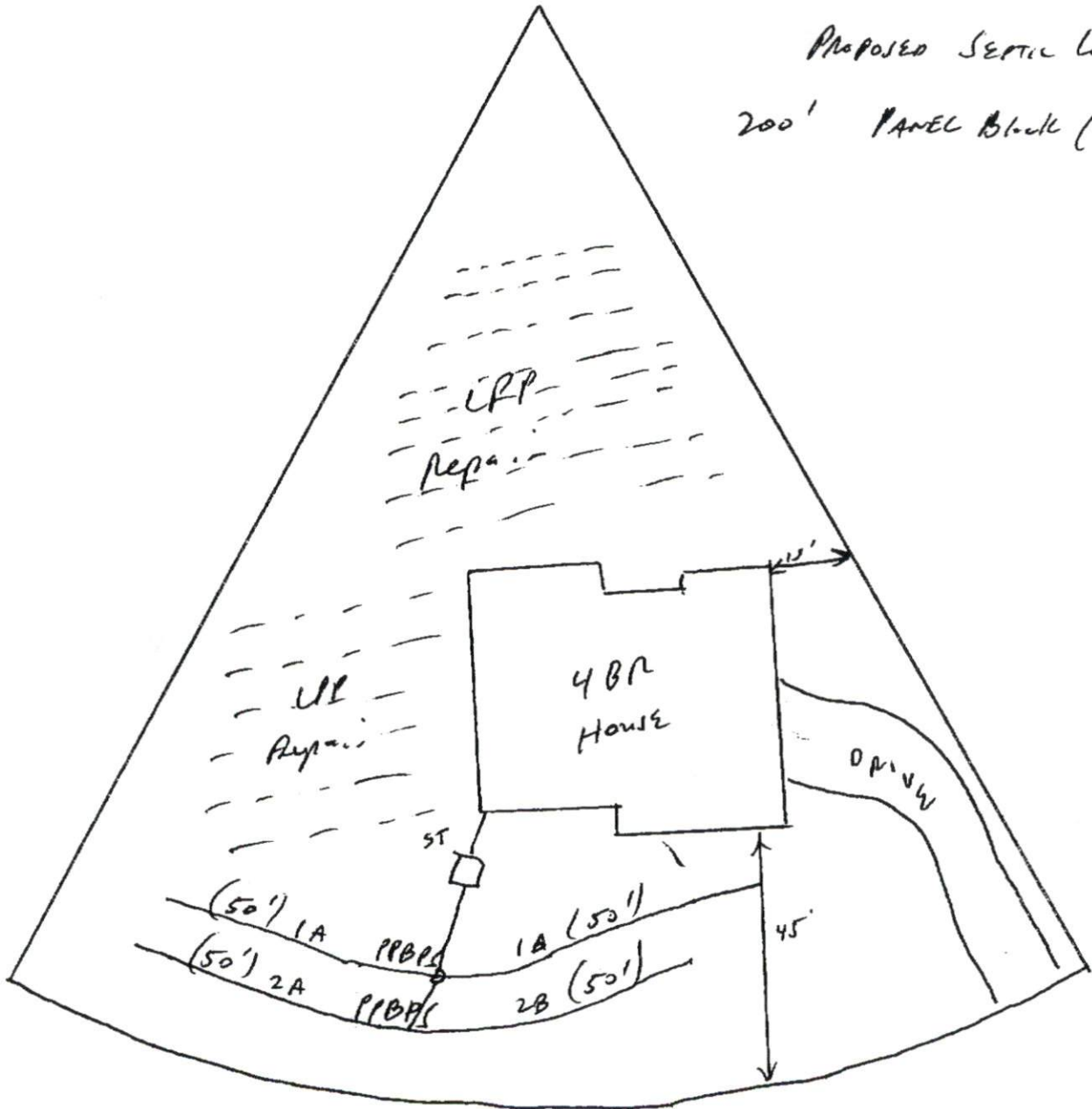

SOUTHEASTEN SOIL & ENVIRONMENTAL ASSOC, INC.

PROPOSED SUBSURFACE WASTE DISPOSAL SYSTEM DETAIL SHEET

For: *Alm. Kent PERIS, INC.*

SUBDIVISION *Perisimus Hill* LOT *43*
INITIAL SYSTEM *PPBS* REPAIR *CPP*
DISTRIBUTION *D-box* DISTRIBUTION *MAN. POLD*
BENCHMARK *190.0* LOCATION _____
NO. BEDROOMS *4*

LINE FLAG COLOR ELEVATION ACTUAL LENGTH

1A-B *B* *103.42* *100' (2-50' segments)*
2A-B *P* *103.33* *100' (2-50' segments)*

4 @ 50 segments of Panel Block

BY *M. KAKER* DATE *04/20/02*