

Improvement Permit

A building permit cannot be issued with only an Improvement Permit

ISSUED TO: Wynn Const. PROPERTY LOCATION: NC 27
NEW REPAIR 4x38 EXPANSION SUBDIVISION Tingen Point LOT # 27

Type of Structure: SFD- 60x60- 4BR Site Improvements required prior to Construction Authorization Issuance:
Proposed Wastewater System Type: 25% Reduction system
Projected Daily Flow: 480 GPD
Number of bedrooms: 4 Number of Occupants: 8 max
Basement Yes No

Pump Required: Yes No May be required based on final location and elevations of facilities
Type of Water Supply: Community Public Well Distance from well 50 feet Permit valid for: Five years
Permit conditions: STUB out Plumbing shallow, at ground level or higher where shown. Meet onsite. Maintain all setbacks. Keep septic system 25' from Rear Property Line No expiration

Authorized State Agent: J. Waters Date: 05-22-08 SEE ATTACHED SITE SKETCH

The issuance of this permit by the Health Department in no way guarantees the issuance of other permits. The permit holder is responsible for checking with appropriate governing bodies in meeting their requirements. This site is subject to revocation if the site plan, plat, or the intended use changes. The Improvement Permit shall not be affected by a change in ownership of the site. This permit is subject to compliance with the provisions of the Laws and Rules for Sewage Treatment and Disposal and to conditions of this permit.

Construction Authorization

(Required for Building Permit)

The construction and installation requirements of Rules .1950, .1952, .1954, .1955, .1956, .1957, .1958, and .1959 are incorporated by references into this permit and shall be met. Systems shall be installed in accordance with the attached system layout.

ISSUED TO: Wynn Const. PROPERTY LOCATION: NC 27
Facility Type: SFD- 60x60- 4BR New Expansion Repair
Basement? Yes No Basement Fixtures? Yes No

Type of Wastewater System** 25% Reduction system (Initial) Wastewater Flow: 480 GPD
(See note below, if applicable 135' of Panel Block (Repair))

Installation Requirements/Conditions
Septic Tank Size 1000 gallons Number of trenches 1
Pump Tank Size _____ gallons Exact length of each trench 200 feet Trench Spacing: 9 Feet on Center
Trenches shall be installed on contour at a Soil Cover: 6 inches
Maximum Trench Depth of: 18.24 inches (Maximum soil cover shall not exceed 36" above the trench bottom)
(Trench bottoms shall be level to +/-1/4" in all directions)

Pump Requirements: _____ ft. TDH vs. _____ GPM _____ inches below pipe
Aggregate Depth: _____ inches above pipe
Conditions: _____ inches total

**If applicable: I understand the system type specified is different from the type specified on the application. I accept the specifications of this permit.

Owner/Legal Representative Signature: _____ Date: _____

This Construction Authorization is subject to revocation if the site plan, plat, or the intended use changes. The Construction Authorization shall not be transferred when there is a change in ownership of the site. This Construction Authorization is subject to compliance with the provisions of the Laws and Rules for Sewage Treatment and Disposal and to the conditions of this permit. SEE ATTACHED SITE SKETCH

Authorized State Agent: J. Waters Date: 05-22-08
Construction Authorization Expiration Date: 05-22-2013

HTE# 08-500-19801 RR

Permit # 24790

Harnett County Department of Public Health Site Sketch

ISSUED TO: Wynn Const.

PROPERTY LOCATOR: NC 27

SUBDIVISION Tingen Point

LOT # 27

Authorized State Agent: Joe Letts

Date: 05-22-08

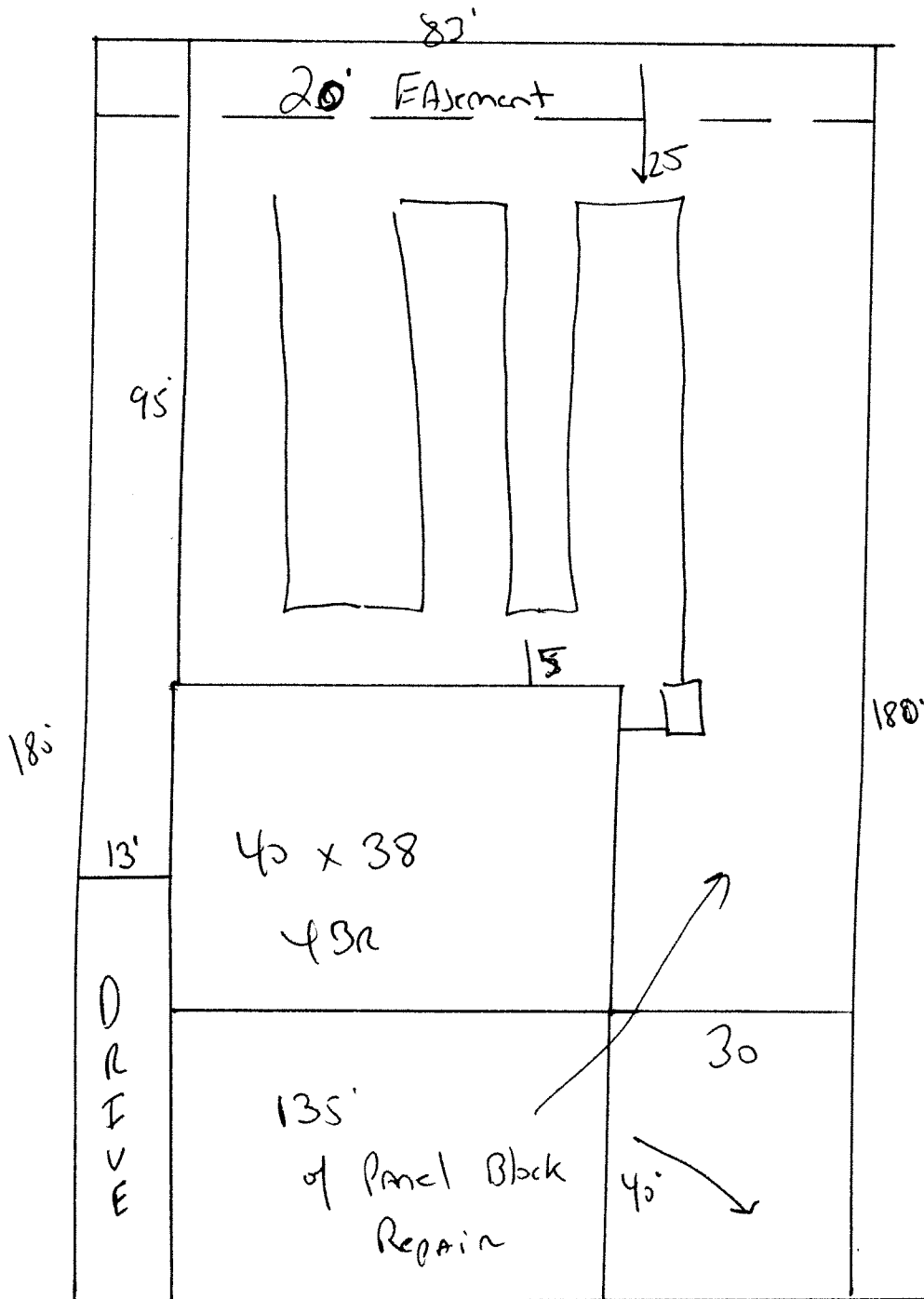

STUB out Plumbing
Shallow AT ground
level or higher where
shown.

meet onsite
MAINTAIN ALL Jet BACKS
keep septic system
25' from Rear property
line

Install 200' of 25%
Reduction system

Repair is 135' of
Panel Block

Omaha Dr 83