

### Improvement Permit

A building permit cannot be issued with only an Improvement Permit

ISSUED TO: Wyan Const. PROPERTY LOCATION: NC 27  
 SUBDIVISION: Tingen Point LOT # 24  
 NEW  REPAIR  EXPANSION   
 Type of Structure: SFD - 49x50 - 3BR  
 Proposed Wastewater System Type: Pump To 25% Reduction system  
 Projected Daily Flow: 360 GPD  
 Number of bedrooms: 3 Number of Occupants: 6 max  
 Basement  Yes  No  
 Pump Required:  Yes  No  May be required based on final location and elevations of facilities  
 Type of Water Supply:  Community  Public  Well Distance from well 50 feet Permit valid for:  Five years  
 Permit conditions: Meet onsite for final layout maintain all set backs  No expiration  
Sub out Plumbing shallow, at ground level or higher where shown and  
Pump may not be required  
 Authorized State Agent: Jan WARS Date: 5.22.08 SEE ATTACHED SITE SKETCH

The issuance of this permit by the Health Department in no way guarantees the issuance of other permits. The permit holder is responsible for checking with appropriate governing bodies in meeting their requirements. This site is subject to revocation if the site plan, plat, or the intended use changes. The Improvement Permit shall not be affected by a change in ownership of the site. This permit is subject to compliance with the provisions of the Laws and Rules for Sewage Treatment and Disposal and to conditions of this permit.

### Construction Authorization

(Required for Building Permit)

The construction and installation requirements of Rules .1950, .1952, .1954, .1955, .1956, .1957, .1958, and .1959 are incorporated by references into this permit and shall be met. Systems shall be installed in accordance with the attached system layout.

ISSUED TO: Wyan Const. PROPERTY LOCATION: NC 27  
 SUBDIVISION: Tingen Point LOT # 24  
 Facility Type: SFD - 49x50 - 3BR  New  Expansion  Repair  
 Basement?  Yes  No Basement Fixtures?  Yes  No  
 Type of Wastewater System\*\* Pump to 25% Reduction system (Initial) Wastewater Flow: 360 GPD  
 (See note below, if applicable  25% Reduction system (Repair))

**Installation Requirements/Conditions**

Septic Tank Size <u>1000</u> gallons	Number of trenches <u>1</u>	Exact length of each trench <u>150</u> feet	Trench Spacing: <u>9</u> Feet on Center
Pump Tank Size <u>1000</u> gallons	Trenches shall be installed on contour at a	Maximum Trench Depth of: <u>18</u> inches	Soil Cover: <u>6</u> inches
	(Trench bottoms shall be level to +/-1/4"	in all directions)	(Maximum soil cover shall not exceed 36" above the trench bottom)

Pump Requirements: \_\_\_\_\_ ft. TDH vs. \_\_\_\_\_ GPM  
 Aggregate Depth: \_\_\_\_\_ inches below pipe  
 \_\_\_\_\_ inches above pipe  
 \_\_\_\_\_ inches total

Conditions: \_\_\_\_\_

\*\*If applicable: I understand the system type specified is different from the type specified on the application. I accept the specifications of this permit.

Owner/Legal Representative Signature: \_\_\_\_\_ Date: \_\_\_\_\_

This Construction Authorization is subject to revocation if the site plan, plat, or the intended use changes. The Construction Authorization shall not be transferred when there is a change in ownership of the site. This Construction Authorization is subject to compliance with the provisions of the Laws and Rules for Sewage Treatment and Disposal and to the conditions of this permit. SEE ATTACHED SITE SKETCH

Authorized State Agent: Jan WARS Date: 05.22.08  
 Construction Authorization Expiration Date: 05.22.2013

HTE# 08-500-19799R

Permit # 24787

# Harnett County Department of Public Health Site Sketch

ISSUED TO: Wynn Const. PROPERTY LOCATOR: Nc 27  
 SUBDIVISION: Tingen Point LOT # 24  
 Authorized State Agent: Joe West R Date: 05-22-08

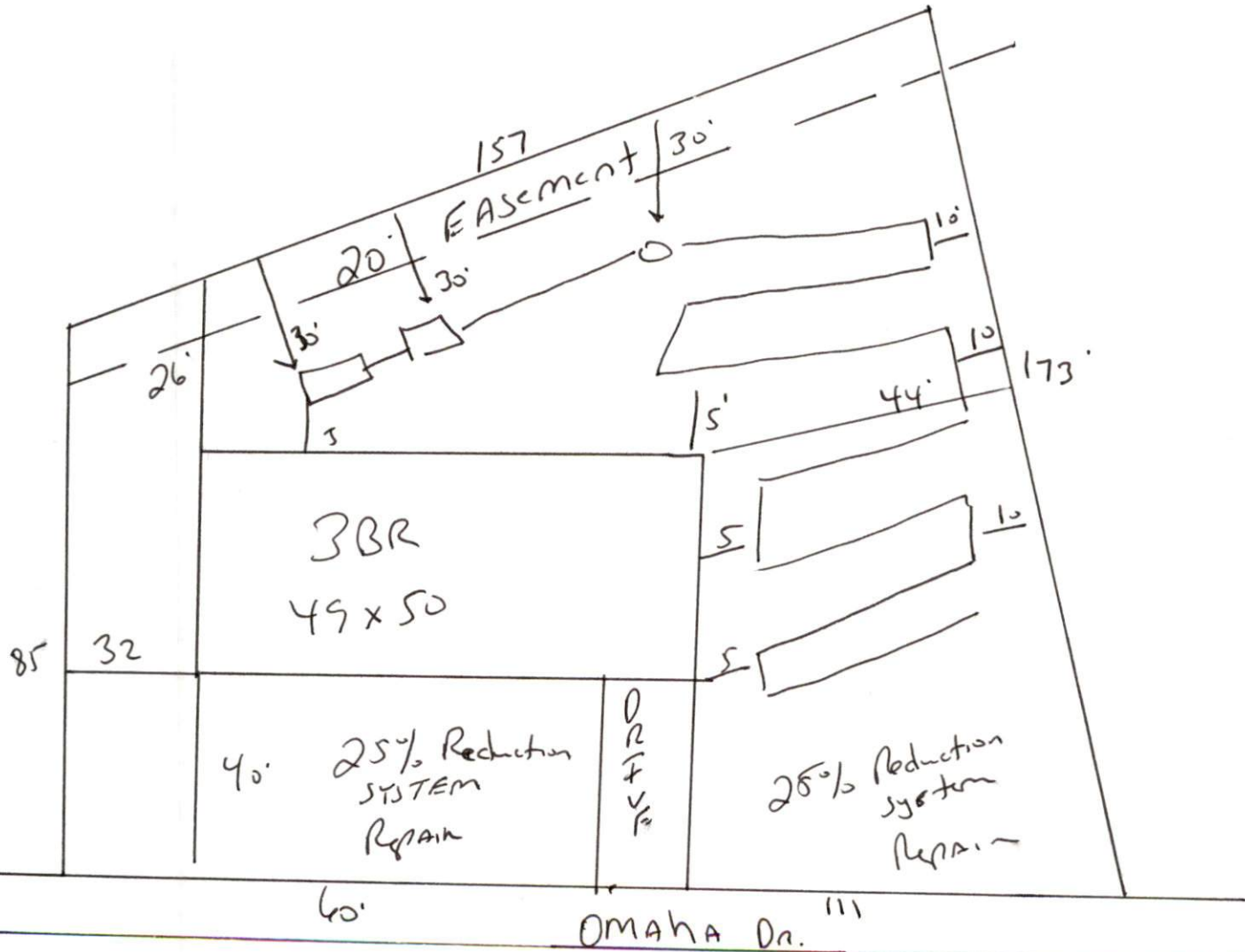

STUB out Plumbing shallow AT ground level or higher  
 Where shown. Pump may not be Required. Meet onsite  
 MAINTAIN ALL Set Backs keep septic system 30' from Rear  
 Property Line