

HTE# 08-500-19794R

Harnett County Department of Public Health

24856

Improvement Permit

A building permit cannot be issued with only an Improvement Permit

ISSUED TO: Wynn Const. PROPERTY LOCATION: NC27 SUBDIVISION: Tinsan Point LOT # 10
NEW REPAIR EXPANSION
Type of Structure: SFD-42x41 JDA
Proposed Wastewater System Type: Pump to 25% Reduction syst
Projected Daily Flow: 360 GPD
Number of bedrooms: 3 Number of Occupants: 6 max
Basement No
Pump Required: Yes
Type of Water Supply: Public
Permit conditions: Meet on site maintain all jet wash
Permit valid for: Five years

Authorized State Agent: J. Lars Date: 060608 SEE ATTACHED SITE SKETCH
The issuance of this permit by the Health Department in no way guarantees the issuance of other permits. The permit holder is responsible for checking with appropriate governing bodies in meeting their requirements. This site is subject to revocation if the site plan, plat, or the intended use changes. The Improvement Permit shall not be affected by a change in ownership of the site. This permit is subject to compliance with the provisions of the Laws and Rules for Sewage Treatment and Disposal and to conditions of this permit.

Construction Authorization

(Required for Building Permit)

The construction and installation requirements of Rules .1950, .1952, .1954, .1955, .1956, .1957, .1958, and .1959 are incorporated by references into this permit and shall be met. Systems shall be installed in accordance with the attached system layout.

ISSUED TO: Wynn Const. PROPERTY LOCATION: NC27 SUBDIVISION: Tinsan Point LOT # 10
Facility Type: SFD-42x41-JDA New
Basement? No
Type of Wastewater System: Pump to 25% Reduction (Initial) Wastewater Flow: 360 GPD
(See note below, if applicable) On p (Repair)

Installation Requirements/Conditions
Septic Tank Size 1000 gallons
Pump Tank Size 1000 gallons
Number of trenches 1
Exact length of each trench 270 feet
Trench Spacing: 9 Feet on Center
Soil Cover: 6 inches
Maximum Trench Depth of: 18 inches
(Trench bottoms shall be level to +/-1/4" in all directions)
(Pump Requirements: \_\_\_\_\_ ft. TDH vs. \_\_\_\_\_ GPM)
Aggregate Depth: \_\_\_\_\_ inches below pipe \_\_\_\_\_ inches above pipe \_\_\_\_\_ inches total

\*\*If applicable: I understand the system type specified is different from the type specified on the application. I accept the specifications of this permit.

Owner/Legal Representative Signature: \_\_\_\_\_ Date: \_\_\_\_\_

This Construction Authorization is subject to revocation if the site plan, plat, or the intended use changes. The Construction Authorization shall not be transferred when there is a change in ownership of the site. This Construction Authorization is subject to compliance with the provisions of the Laws and Rules for Sewage Treatment and Disposal and to the conditions of this permit. SEE ATTACHED SITE SKETCH

Authorized State Agent: J. Lars Date: 060608
Construction Authorization Expiration Date: 06062013

HTE# 0850019794R

Permit # 24856

# Harnett County Department of Public Health Site Sketch

ISSUED TO: Wynn Const.

PROPERTY LOCATOR: NC 27

SUBDIVISION: TINJEN POINT

LOT # 10

Authorized State Agent: J. L. Sword

Date: 060608

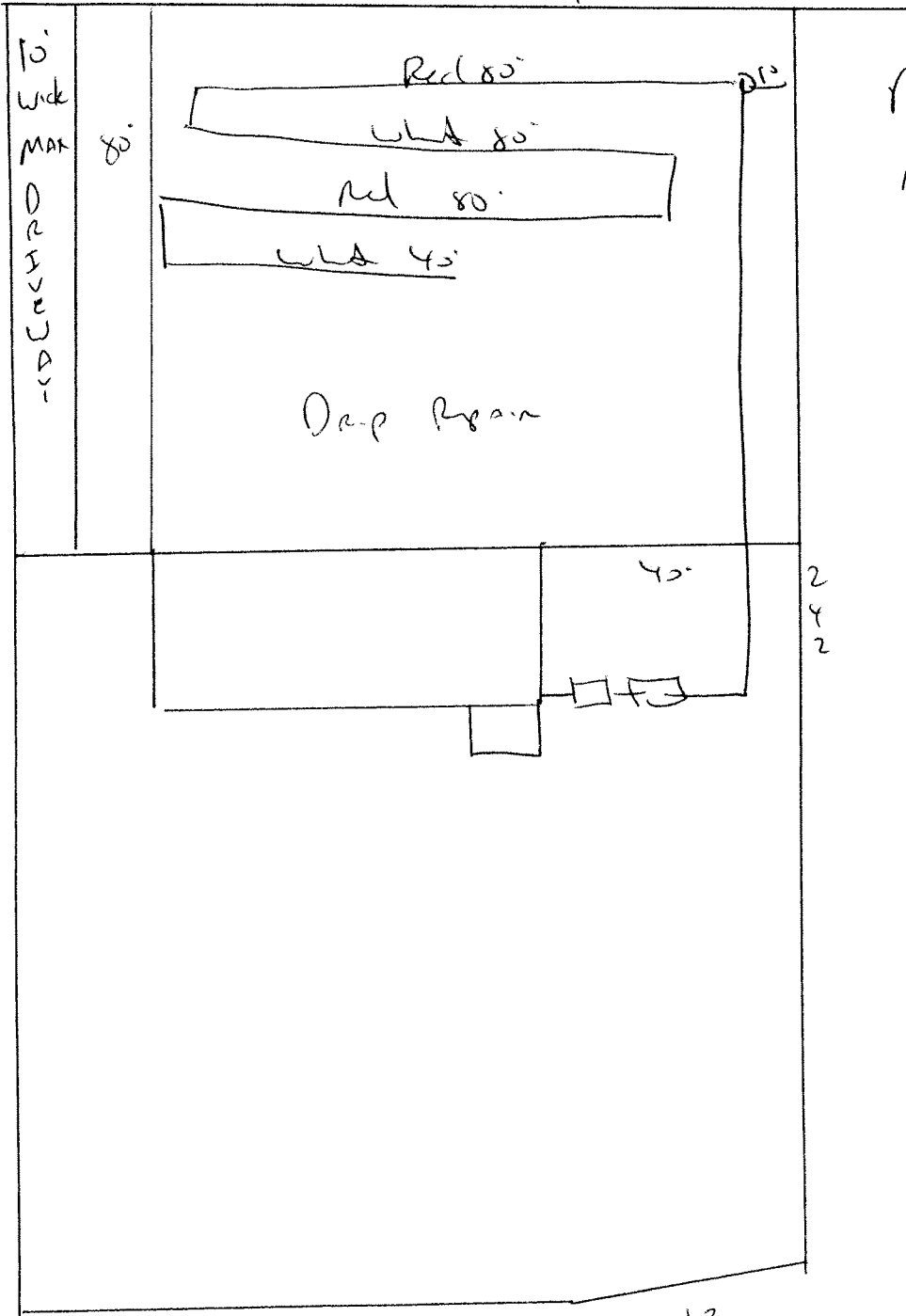

meet on site

maintain all  
set back

Install 1x270  
of 25% reduction  
system  
at 18"