

**SOIL/SITE EVALUATION**  
**for ON-SITE WASTEWATER SYSTEM**

Owner: 08-500-19640

Applicant:

Address:

Date Evaluated:

Proposed Facility: SFD

Design Flow (.1949): 600

Property Size:

Location of Site: Dove M

Property Recorded:

Water Supply:  Public  Individual  Well

Spring

Other

Evaluation Method:  Auger Boring  Pit

Cut

Type of Wastewater:  Sewage  Industrial Process  Mixed

P R O F I L E #	.1940 Landscape Position/ Slope%	Horizon Depth (IN.)	SOIL MORPHOLOGY .1941		OTHER PROFILE FACTORS				Profile Class & LTAR
			.1941 Structure/ Texture	.1941 Consistence Mineralogy	.1942 Soil Wetness/ Color	.1943 Soil Depth (IN.)	.1956 Sapro Class	.1944 Restr Horiz	
1	S 5%	0-18	GR SL	VFR SE					.2
		18-28	SDK SCL	FR SE					
		28-38	SPK SE	FI SE					
2	8, 10, 11 12, 13, 15	0-42	GA SL	VFR SE					.6
3	4, 5	0-38	GR SL	VFR SE					.5
		38-48	SDK SCL	FR SE					
4	9, 11	0-18	GR SL	VFR SE					.7
		18-20	SDK SCL	VFR SE					
		20-38	SDK SC	FI SE					
47		0-18	GR SL	VFR SE					.3 km
		18-26	SDK SCL	FR SE					
		26-38	SDK SC	PI SE					

Description	Initial System	Repair System
Available Space (.1945)	/	/
System Type(s)	Grave	25%
Site LTAR	.4	.2

Other Factors (.1946): \_\_\_\_\_  
 Site Classification (.1948): P  
 Evaluated By: 92  
 Others Present:

COMMENTS: \_\_\_\_\_  
 \_\_\_\_\_  
 \_\_\_\_\_

<u>LANDSCAPE POSITIONS</u>	<u>GROUP</u>	<u>TEXTURES</u>	<u>.1955 LTAR</u>	<u>CONSISTENCE MOIST</u>	<u>WET</u>
R-RIDGE	I	S-SAND	1.2 - 0.8	VFR-VERY FRIABLE	NS-NON-STICKY
S-SHOULDER SLOPE		LS-LOAMY SAND		FR-FRIABLE	SS-SLIGHTLY STICKY
L-LINEAR SLOPE	II	SL-SANDY LOAM	0.8 - 0.6	FI-FIRM	S-STICKY
FS-FOOT SLOPE		L-LOAM		VFI-VERY FIRM	VS-VERY STICKY
N-NOSE SLOPE	III	SI-SILT-	0.6 - 0.3	EFI-EXTREMELY FIRM	NP-NON-PLASTIC
H-HEAD SLOPE		SIL-SILT LOAM			SP-SLIGHTLY STICKY
CC-CONCLAVE SLOPE		CL-CLAY LOAM			P-PLASTIC
CV-CONVEX SLOPE		SCL-SANDY CLAY LOAM			VP-VERY PLASTIC
T-TERRACE		SICL-SILTY CLAY LOAM			
FP-FLOOD PLAN	IV	SIC-SILTY CLAY	0.4 - 0.1		
		C-CLAY			
		SC-SANDY CLAY			

STRUCTURE  
 SG-SINGLE GRAIN  
 M-MASSIVE  
 CR-CRUMB  
 GR-GRANULAR  
 SBK-SUBANGULAR BLOCKY  
 ABK-ANGULAR BLOCKY  
 PL-PLATY  
 PR-PRISMATIC

MINERALOGY  
 SLIGHTLY EXPANSIVE  
 EXPANSIVE

Show profile locations and other site features (dimensions, reference or benchmark, and North).

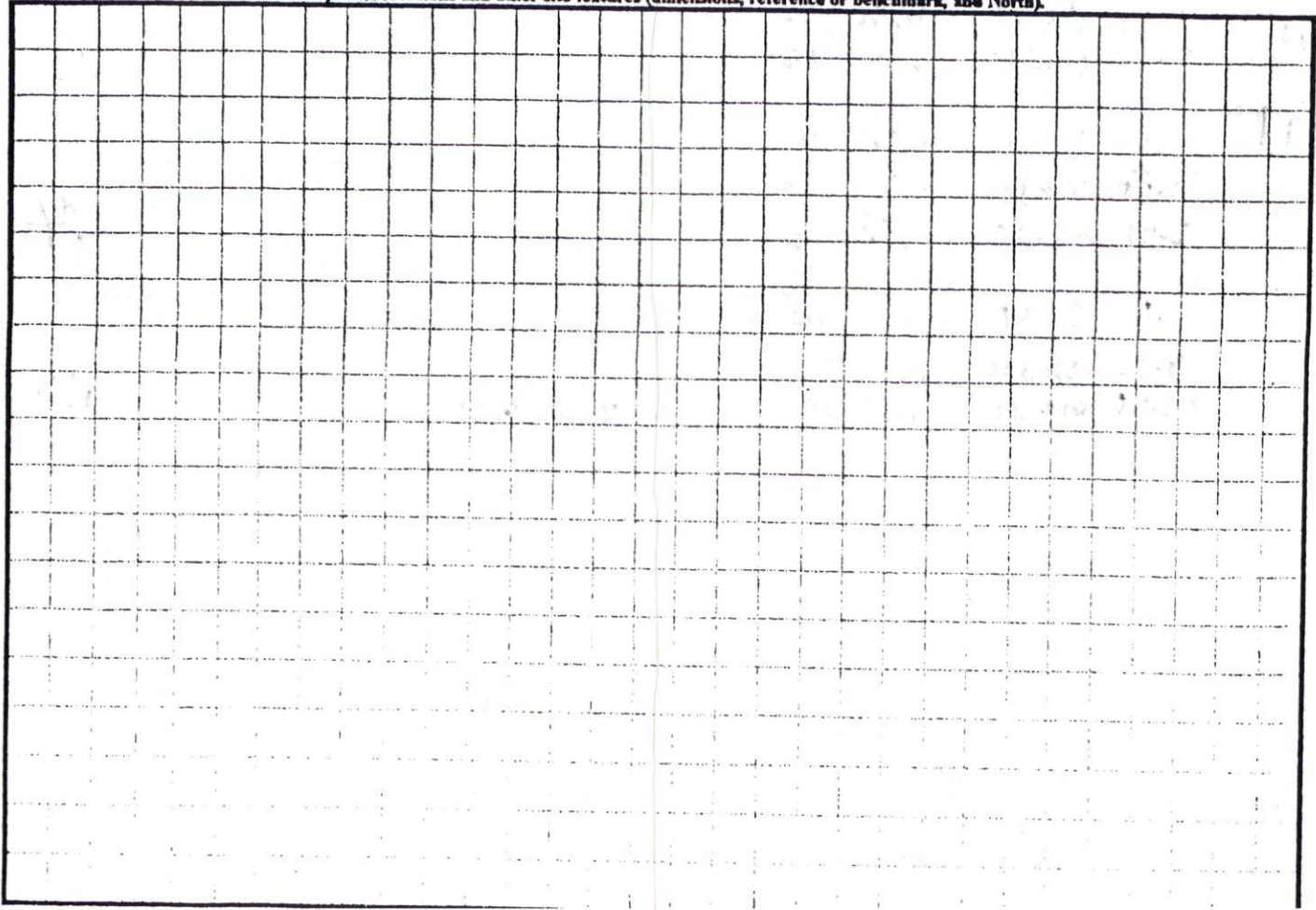

Will  
need to  
do work  
to determine  
if 20%  
of ground

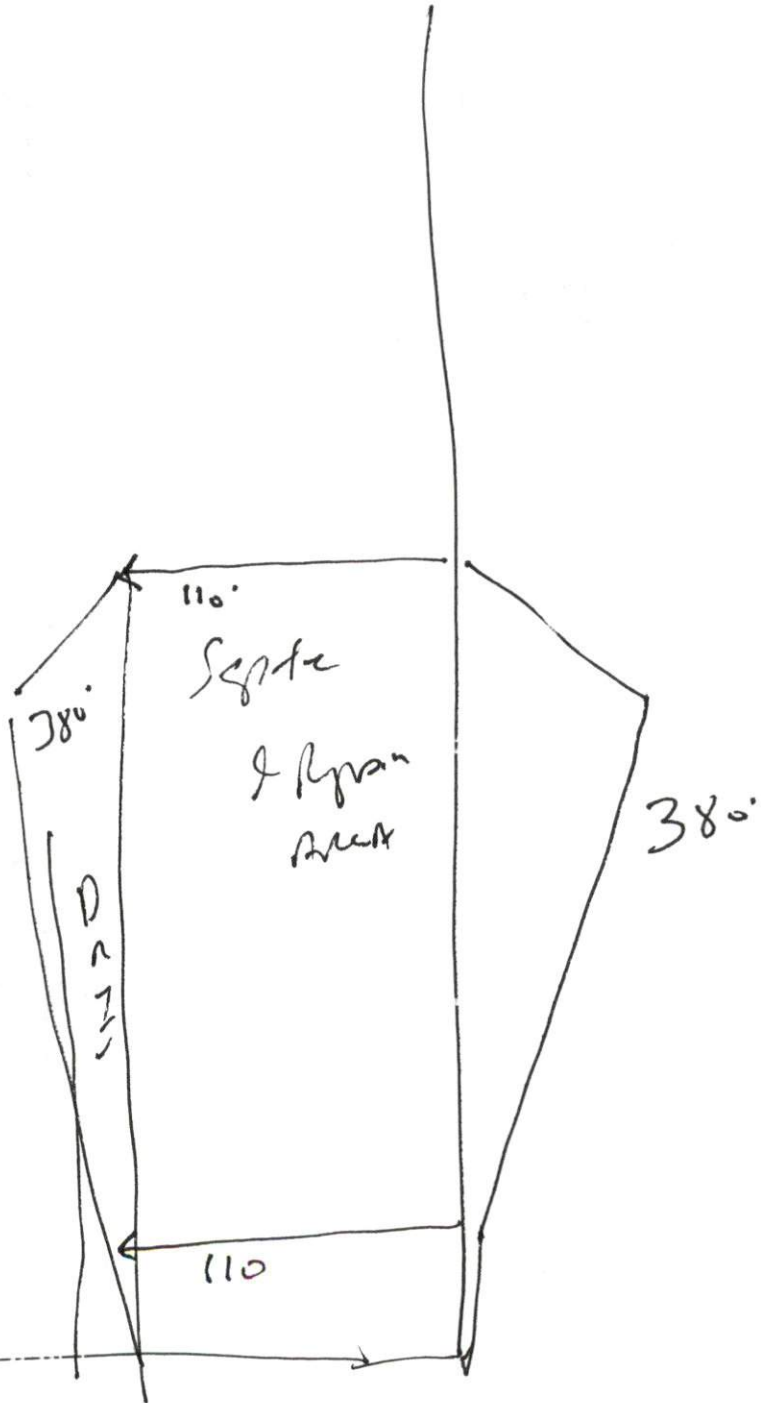
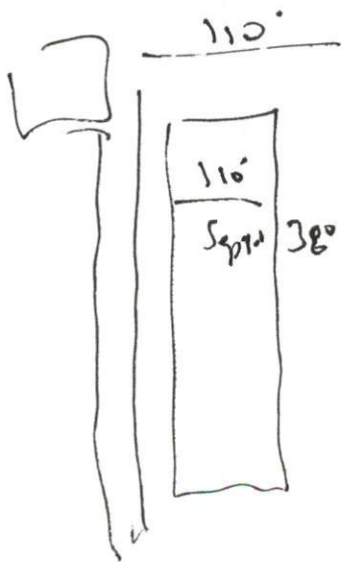

RL

→ N(24/27) →

77.689

Moore County Line

2354.04

0708

2316.50

SITE PLAN APPROVAL

DISTRICT BA20R USE SFD

#BEDROOMS 5

Date 3/12/08 [Signature]  
Zoning Administrator

[Signature]

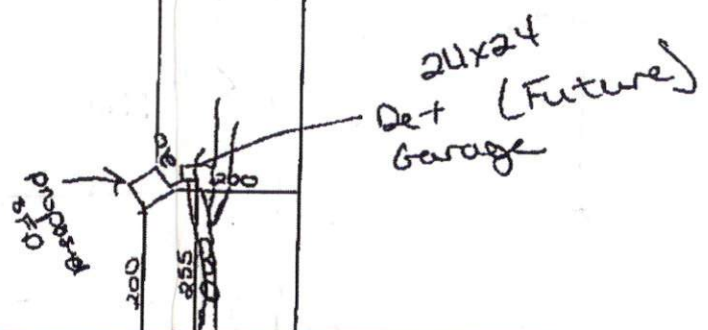

646.50

Done RC SR#1200