

HTE# 08-500-19529

Harrell County Department of Public Health

24674

Improvement Permit

A building permit cannot be issued with only an Improvement Permit

ISSUED TO: CARINA Bibbens PROPERTY LOCATION: 1229  
 SUBDIVISION Anne J. Hollowell LOT # Tract 3  
 NEW  REPAIR  EXPANSION   
 Type of Structure: SFD - 40x66 Site Improvements required prior to Construction Authorization Issuance: (8.63AC)  
 Proposed Wastewater System Type: Pump to 25 1/2 Red. system Please note that home owner Requests  
 Projected Daily Flow: 480 GPD That system be designed for 4 Bedroom  
 Number of bedrooms: 4 Number of Occupants: 8 max for future expansion  
 Basement  Yes  No  
 Pump Required:  Yes  No  May be required based on final location and elevations of facilities  
 Type of Water Supply:  Community  Public  Well Distance from well 50 feet Permit valid for:  Five years  
 Permit conditions: Meet onsite for final layout maintain all  No expiration  
Set BACK - SYSTEM is to be designed for 4 Bedroom (owner request) but current  
home is 3 Bedroom

Authorized State Agent: Ju LAR Date: 03-27-08 SEE ATTACHED SITE SKETCH  
 The issuance of this permit by the Health Department in no way guarantees the issuance of other permits. The permit holder is responsible for checking with appropriate governing bodies in meeting their requirements. This site is subject to revocation if the site plan, plat, or the intended use changes. The Improvement Permit shall not be affected by a change in ownership of the site. This permit is subject to compliance with the provisions of the Laws and Rules for Sewage Treatment and Disposal and to conditions of this permit.

Construction Authorization

(Required for Building Permit)

The construction and installation requirements of Rules .1950, .1952, .1954, .1955, .1956, .1957, .1958, and .1959 are incorporated by references into this permit and shall be met. Systems shall be installed in accordance with the attached system layout.

ISSUED TO: CARINA Bibbens PROPERTY LOCATION: 1229  
 SUBDIVISION Anne J Hollowell LOT # Tract 3  
 Facility Type: SFD - 40x66  New  Expansion  Repair  
 Basement?  Yes  No Basement Fixtures?  Yes  No  
 Type of Wastewater System\*\* Pump to 25 1/2 Red (Initial) Wastewater Flow: 480 GPD  
 (See note below, if applicable)  LLP (Repair)

Installation Requirements/Conditions

Septic Tank Size 1000 gallons Exact length of each trench 3 x 160 feet Trench Spacing: 9 Feet on Center  
 Pump Tank Size 1000 gallons Trenches shall be installed on contour at a Soil Cover: 6 inches  
 Maximum Trench Depth of: 18 inches (Maximum soil cover shall not exceed  
 (Trench bottoms shall be level to +/- 1/4" 36" above the trench bottom)  
 in all directions)  
 Pump Requirements: \_\_\_\_\_ ft. TDH vs. \_\_\_\_\_ GPM Aggregate Depth: \_\_\_\_\_ inches below pipe  
 \_\_\_\_\_ inches above pipe  
 \_\_\_\_\_ inches total  
 Conditions: \_\_\_\_\_

\*\*If applicable: I understand the system type specified is different from the type specified on the application. I accept the specifications of this permit.

Owner/Legal Representative Signature: \_\_\_\_\_ Date: \_\_\_\_\_

This Construction Authorization is subject to revocation if the site plan, plat, or the intended use changes. The Construction Authorization shall not be transferred when there is a change in ownership of the site. This Construction Authorization is subject to compliance with the provisions of the Laws and Rules for Sewage Treatment and Disposal and to the conditions of this permit.

Authorized State Agent: Ju LAR Date: 03-27-08 SEE ATTACHED SITE SKETCH  
 Construction Authorization Expiration Date: 03-27-2013

HTE# 08-500 19529

Permit # 24674

# Harnett County Department of Public Health Site Sketch

ISSUED TO: CARINA Bibbens

PROPERTY LOCATOR: 1229

SUBDIVISION Anne J Hallauell

LOT # Tract 3  
18.63 ac

Authorized State Agent: J. L. [Signature]

Date: 03-27-08

Meet onsite for Final  
Layout.

Maintain All set Backs

INSTALL 3 Lines  
165' long each  
of 25% Reduction  
system at  
18"

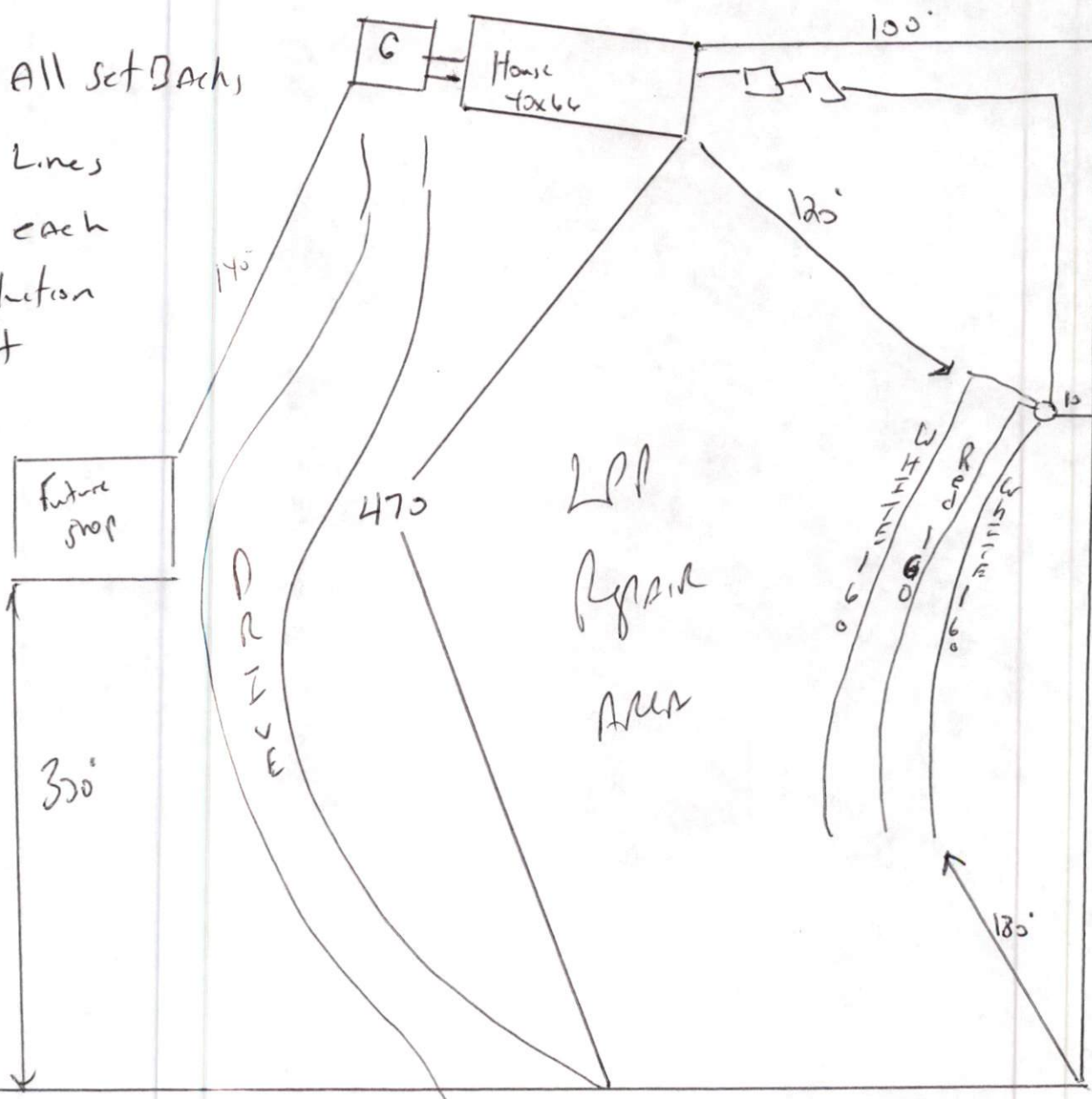

16-2

SR 1229

To L. Kingdon →