

HTE# 08-500-19379

Harnett County Department of Public Health

24489

### Improvement Permit

A building permit cannot be issued with only an Improvement Permit

ISSUED TO: Cumberland Homes PROPERTY LOCATION: 1125  
 NEW  REPAIR  EXPANSION  SUBDIVISION: Woodshim LOT # 213  
 Type of Structure: SFD-54x45-3Br Site Improvements required prior to Construction Authorization Issuance:  
 Proposed Wastewater System Type: 25% Reduction system  
 Projected Daily Flow: 360 GPD  
 Number of bedrooms: 3 Number of Occupants: 6 max  
 Basement  Yes  No  
 Pump Required:  Yes  No  May be required based on final location and elevations of facilities  
 Type of Water Supply:  Community  Public  Well Distance from well 50 feet Permit valid for:  Five years  
 Permit conditions: STUBOUT Plumbing shallow, At ground level or higher  No expiration  
where shown. maintain All set Backs

Authorized State Agent: [Signature] Date: 02-25-08 SEE ATTACHED SITE SKETCH  
 The issuance of this permit by the Health Department in no way guarantees the issuance of other permits. The permit holder is responsible for checking with appropriate governing bodies in meeting their requirements. This site is subject to revocation if the site plan, plat, or the intended use changes. The Improvement Permit shall not be affected by a change in ownership of the site. This permit is subject to compliance with the provisions of the Laws and Rules for Sewage Treatment and Disposal and to conditions of this permit.

### Construction Authorization

(Required for Building Permit)

The construction and installation requirements of Rules .1950, .1952, .1954, .1955, .1956, .1957, .1958, and .1959 are incorporated by references into this permit and shall be met. Systems shall be installed in accordance with the attached system layout.

ISSUED TO: Cumberland Homes PROPERTY LOCATION: 1125  
 SUBDIVISION: Woodshire LOT # 213  
 Facility Type: SFD-54x45-3Br  New  Expansion  Repair  
 Basement?  Yes  No Basement Fixtures?  Yes  No  
 Type of Wastewater System\*\* 25% Reduction system (Initial) Wastewater Flow: 360 GPD  
 (See note below, if applicable  LRP (Repair))

#### Installation Requirements/Conditions

Septic Tank Size 1000 gallons Exact length of each trench 1x180 feet Trench Spacing: 9 Feet on Center  
 Pump Tank Size \_\_\_\_\_ gallons Trenches shall be installed on contour at a Soil Cover: 6 inches  
 Maximum Trench Depth of: 18.24 inches (Maximum soil cover shall not exceed 36" above the trench bottom)  
 (Trench bottoms shall be level to +/-1/4" in all directions)  
 Pump Requirements: \_\_\_\_\_ ft. TDH vs. \_\_\_\_\_ GPM \_\_\_\_\_ inches below pipe  
 Aggregate Depth: \_\_\_\_\_ inches above pipe  
 Conditions: \_\_\_\_\_ inches total

\*\*If applicable: *I understand the system type specified is different from the type specified on the application. I accept the specifications of this permit.*

Owner/Legal Representative Signature: \_\_\_\_\_ Date: \_\_\_\_\_

This Construction Authorization is subject to revocation if the site plan, plat, or the intended use changes. The Construction Authorization shall not be transferred when there is a change in ownership of the site. This Construction Authorization is subject to compliance with the provisions of the Laws and Rules for Sewage Treatment and Disposal and to the conditions of this permit.

Authorized State Agent: [Signature] Date: 02-25-08 SEE ATTACHED SITE SKETCH  
 Construction Authorization Expiration Date: 02-25-2013

HTE# 08-500-19379

Permit # 24489

# Harnett County Department of Public Health Site Sketch

ISSUED TO: Cumberland Home PROPERTY LOCATOR: 1125 SUBDIVISION: Woodshire LOT # 213  
 Authorized State Agent: J. L. [Signature] Date: 2-25-08

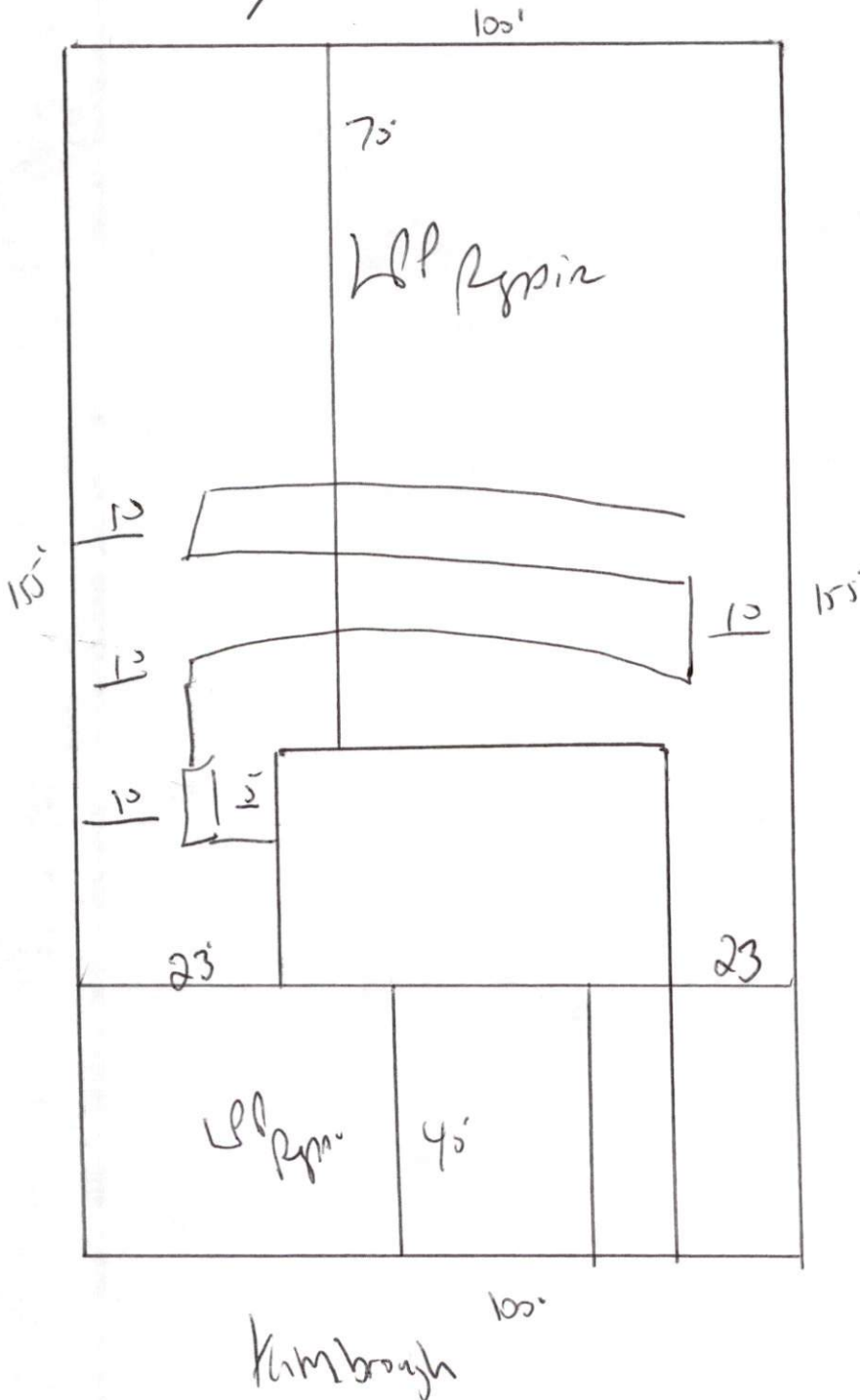

STUB out Plumbing  
 shallow, at ground level  
 or higher where  
 shown

maintain all  
 setbacks

Install 1x180 y  
 25% reduction system  
 at 18 to 24" deep.