

HTE# 08-500-19347

Harnett County Department of Public Health

24484

Improvement Permit

A building permit cannot be issued with only an Improvement Permit

ISSUED TO: Kenneth Cummings PROPERTY LOCATION: 1125
 NEW REPAIR EXPANSION SUBDIVISION: Woodshire LOT # 217
 Type of Structure: SFD-56x58-4BR Site Improvements required prior to Construction Authorization Issuance:
 Proposed Wastewater System Type: 25% Reduction System
 Projected Daily Flow: 480 GPD
 Number of bedrooms: 4 Number of Occupants: 8 max
 Basement Yes No
 Pump Required: Yes No May be required based on final location and elevations of facilities
 Type of Water Supply: Community Public Well Distance from well 50 feet Permit valid for: Five years
 Permit conditions: STUB out plumbing shallow, at ground level or higher No expiration
where shown maintain all setbacks Melt onsite

Authorized State Agent: J. White Date: 02-21-08 SEE ATTACHED SITE SKETCH
 The issuance of this permit by the Health Department in no way guarantees the issuance of other permits. The permit holder is responsible for checking with appropriate governing bodies in meeting their requirements. This site is subject to revocation if the site plan, plat, or the intended use changes. The Improvement Permit shall not be affected by a change in ownership of the site. This permit is subject to compliance with the provisions of the Laws and Rules for Sewage Treatment and Disposal and to conditions of this permit.

Construction Authorization

(Required for Building Permit)

The construction and installation requirements of Rules .1950, .1952, .1954, .1955, .1956, .1957, .1958, and .1959 are incorporated by references into this permit and shall be met. Systems shall be installed in accordance with the attached system layout.

ISSUED TO: Kenneth Cummings PROPERTY LOCATION: 1125
 SUBDIVISION: Woodshire LOT # 217
 Facility Type: SFD-56x58-4BR New Expansion Repair
 Basement? Yes No Basement Fixtures? Yes No
 Type of Wastewater System** 25% Reduction sys. (Initial) Wastewater Flow: 480 GPD
 (See note below, if applicable) LPP (Repair)

Installation Requirements/Conditions

Septic Tank Size 1000 gallons Exact length of each trench 1x210 feet Trench Spacing: 9 Feet on Center
 Pump Tank Size _____ gallons Trenches shall be installed on contour at a Soil Cover: 6 inches
 Maximum Trench Depth of: 18-24 inches (Maximum soil cover shall not exceed
 (Trench bottoms shall be level to +/-1/4" 36" above the trench bottom)
 in all directions)
 Pump Requirements: _____ ft. TDH vs. _____ GPM Aggregate Depth: _____ inches below pipe
 _____ inches above pipe
 Conditions: _____ inches total

**If applicable: *I understand the system type specified is different from the type specified on the application. I accept the specifications of this permit.*

Owner/Legal Representative Signature: _____ Date: _____

This Construction Authorization is subject to revocation if the site plan, plat, or the intended use changes. The Construction Authorization shall not be transferred when there is a change in ownership of the site. This Construction Authorization is subject to compliance with the provisions of the Laws and Rules for Sewage Treatment and Disposal and to the conditions of this permit.

Authorized State Agent: J. White Date: 02-21-08 SEE ATTACHED SITE SKETCH
 Construction Authorization Expiration Date: 02-21-2013

HTE# 08-500-19347

Permit # 24484

Harnett County Department of Public Health Site Sketch

ISSUED TO: Kenneth Cummings PROPERTY LOCATOR: 1125
SUBDIVISION: Woodshire LOT # 217

Authorized State Agent: J. L. [Signature] Date: 02-21-08

103

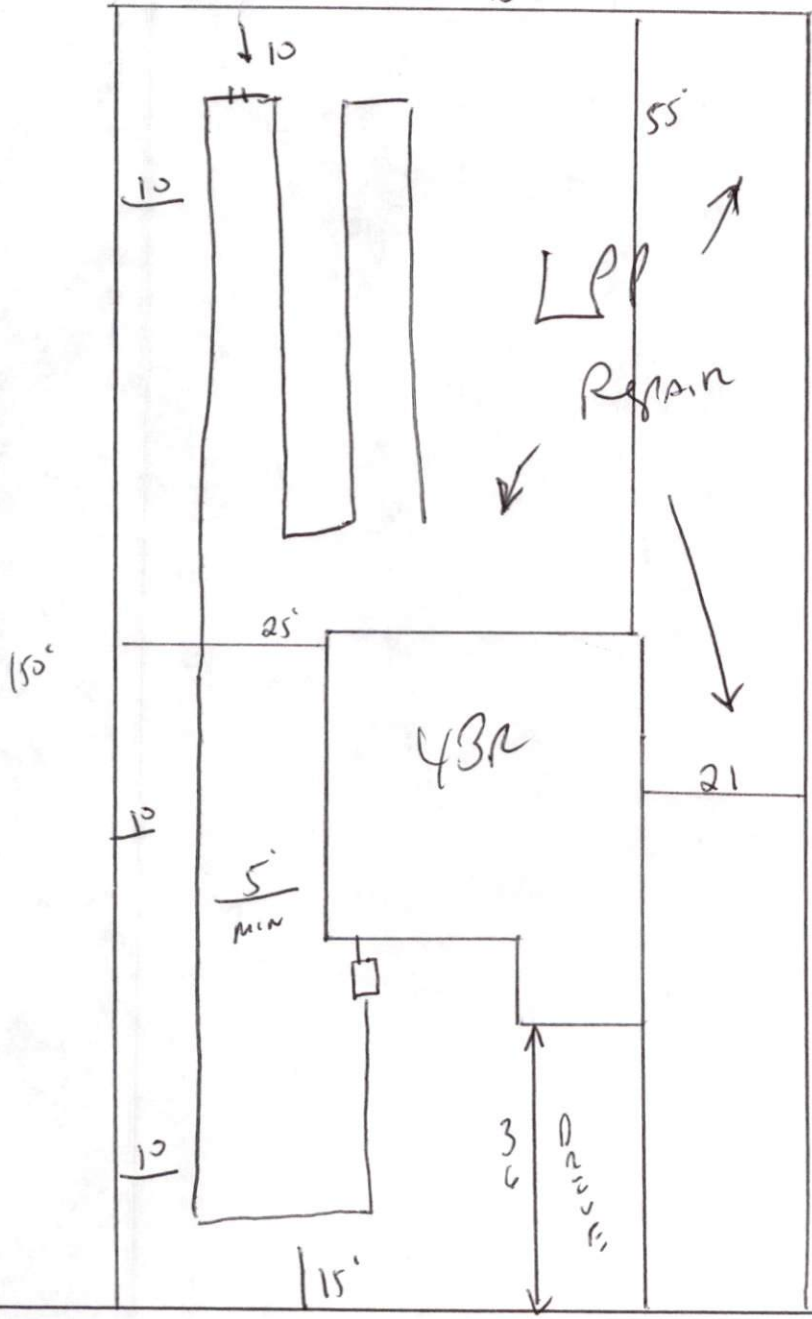

STUB out Plumbing
 Shallow, At ground level
 or higher where shown
 MAINTAIN ALL set BACK
 Install 1x210 & 25%
 Reduction system At 18 to
 24"
 Meet onsite

SONORA 103