

HTE# 08-50519340

Harnett County Department of Public Health 24492

Improvement Permit

A building permit cannot be issued with only an Improvement Permit

ISSUED TO: Cumberland Homes PROPERTY LOCATION: 1108
 NEW REPAIR EXPANSION SUBDIVISION: Yorkshire Plantation LOT # 184
 Type of Structure: SFD - 56x34 - 302 Site Improvements required prior to Construction Authorization Issuance: _____
 Proposed Wastewater System Type: 2 1/2 Red. system
 Projected Daily Flow: 360 GPD
 Number of bedrooms: 3 Number of Occupants: 6 max
 Basement Yes No
 Pump Required: Yes No May be required based on final location and elevations of facilities
 Type of Water Supply: Community Public Well Distance from well 50 feet Permit valid for: Five years
 Permit conditions: 5' dug out Plumbing shallow, at ground level or higher No expiration
Where shown maintain all set back

Authorized State Agent: [Signature] Date: 02-25-08 SEE ATTACHED SITE SKETCH
 The issuance of this permit by the Health Department in no way guarantees the issuance of other permits. The permit holder is responsible for checking with appropriate governing bodies in meeting their requirements. This site is subject to revocation if the site plan, plat, or the intended use changes. The Improvement Permit shall not be affected by a change in ownership of the site. This permit is subject to compliance with the provisions of the Laws and Rules for Sewage Treatment and Disposal and to conditions of this permit.

Construction Authorization

(Required for Building Permit)

The construction and installation requirements of Rules .1950, .1952, .1954, .1955, .1956, .1957, .1958, and .1959 are incorporated by references into this permit and shall be met. Systems shall be installed in accordance with the attached system layout.

ISSUED TO: Cumberland Homes PROPERTY LOCATION: 1108
 Facility Type: SFD 56x34-302 New Expansion Repair
 Basement? Yes No Basement Fixtures? Yes No
 Type of Wastewater System** 2 1/2 Red. system (Initial) Wastewater Flow: 360 GPD
 (See note below, if applicable LRA (Repair))

Installation Requirements/Conditions

Septic Tank Size 1000 gallons Exact length of each trench 1x180 feet Trench Spacing: 09 Feet on Center
 Pump Tank Size _____ gallons Trenches shall be installed on contour at a Soil Cover: 6 inches
 Maximum Trench Depth of: 1824 inches (Maximum soil cover shall not exceed 36" above the trench bottom)
 (Trench bottoms shall be level to +/- 1/4" in all directions)
 Pump Requirements: _____ ft. TDH vs. _____ GPM _____ inches below pipe
 Conditions: _____ Aggregate Depth: _____ inches above pipe
 _____ inches total

**If applicable: *I understand the system type specified is different from the type specified on the application. I accept the specifications of this permit.*

Owner/Legal Representative Signature: _____ Date: _____

This Construction Authorization is subject to revocation if the site plan, plat, or the intended use changes. The Construction Authorization shall not be transferred when there is a change in ownership of the site. This Construction Authorization is subject to compliance with the provisions of the Laws and Rules for Sewage Treatment and Disposal and to the conditions of this permit.

Authorized State Agent: [Signature] Date: 02-25-08 SEE ATTACHED SITE SKETCH
 Construction Authorization Expiration Date: 02-12-2013

HTE# 08-500-1934

Permit # 24492

Harnett County Department of Public Health Site Sketch

ISSUED TO: Cumberland Homes PROPERTY LOCATOR: 1108
SUBDIVISION: Yorkshire Plantation LOT # 184

Authorized State Agent: J. Waters Date: 02-25-08

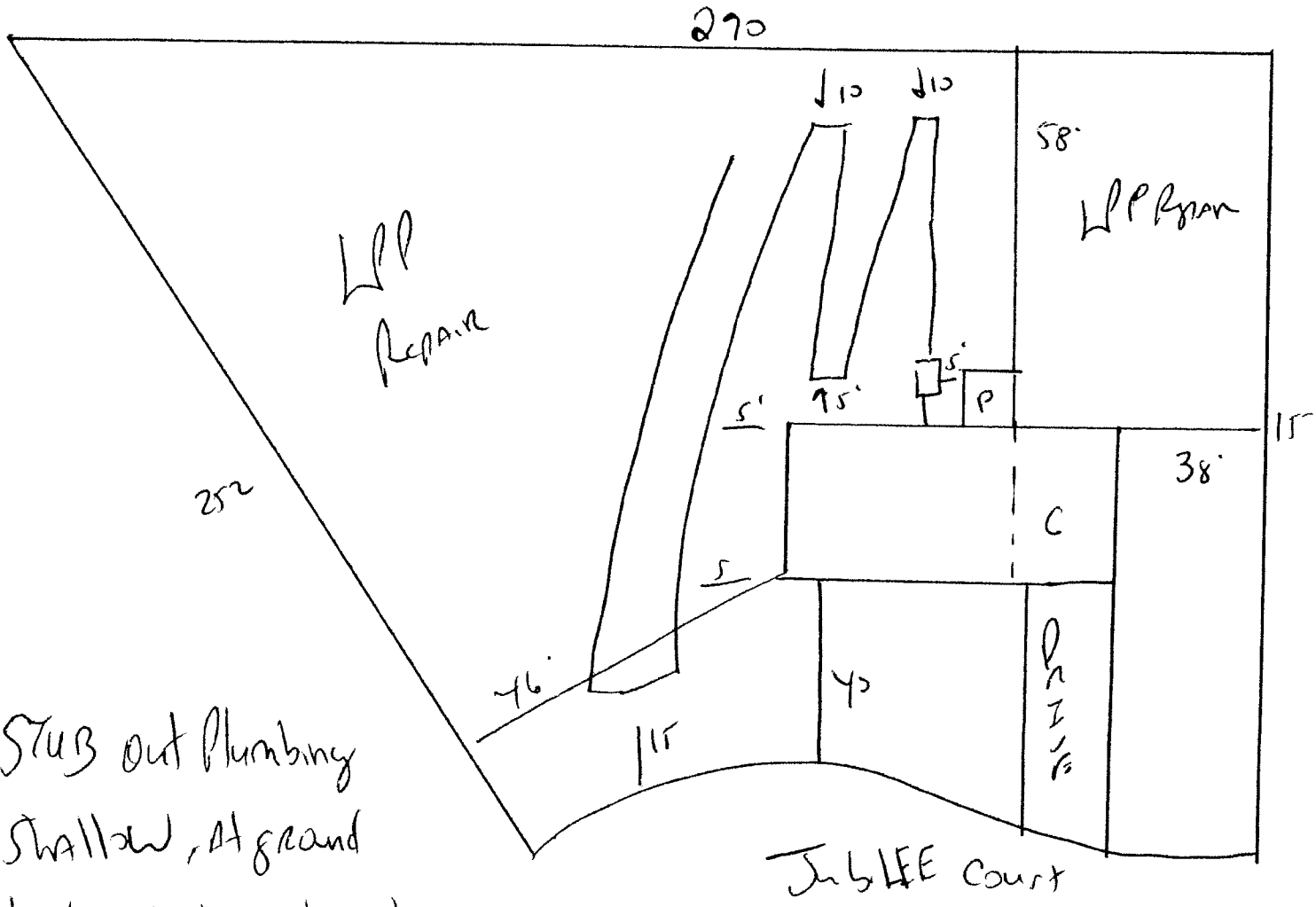

STUB out Plumbing
Shallow, At ground
level or higher where shown

Maintain All setbacks

Install 1x100 of 25% Reduction system