

HTE# 08-500-19312

Harris County Department of Public Health

24476

Improvement Permit

A building permit cannot be issued with only an Improvement Permit

ISSUED TO: ISRAEL LUCAS PROPERTY LOCATION: Northview Drive SUBDIVISION: Sunset Ridge LOT # 156

NEW [X] REPAIR [] EXPANSION [] Type of Structure: SFD-52x72-3BR Proposed Wastewater System Type: 2 1/2 Reduction system Projected Daily Flow: 360 GPD Number of bedrooms: 3 Number of Occupants: 6 max Basement [] Yes [X] No

Pump Required: [] Yes [] No [X] May be required based on final location and elevations of facilities Type of Water Supply: [] Community [X] Public [] Well Distance from well: 50 feet Permit valid for: [X] Five years [] No expiration Permit conditions: Stub out plumbing shallow, at ground level or higher where shown. maintain All set Backs maintain All set Backs

Authorized State Agent: J. Waters Date: 02-15-07 SEE ATTACHED SITE SKETCH

The issuance of this permit by the Health Department in no way guarantees the issuance of other permits. The permit holder is responsible for checking with appropriate governing bodies in meeting their requirements. This site is subject to revocation if the site plan, plat, or the intended use changes. The Improvement Permit shall not be affected by a change in ownership of the site. This permit is subject to compliance with the provisions of the Laws and Rules for Sewage Treatment and Disposal and to conditions of this permit.

Construction Authorization

(Required for Building Permit)

The construction and installation requirements of Rules .1950, .1952, .1954, .1955, .1956, .1957, .1958, and .1959 are incorporated by references into this permit and shall be met. Systems shall be installed in accordance with the attached system layout.

ISSUED TO: ISRAEL LUCAS PROPERTY LOCATION: Northview Drive SUBDIVISION: Sunset Ridge LOT # 156

Facility Type: SFD-52x72-3BR [X] New [] Expansion [] Repair Basement? [] Yes [X] No Basement Fixtures? [] Yes [X] No Type of Wastewater System: 2 1/2 Reduction system (Initial) Wastewater Flow: 360 GPD (See note below, if applicable [X]) 2 1/2 Reduction system (Repair)

Installation Requirements/Conditions

Septic Tank Size: 1000 gallons Exact length of each trench: 1 x 180 feet Trench Spacing: 9 Feet on Center Pump Tank Size: _____ gallons Trenches shall be installed on contour at a Soil Cover: 6 inches Maximum Trench Depth of: 18-24 inches (Maximum soil cover shall not exceed 36" above the trench bottom) (Trench bottoms shall be level to +/- 1/4" in all directions) Pump Requirements: _____ ft. TDH vs. _____ GPM Aggregate Depth: _____ inches below pipe _____ inches above pipe _____ inches total Conditions: _____

**If applicable: I understand the system type specified is different from the type specified on the application. I accept the specifications of this permit.

Owner/Legal Representative Signature: _____ Date: _____

This Construction Authorization is subject to revocation if the site plan, plat, or the intended use changes. The Construction Authorization shall not be transferred when there is a change in ownership of the site. This Construction Authorization is subject to compliance with the provisions of the Laws and Rules for Sewage Treatment and Disposal and to the conditions of this permit.

Authorized State Agent: J. Waters Date: 02-15-08 SEE ATTACHED SITE SKETCH Construction Authorization Expiration Date: 02-15-2013

HTE# 08-500-19312

Permit # 24476

Harnett County Department of Public Health Site Sketch

PROPERTY LOCATOR: NORTHVIEW DRIVE

ISSUED TO: Israel Lucas

SUBDIVISION Sunset Ridge

LOT # 156

Authorized State Agent: J. W. [Signature]

Date: 02-15-08

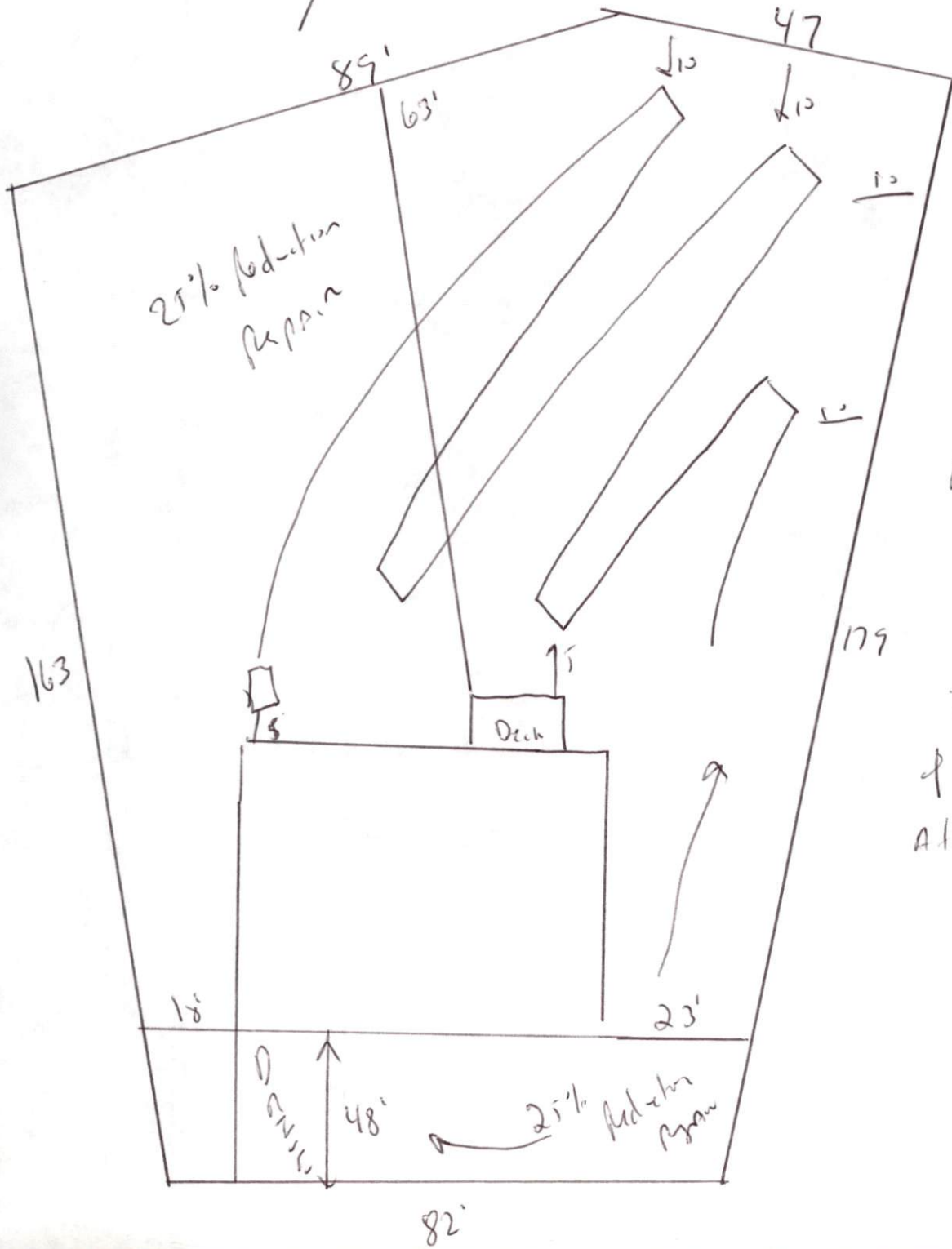

STAB out
Plumbing
Shallow, At
ground level or
higher where
shown
maintain
All set Dacks
Install 1x180'
of 25% reduction system
At 18 to 24" Deep.