

08-50019946 - Storage Building
HTE# 08-50019812R Harnett County Department of Public Health

24769

Improvement Permit

A building permit cannot be issued with only an Improvement Permit

ISSUED TO: Israel Lucas PROPERTY LOCATION: 1141
NEW REPAIR EXPANSION
SUBDIVISION: Sunset Ridge LOT # 156
Type of Structure: SFD-52x72 3BR Site Improvements required prior to Construction Authorization Issuance:
Proposed Wastewater System Type: 25% Reduction system
Projected Daily Flow: 360 GPD
Number of bedrooms: 3 Number of Occupants: 6 max
Basement Yes No
Pump Required: Yes No May be required based on final location and elevations of facilities
Type of Water Supply: Community Public Well Distance from well 50 feet Permit valid for: Five years
Permit conditions: Meet onsite for Final Layout maintain All set backs No expiration
STUB out Plumbing Shallow at ground level or higher

Authorized State Agent: [Signature] Date: 05-05-08 SEE ATTACHED SITE SKETCH

The issuance of this permit by the Health Department in no way guarantees the issuance of other permits. The permit holder is responsible for checking with appropriate governing bodies in meeting their requirements. This site is subject to revocation if the site plan, plat, or the intended use changes. The Improvement Permit shall not be affected by a change in ownership of the site. This permit is subject to compliance with the provisions of the Laws and Rules for Sewage Treatment and Disposal and to conditions of this permit.

Construction Authorization

(Required for Building Permit)

The construction and installation requirements of Rules .1950, .1952, .1954, .1955, .1956, .1957, .1958, and .1959 are incorporated by references into this permit and shall be met. Systems shall be installed in accordance with the attached system layout.

ISSUED TO: Israel Lucas PROPERTY LOCATION: 1141
FACILITY TYPE: SFD-52x72-3BR New Expansion Repair
Basement? Yes No Basement Fixtures? Yes No
SUBDIVISION: Sunset Ridge LOT # 156
Type of Wastewater System** 25% Reduction system (Initial) Wastewater Flow: 360 GPD
(See note below, if applicable)
25% Reduction sys. (Repair)

Installation Requirements/Conditions

Septic Tank Size 1000 gallons
Pump Tank Size _____ gallons
Number of trenches 1
Exact length of each trench 100 feet
Trenches shall be installed on contour at a
Maximum Trench Depth of: 18-24 inches
(Trench bottoms shall be level to $\pm 1/4$ "
in all directions)
Trench Spacing: 7 Feet on Center
Soil Cover: 6 inches
(Maximum soil cover shall not exceed
36" above the trench bottom)
Pump Requirements: _____ ft. TDH vs. _____ GPM
Aggregate Depth: _____ inches below pipe
_____ inches above pipe
_____ inches total

**If applicable: I understand the system type specified is different from the type specified on the application. I accept the specifications of this permit.

Owner/Legal Representative Signature: _____ Date: _____

This Construction Authorization is subject to revocation if the site plan, plat, or the intended use changes. The Construction Authorization shall not be transferred when there is a change in ownership of the site. This Construction Authorization is subject to compliance with the provisions of the Laws and Rules for Sewage Treatment and Disposal and to the conditions of this permit. SEE ATTACHED SITE SKETCH

Authorized State Agent: [Signature] Date: 05-05-08
Construction Authorization Expiration Date: 05-05-2017

08-500-19946 - Storage Building

HTE# 08-500-19312R

Permit # 24769

Harnett County Department of Public Health Site Sketch

ISSUED TO: ISRAEL Lucas PROPERTY LOCATOR: 1141
SUBDIVISION: SUNSET RIDGE LOT # 156

Authorized State Agent: [Signature] Date: 05-05-08

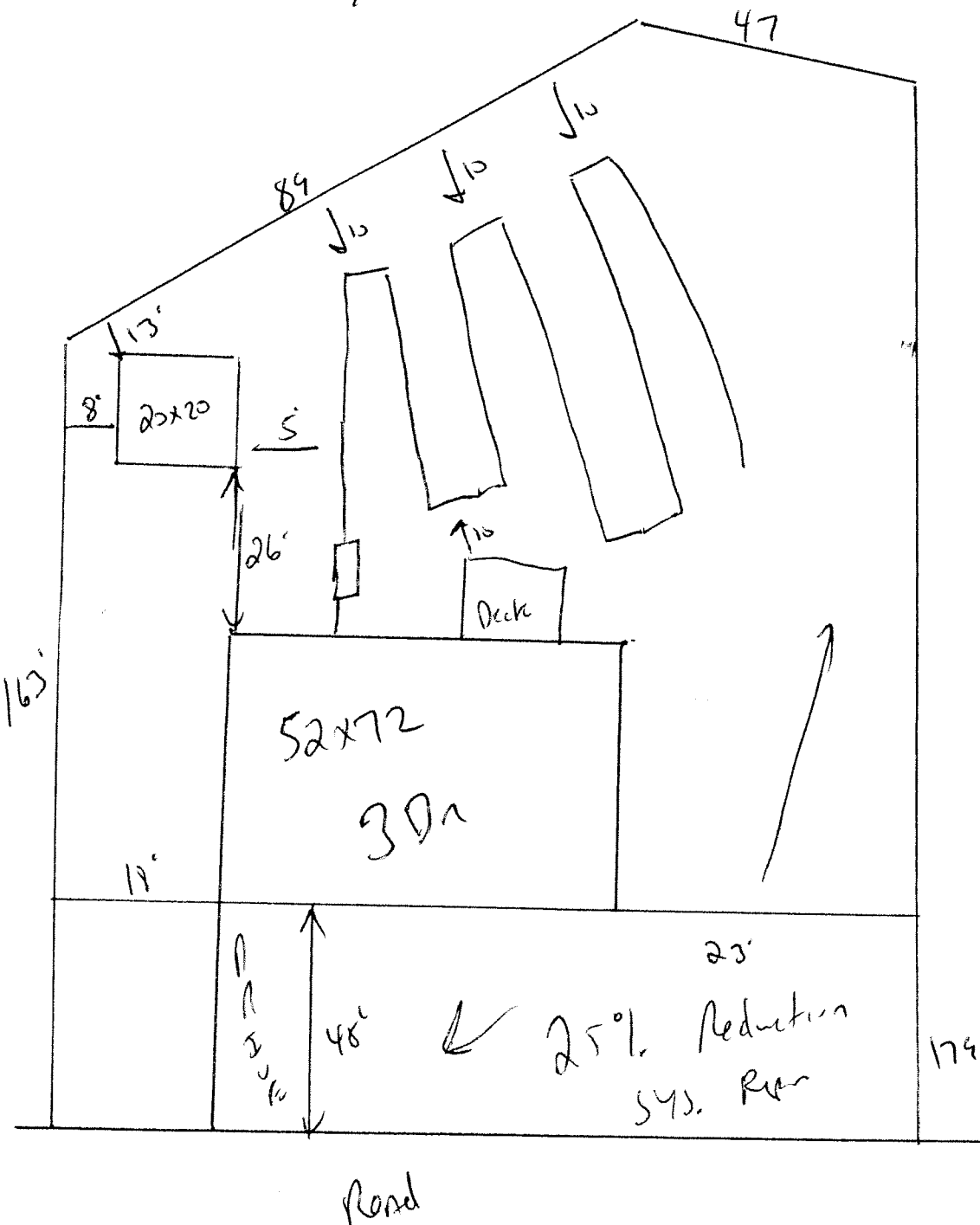

Meet onsite
 maintain all
 set backs
 Install
 180 & 25%
 Reduction system
 Do not drive
 or park on
 any part of
 Septic system