

Improvement Permit

A building permit cannot be issued with only an Improvement Permit

ISSUED TO: Kenneth Cummings
PROPERTY LOCATION: 1125
SUBDIVISION: Woodshire
LOT # 204
Type of Structure: SFD-60x41-4BR
Proposed Wastewater System Type: 25% Reduction Sys.
Projected Daily Flow: 480 GPD
Number of bedrooms: 4 Number of Occupants: 8 max
Basement: No
Pump Required: May be required based on final location and elevations of facilities
Type of Water Supply: Public
Permit conditions: Meet onsite - maintain all set STUB out plumbing shallow at ground level or higher

Authorized State Agent: J. W. [Signature] Date: 10-14-08 SEE ATTACHED SITE SKETCH
The issuance of this permit by the Health Department in no way guarantees the issuance of other permits. The permit holder is responsible for checking with appropriate governing bodies in meeting their requirements. This site is subject to revocation if the site plan, plat, or the intended use changes. The Improvement Permit shall not be affected by a change in ownership of the site. This permit is subject to compliance with the provisions of the Laws and Rules for Sewage Treatment and Disposal and to conditions of this permit.

Construction Authorization

(Required for Building Permit)

The construction and installation requirements of Rules .1950, .1952, .1954, .1955, .1956, .1957, .1958, and .1959 are incorporated by references into this permit and shall be met. Systems shall be installed in accordance with the attached system layout.

ISSUED TO: Kenneth Cummings
PROPERTY LOCATION: 1125
SUBDIVISION: Woodshire
LOT # 204
Facility Type: SFD-60x41-4BR New
Basement? No
Type of Wastewater System: 25% Reduction system (Initial) Wastewater Flow: 480 GPD
(See note below, if applicable) 25% Reduction sys. (Repair)

Installation Requirements/Conditions
Septic Tank Size: 1000 gallons
Pump Tank Size: [blank] gallons
Number of trenches: 1
Exact length of each trench: 24.0 feet
Trench Spacing: 9 Feet on Center
Soil Cover: 4 inches
Maximum Trench Depth of: 18-24 inches
Pump Requirements: [blank] ft. TDH vs. [blank] GPM
Aggregate Depth: [blank] inches below pipe, [blank] inches above pipe, [blank] inches total

\*\*If applicable: I understand the system type specified is different from the type specified on the application. I accept the specifications of this permit.
Owner/Legal Representative Signature: [Signature] Date: [blank]

This Construction Authorization is subject to revocation if the site plan, plat, or the intended use changes. The Construction Authorization shall not be transferred when there is a change in ownership of the site. This Construction Authorization is subject to compliance with the provisions of the Laws and Rules for Sewage Treatment and Disposal and to the conditions of this permit. SEE ATTACHED SITE SKETCH
Authorized State Agent: J. W. [Signature] Date: 10-14-08
Construction Authorization Expiration Date: 10-14-2013

HTE# 08-500-19301RR

Permit # 25078

# Harnett County Department of Public Health Site Sketch

ISSUED TO: Kenneth Cummings

PROPERTY LOCATOR: 1125  
SUBDIVISION Woodshire

LOT # 204

Authorized State Agent: J. Lee

Date: 10-14-08

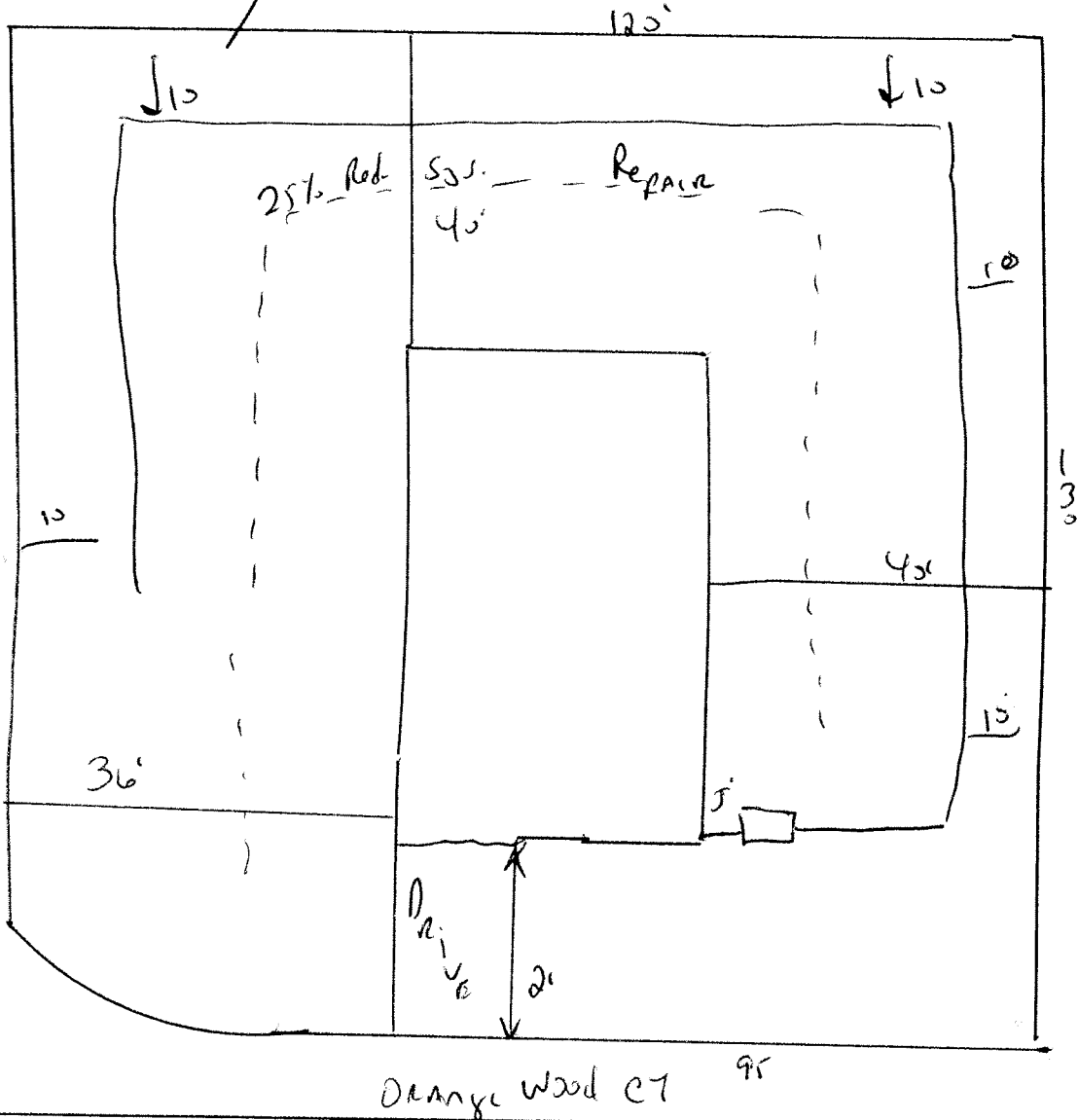

Must onsite maintain all setbacks

STUB out plumbing shallow at ground level or higher where shown

INSTALL 24" of 25% Reduction system at 18 to 24"