

Improvement Permit

A building permit cannot be issued with only an Improvement Permit

ISSUED TO: CAVINSON LAND PROPERTY LOCATION: 1125
 NEW REPAIR EXPANSION SUBDIVISION: FOREST OAKS LOT # 149
 Type of Structure: SFD-44x50-3BR Site Improvements required prior to Construction Authorization Issuance:
 Proposed Wastewater System Type: 25% Reduction System
 Projected Daily Flow: 360 GPD
 Number of bedrooms: 3 Number of Occupants: 6 max
 Basement Yes No
 Pump Required: Yes No May be required based on final location and elevations of facilities
 Type of Water Supply: Community Public Well Distance from well 100 feet Permit valid for: Five years
 Permit conditions: Meet on site for final layout maintain all setbacks No expiration
Start out plumbing shallow at ground level or higher where shown

Authorized State Agent: Ju Lane Date: 08/21/08 SEE ATTACHED SITE SKETCH
 The issuance of this permit by the Health Department in no way guarantees the issuance of other permits. The permit holder is responsible for checking with appropriate governing bodies in meeting their requirements. This site is subject to revocation if the site plan, plat, or the intended use changes. The Improvement Permit shall not be affected by a change in ownership of the site. This permit is subject to compliance with the provisions of the Laws and Rules for Sewage Treatment and Disposal and to conditions of this permit.

Construction Authorization

(Required for Building Permit)

The construction and installation requirements of Rules .1950, .1952, .1954, .1955, .1956, .1957, .1958, and .1959 are incorporated by references into this permit and shall be met. Systems shall be installed in accordance with the attached system layout.

ISSUED TO: CAVINSON LAND PROPERTY LOCATION: 1125
 SUBDIVISION: FOREST OAKS LOT # 149
 Facility Type: SFD-44x50-3BR New Expansion Repair
 Basement? Yes No Basement Fixtures? Yes No
 Type of Wastewater System** 25% Reduction System (Initial) Wastewater Flow: 360 GPD
 (See note below, if applicable)
25% Reduction System (Repair)

Installation Requirements/Conditions

Septic Tank Size <u>1000</u> gallons	Number of trenches <u>1</u>	Exact length of each trench <u>180</u> feet	Trench Spacing: <u>9</u> Feet on Center
Pump Tank Size _____ gallons	Trenches shall be installed on contour at a	Maximum Trench Depth of: <u>18</u> inches	Soil Cover: <u>6</u> inches
	in all directions)	(Trench bottoms shall be level to +/-1/4"	(Maximum soil cover shall not exceed 36" above the trench bottom)

Pump Requirements: _____ ft. TDH vs. _____ GPM _____ inches below pipe
 Aggregate Depth: _____ inches above pipe
 Conditions: _____ inches total

**If applicable: I understand the system type specified is different from the type specified on the application. I accept the specifications of this permit.

Owner/Legal Representative Signature: _____ Date: _____

This Construction Authorization is subject to revocation if the site plan, plat, or the intended use changes. The Construction Authorization shall not be transferred when there is a change in ownership of the site. This Construction Authorization is subject to compliance with the provisions of the Laws and Rules for Sewage Treatment and Disposal and to the conditions of this permit. SEE ATTACHED SITE SKETCH

Authorized State Agent: Ju Lane Date: 08/21/08
 Construction Authorization Expiration Date: 08-21-2013

HTE# 08-500-19296RR

Permit # 24975

Harnett County Department of Public Health Site Sketch

ISSUED TO: CAVIN'S Land

PROPERTY LOCATOR: 1125

SUBDIVISION: FOREST OAKS

LOT # 145

Authorized State Agent: J. LAW

Date: 08-21-08

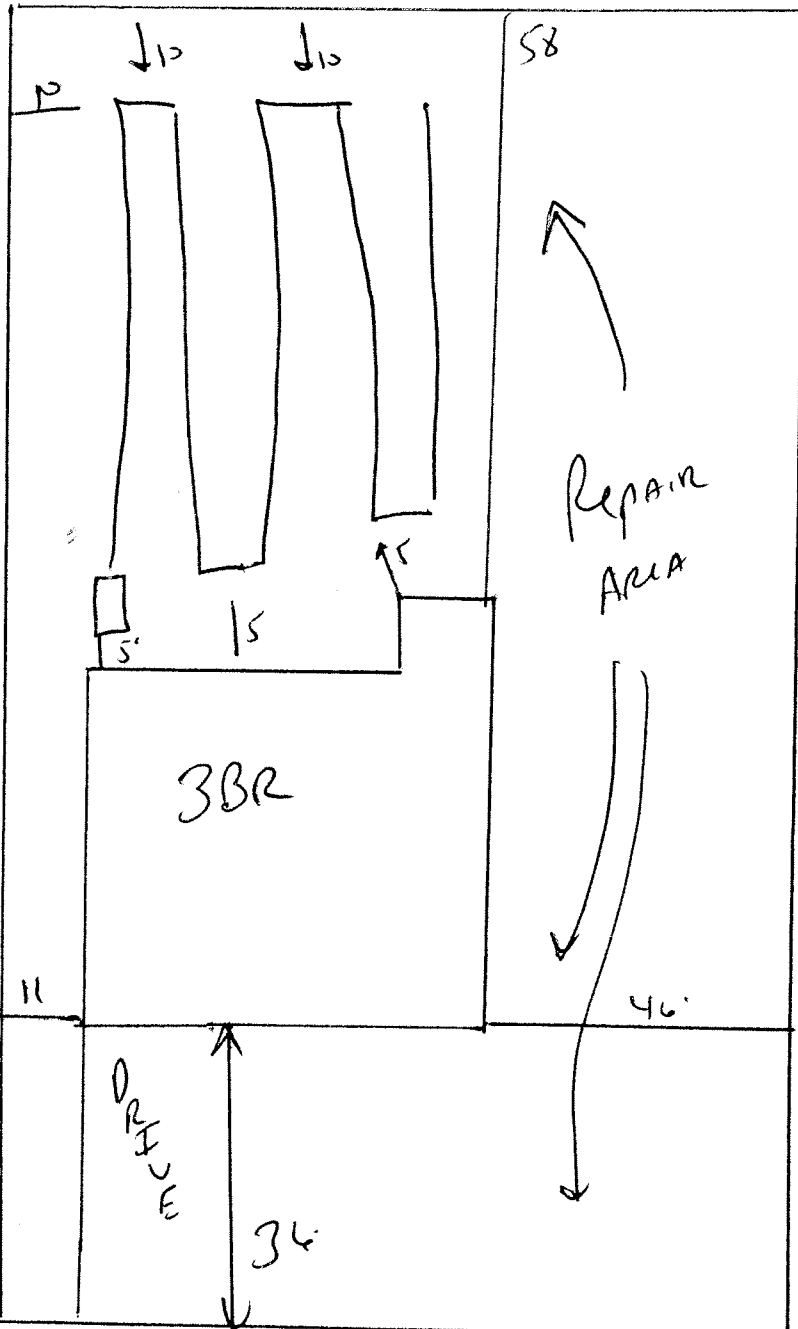

meet onsite
 maintain all
 set backs
 stub out plumbing
 shallow, at ground
 level or higher where
 shown.
 install 180' of 2 1/2"
 reduction system at 18"

RA