

Improvement Permit

A building permit cannot be issued with only an Improvement Permit

ISSUED TO: CAVNESS Land Dev. PROPERTY LOCATION: 1125
 NEW REPAIR EXPANSION SUBDIVISION: FOREST OAKS LOT # 148
 Type of Structure: SFD- 35x22 3BR max Site Improvements required prior to Construction Authorization Issuance:
 Proposed Wastewater System Type: Pump to 2' wide chamber
 Projected Daily Flow: 360 max GPD
 Number of bedrooms: 3 max Number of Occupants: 6 max
 Basement Yes No
 Pump Required: Yes No May be required based on final location and elevations of facilities
 Type of Water Supply: Community Public Well Distance from well 100 feet Permit valid for: Five years
 Permit conditions: Met onsite maintain All Set Backs No expiration

Authorized State Agent: Ja L. W. [Signature] Date: 10-17-08 SEE ATTACHED SITE SKETCH

The issuance of this permit by the Health Department in no way guarantees the issuance of other permits. The permit holder is responsible for checking with appropriate governing bodies in meeting their requirements. This site is subject to revocation if the site plan, plat, or the intended use changes. The Improvement Permit shall not be affected by a change in ownership of the site. This permit is subject to compliance with the provisions of the Laws and Rules for Sewage Treatment and Disposal and to conditions of this permit.

Construction Authorization

(Required for Building Permit)

The construction and installation requirements of Rules .1950, .1952, .1954, .1955, .1956, .1957, .1958, and .1959 are incorporated by references into this permit and shall be met. Systems shall be installed in accordance with the attached system layout.

ISSUED TO: CAVNESS Land Dev. PROPERTY LOCATION: 1125
 SUBDIVISION: FOREST OAKS LOT # 148
 Facility Type: SFD- 39x22 - 3BR max New Expansion Repair
 Basement? Yes No Basement Fixtures? Yes No
 Type of Wastewater System** Pump to 2' wide chamber (Initial) Wastewater Flow: 360 max GPD
 (See note below, if applicable) 2' wide chamber (Repair)

Installation Requirements/Conditions
 Septic Tank Size 1000 gallons Number of trenches 1
 Pump Tank Size 1000 gallons Exact length of each trench 300 feet Trench Spacing: 87 Feet on Center
 Trenches shall be installed on contour at a Soil Cover: 6 inches
 Maximum Trench Depth of: 18 inches (Maximum soil cover shall not exceed 36" above the trench bottom)
 in all directions)
 Pump Requirements: _____ ft. TDH vs. _____ GPM _____ inches below pipe
 Aggregate Depth: _____ inches above pipe
 Conditions: _____ inches total

**If applicable: I understand the system type specified is different from the type specified on the application. I accept the specifications of this permit.

Owner/Legal Representative Signature: _____ Date: _____

This Construction Authorization is subject to revocation if the site plan, plat, or the intended use changes. The Construction Authorization shall not be transferred when there is a change in ownership of the site. This Construction Authorization is subject to compliance with the provisions of the Laws and Rules for Sewage Treatment and Disposal and to the conditions of this permit. SEE ATTACHED SITE SKETCH

Authorized State Agent: Ja L. W. [Signature] Date: 10-17-08
 Construction Authorization Expiration Date: 10-17-2013

HTE# 08-500-19295RR

Permit # 25085

Harnett County Department of Public Health Site Sketch

ISSUED TO: Caviness Land

PROPERTY LOCATOR: 1125

SUBDIVISION FOREST OAKS

LOT # 148

Authorized State Agent: J. W. ARS

Date: 10-17-08

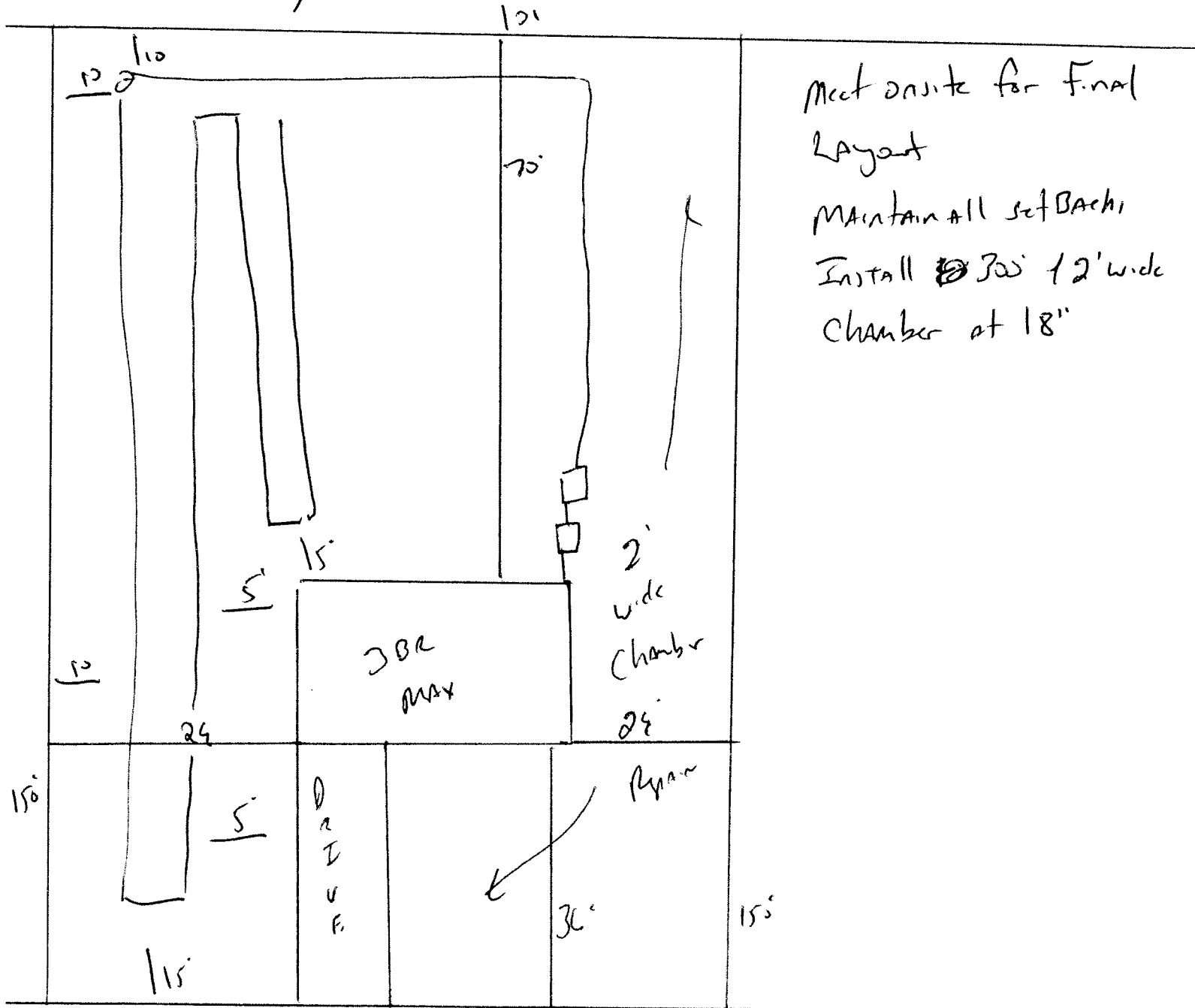

Meet onsite for final
Layout
Maintain all set back
Install 30' x 12' wide
Chamber at 18"

Road 101