

HTE# 08-500-19293
RRR

Harnett County Department of Public Health

25356

Improvement Permit

A building permit cannot be issued with only an Improvement Permit

ISSUED TO: CAVINESS LAND PROPERTY LOCATION: 1125
SUBDIVISION: FOREST OAKS LOT # 146

NEW REPAIR EXPANSION
Type of Structure: SFD-50x51-3BR MAX
Proposed Wastewater System Type: 25% Reduction Sys.
Projected Daily Flow: 360 GPD MAX
Number of bedrooms: 3 max Number of Occupants: 6 max
Basement Yes No

Site Improvements required prior to Construction Authorization Issuance:

Pump Required: Yes No May be required based on final location and elevations of facilities

Type of Water Supply: Community Public Well Distance from well 100 feet

Permit valid for: Five years
 No expiration

Permit conditions: Meet on site for final layout maintain all setbacks
Stub out plumbing shallow at ground level or higher where shown.

Install Drain Lines Below the Fill Line in natural Soil Install French Drain

Authorized State Agent: Ju WARS Date: 02-26-09 SEE ATTACHED SITE SKETCH

The issuance of this permit by the Health Department in no way guarantees the issuance of other permits. The permit holder is responsible for checking with appropriate governing bodies in meeting their requirements. This site is subject to revocation if the site plan, plat, or the intended use changes. The Improvement Permit shall not be affected by a change in ownership of the site. This permit is subject to compliance with the provisions of the Laws and Rules for Sewage Treatment and Disposal and to conditions of this permit.

Construction Authorization

(Required for Building Permit)

The construction and installation requirements of Rules .1950, .1952, .1954, .1955, .1956, .1957, .1958, and .1959 are incorporated by references into this permit and shall be met. Systems shall be installed in accordance with the attached system layout.

ISSUED TO: CAVINESS LAND PROPERTY LOCATION: 1125
SUBDIVISION: FOREST OAKS LOT # 146

Facility Type: SFD-50x51-3BR MAX New Expansion Repair

Basement? Yes No Basement Fixtures? Yes No

Type of Wastewater System** 25% Reduction system (Initial) Wastewater Flow: 360 GPD
(See note below, if applicable 25% Reduction system (Repair) MAX)

Installation Requirements/Conditions

Septic Tank Size 1000 gallons

Pump Tank Size _____ gallons

Number of trenches 1

Exact length of each trench 240 feet

Trenches shall be installed on contour at a

Maximum Trench Depth of: 18 inches

(Trench bottoms shall be level to +/- 1/4" in all directions)

Trench Spacing: 9 Feet on Center

Soil Cover: 6 inches

(Maximum soil cover shall not exceed 36" above the trench bottom)

Pump Requirements: _____ ft. TDH vs. _____ GPM

Aggregate Depth: _____ inches below pipe

_____ inches above pipe

_____ inches total

Conditions: Drain Lines must be Below The Fill

**If applicable: I understand the system type specified is different from the type specified on the application. I accept the specifications of this permit.

Owner/Legal Representative Signature: _____ Date: _____

This Construction Authorization is subject to revocation if the site plan, plat, or the intended use changes. The Construction Authorization shall not be transferred when there is a change in ownership of the site. This

Construction Authorization is subject to compliance with the provisions of the Laws and Rules for Sewage Treatment and Disposal and to the conditions of this permit.

SEE ATTACHED SITE SKETCH

Authorized State Agent: Ju WARS Date: 02-26-09

Construction Authorization Expiration Date: 02-26-2014

HTE# 08-500-019293 RRR

Permit # 25356

Harnett County Department of Public Health Site Sketch

ISSUED TO: CAUNESS Land

PROPERTY LOCATOR: 1125

SUBDIVISION: FOREST OAKS

LOT # 146

Authorized State Agent: *Jim Lars*

Date: 02.26.09

Meet onsite for Final Layout

MAINTAIN ALL SETBACKS

STUB OUT Plumbing shall be at ground level or higher where shown
INSTALL French DRAIN 36 to 48" Deep - may require French drain to be deeper
Gravel to within 6" of top of the ground

INSTALL 240' of 25% Reduction system BELOW F.I.L. - Top of Drain Line Ditches
Must be in natural soil not F.I.L.

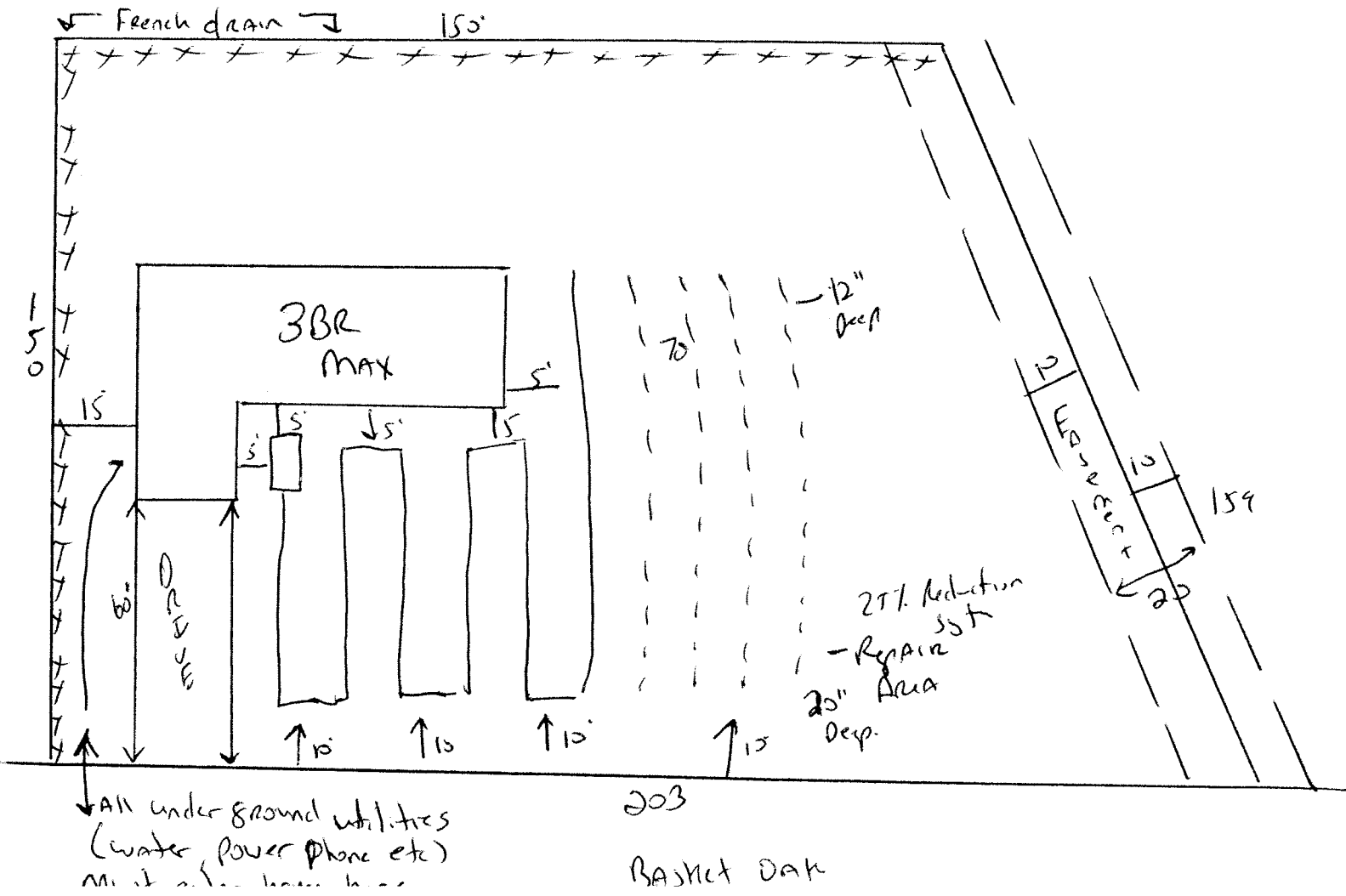

Caviness Land Development

SITE PLAN APPROVAL
 DISTRICT RA 201 USE SFD
 #BEDROOMS 3
 Date 2-18-09 Zoning Administrator N. Caldwell

Front Driv

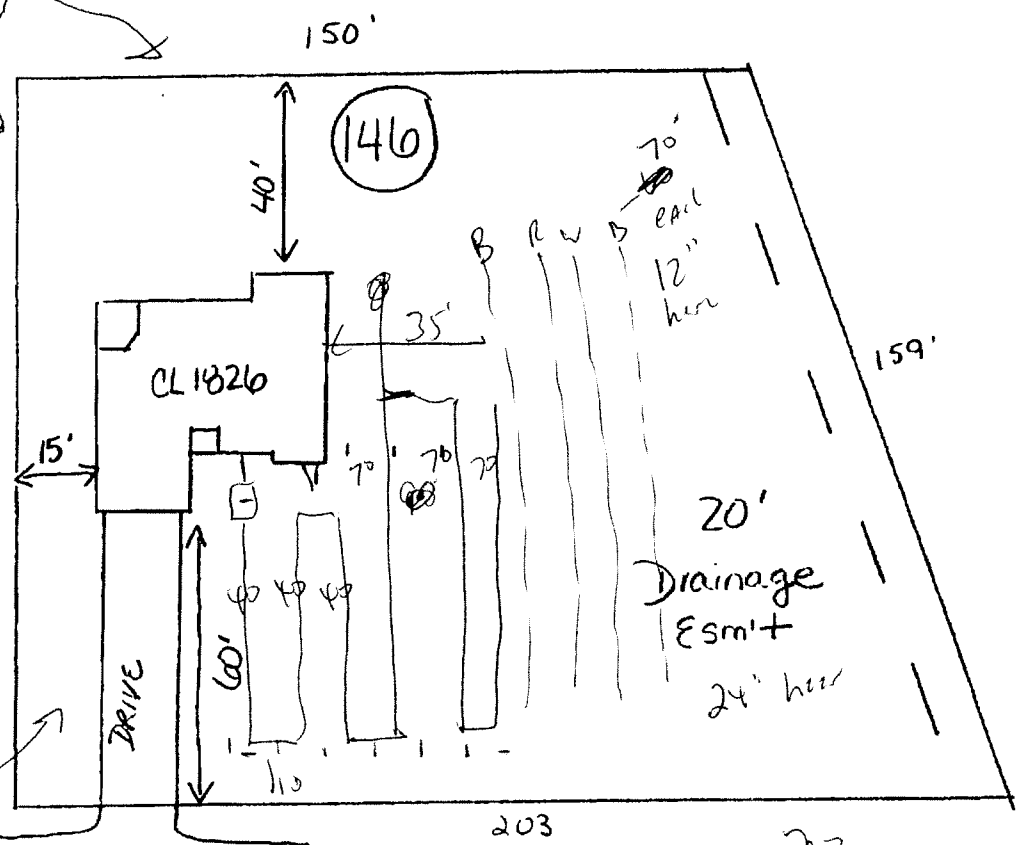

use box size
 50.7 ←→
 51.8 ↓
 All setback ends here
 front setback

Basket Oak DR.
 60' RW

$$\begin{array}{r} 270 \\ 120 \\ \hline 390 \end{array}$$

Forest Oaks Phase Three

1x240
 w/ 57' W
 Bkgp 50ft
 Below Fill