

08-500-19287RR **Improvement Permit**

A building permit cannot be issued with only an Improvement Permit

ISSUED TO: Caviness Land PROPERTY LOCATION: 1125
 NEW REPAIR EXPANSION SUBDIVISION: FOREST OAKS LOT # 113
 Type of Structure: SFD - 40x44 - 3BR Site Improvements required prior to Construction Authorization Issuance: Changed to 40x44 3BR
 Proposed Wastewater System Type: 25% Reduction System
 Projected Daily Flow: 360 GPD on 05-06-08
 Number of bedrooms: 3 Number of Occupants: 6 max
 Basement Yes No
 Pump Required: Yes No May be required based on final location and elevations of facilities
 Type of Water Supply: Community Public Well Distance from well 50 feet Permit valid for: Five years
 Permit conditions: STUB out Plumbing, shallow, at ground level or higher where shown, maintain ALL SET BACKS meet on site No expiration
Revised 05-06-08

Authorized State Agent: J. L. [Signature] Date: 04-29-08 SEE ATTACHED SITE SKETCH
 The issuance of this permit by the Health Department in no way guarantees the issuance of other permits. The permit holder is responsible for checking with appropriate governing bodies in meeting their requirements. This site is subject to revocation if the site plan, plat, or the intended use changes. The Improvement Permit shall not be affected by a change in ownership of the site. This permit is subject to compliance with the provisions of the Laws and Rules for Sewage Treatment and Disposal and to conditions of this permit.

Construction Authorization

(Required for Building Permit)

The construction and installation requirements of Rules .1950, .1952, .1954, .1955, .1956, .1957, .1958, and .1959 are incorporated by references into this permit and shall be met. Systems shall be installed in accordance with the attached system layout.

ISSUED TO: Caviness Land PROPERTY LOCATION: 1125
40x44-3BR SUBDIVISION: FOREST OAKS LOT # 113
 Facility Type: SFD - 40x44 - 3BR New Expansion Repair
 Basement? Yes No Basement Fixtures? Yes No 360
 Type of Wastewater System** 25% Reduction System (Initial) Wastewater Flow: 360 GPD
 (See note below, if applicable) LPP Repair (Repair)

Installation Requirements/Conditions

Septic Tank Size 1000 gallons Number of trenches 1 180
 Pump Tank Size _____ gallons Exact length of each trench 180 feet Trench Spacing: 9 Feet on Center
 Trenches shall be installed on contour at a Soil Cover: 6 inches
 Maximum Trench Depth of: 1824 inches (Maximum soil cover shall not exceed 36" above the trench bottom)
 (Trench bottoms shall be level to +/- 1/4" in all directions)
 Pump Requirements: _____ ft. TDH vs. _____ GPM _____ inches below pipe
 Aggregate Depth: _____ inches above pipe
 Conditions: _____ inches total

**If applicable: I understand the system type specified is different from the type specified on the application. I accept the specifications of this permit.
 Owner/Legal Representative Signature: _____ Date: _____

This Construction Authorization is subject to revocation if the site plan, plat, or the intended use changes. The Construction Authorization shall not be transferred when there is a change in ownership of the site. This Construction Authorization is subject to compliance with the provisions of the Laws and Rules for Sewage Treatment and Disposal and to the conditions of this permit. SEE ATTACHED SITE SKETCH

Authorized State Agent: J. L. [Signature] Date: 04-29-08 Revised 05-06-08
 Construction Authorization Expiration Date: 04-29-2013 05-06-2013

HTE# 08-500-19287RR

Permit # 24762

Harnett County Department of Public Health Site Sketch

ISSUED TO: CAVINCE LAND

PROPERTY LOCATOR: 1125

SUBDIVISION: FOREST OAKS

LOT # 113

Authorized State Agent: Jan [Signature]
101

Date: 0429-08

05-26-08

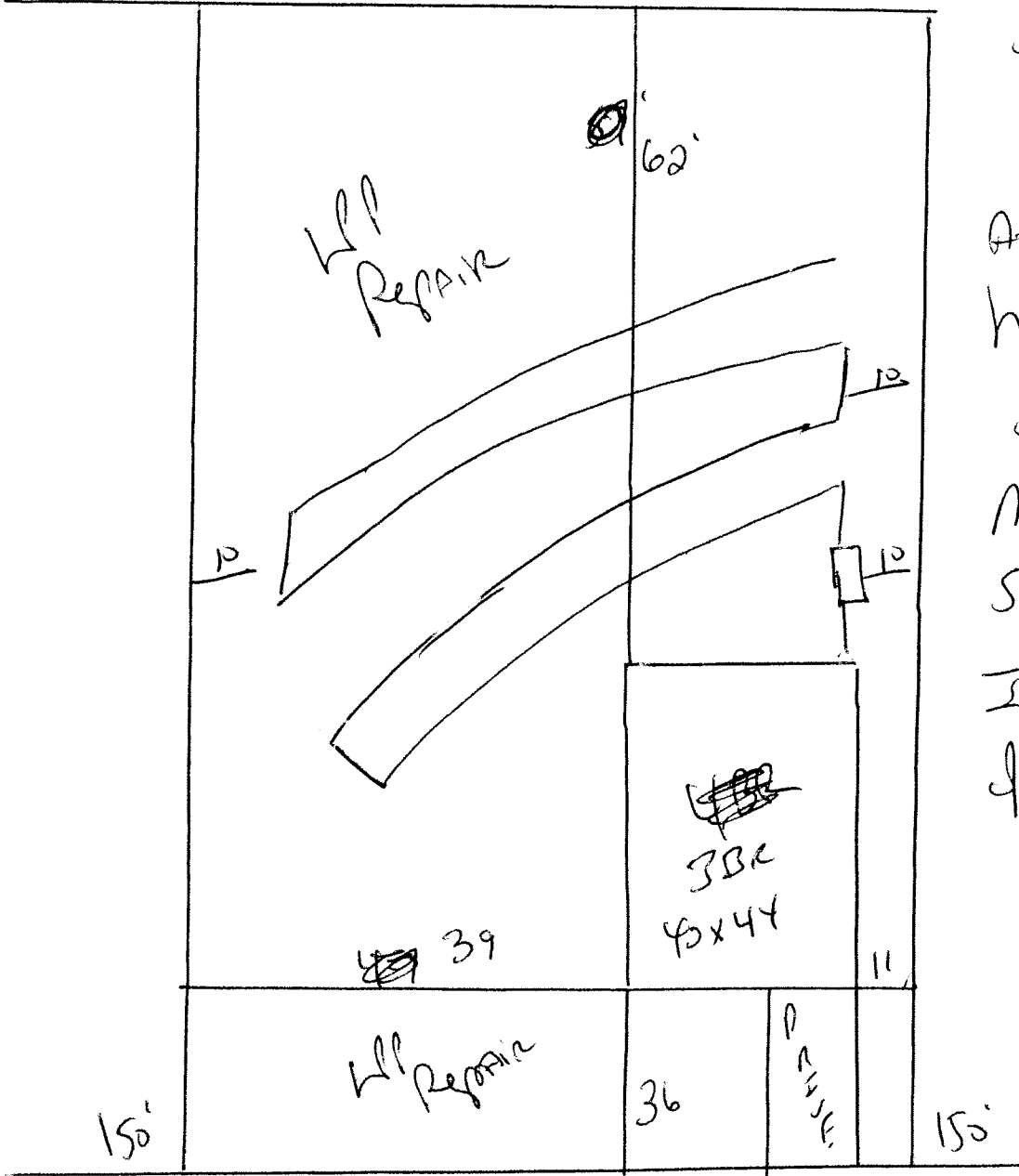

Stub out

Plumbing shall be
At ground level or
higher where
shown

MAINTAIN ALL
SetBACKS

Install ~~240'~~^{180'}
of 25% Reduction
System.

Revised to 3 Bed
Room 40x44
on 05-26-08

101

Basket Oak