

HTE# 08-5-192572

Harris County Department of Public Health

24609

Improvement Permit

A building permit cannot be issued with only an Improvement Permit

ISSUED TO: HAMILTON BUILDERS PROPERTY LOCATION: SR 1434 JOHNSON RD
 NEW REPAIR EXPANSION SUBDIVISION: JOHNSON FARMS LOT # 2
 Type of Structure: SFD Site Improvements required prior to Construction Authorization Issuance: _____
 Proposed Wastewater System Type: 25% DISTRIBUTION SYSTEM
 Projected Daily Flow: 360 GPD
 Number of bedrooms: 3 Number of Occupants: 6 max
 Basement Yes No
 Pump Required: Yes No May be required based on final location and elevations of facilities
 Type of Water Supply: Community Public Well Distance from well _____ feet Permit valid for: Five years
 Permit conditions: _____ No expiration

Authorized State Agent: James E. Markantanz Date: 3-12-08 SEE ATTACHED SITE SKETCH
 The issuance of this permit by the Health Department in no way guarantees the issuance of other permits. The permit holder is responsible for checking with appropriate governing bodies in meeting their requirements. This site is subject to revocation if the site plan, plat, or the intended use changes. The Improvement Permit shall not be affected by a change in ownership of the site. This permit is subject to compliance with the provisions of the Laws and Rules for Sewage Treatment and Disposal and to conditions of this permit.

Construction Authorization

(Required for Building Permit)

The construction and installation requirements of Rules .1950, .1952, .1954, .1955, .1956, .1957, .1958, and .1959 are incorporated by references into this permit and shall be met. Systems shall be installed in accordance with the attached system layout.

ISSUED TO: HAMILTON BUILDERS INC PROPERTY LOCATION: SR 1434 JOHNSON RD
 SUBDIVISION: JOHNSON FARMS LOT # 2
 Facility Type: SFD New Expansion Repair
 Basement? Yes No Basement Fixtures? Yes No
 Type of Wastewater System** 25% DISTRIBUTION SYSTEM (initial) Wastewater Flow: 360 GPD
 (See note below, if applicable
UPPER FALL (Repair)

Installation Requirements/Conditions

Septic Tank Size 1000 gallons Exact length of each trench 4 x 70 feet Trench Spacing: 9 Feet on Center
 Pump Tank Size _____ gallons Trenches shall be installed on contour at a Soil Cover: 6 inches
 Maximum Trench Depth of: 28-20 inches (Maximum soil cover shall not exceed 36" above the trench bottom)
 (Trench bottoms shall be level to +1/4" in all directions)
 Pump Requirements: _____ ft. TDH vs. _____ GPM Aggregate Depth: 6 inches below pipe
 Conditions: _____ 2 inches above pipe
12 inches total

**If applicable: I understand the system type specified is different from the type specified on the application. I accept the specifications of this permit.

Owner/Legal Representative Signature: _____ Date: _____

This Construction Authorization is subject to revocation if the site plan, plat, or the intended use changes. The Construction Authorization shall not be transferred when there is a change in ownership of the site. This Construction Authorization is subject to compliance with the provisions of the Laws and Rules for Sewage Treatment and Disposal and to the conditions of this permit.

Authorized State Agent: James E. Markantanz Date: 3-12-08 SEE ATTACHED SITE SKETCH
 Construction Authorization Expiration Date: 3-12-13

HTE# 08-5-1923512

Permit # 24609

Harnett County Department of Public Health Site Sketch

PROPERTY LOCATOR: SR1434 JOHNSON RD

ISSUED TO: Hamilton Builders

SUBDIVISION JOHNSON FARMS

LOT # 2

Authorized State Agent: James E. Matthews

Date: 3-13-08

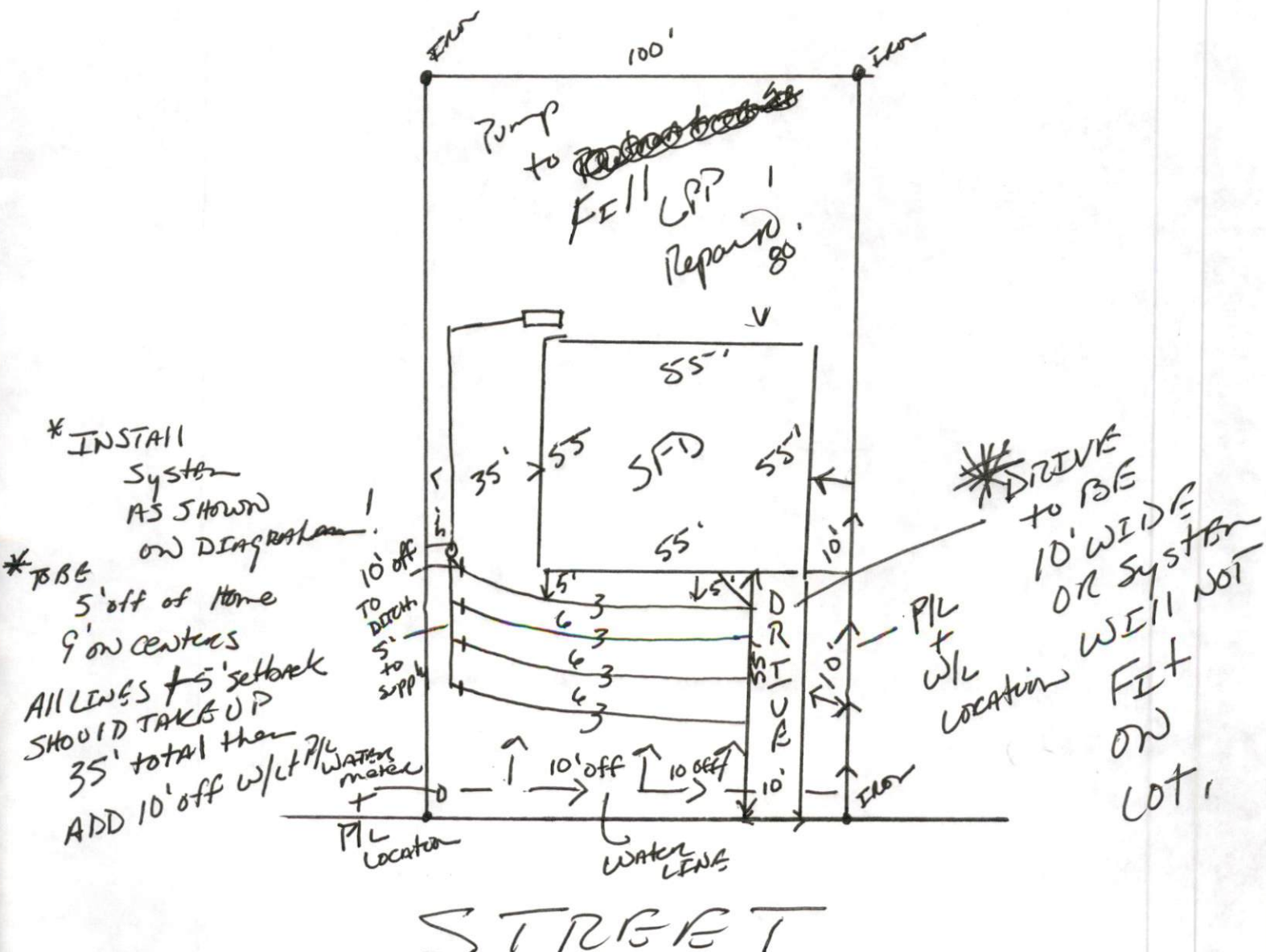

*INSTALL
System
AS SHOWN
ON DIAGRAM!

*BEE
5' off of Home
9' on centers
ALL LINES + 5' setback
SHOULD TAKE UP
35' TOTAL then
ADD 10' off w/lt P/L
WATER
meter
+
P/L
Location

DRIVE
to BE
10' WIDE
OR SYSTEM
WILL NOT
FIT
ON
LOT!

P/L
+
W/L
Location
WILL NOT
FIT
ON
LOT!

STREET