

Improvement Permit

A building permit cannot be issued with only an Improvement Permit

ISSUED TO: H&H Const. PROPERTY LOCATION: 1125 SUBDIVISION: Forest Oaks LOT # 159
Type of Structure: SFD-35x51 3BR
Proposed Wastewater System Type: Pump to 25% Reduction system
Projected Daily Flow: 360 max GPD
Number of bedrooms: 3 max Number of Occupants: 6 max
Basement: No
Pump Required: Yes
Type of Water Supply: Public
Permit conditions: Meet on site for final layout

Authorized State Agent: [Signature] Date: 05-27-09 SEE ATTACHED SITE SKETCH
The issuance of this permit by the Health Department in no way guarantees the issuance of other permits. The permit holder is responsible for checking with appropriate governing bodies in meeting their requirements. This site is subject to revocation if the site plan, plat, or the intended use changes. The Improvement Permit shall not be affected by a change in ownership of the site. This permit is subject to compliance with the provisions of the Laws and Rules for Sewage Treatment and Disposal and to conditions of this permit.

Construction Authorization

(Required for Building Permit)

The construction and installation requirements of Rules .1950, .1952, .1954, .1955, .1956, .1957, .1958, and .1959 are incorporated by references into this permit and shall be met. Systems shall be installed in accordance with the attached system layout.

ISSUED TO: H&H Const. PROPERTY LOCATION: 1125 SUBDIVISION: FOREST OAKS LOT # 159
Facility Type: SFD-35x51-3BR New
Basement: No
Type of Wastewater System: Pump to 25% Reduction system (Initial) Wastewater Flow: 360 GPD
(See note below, if applicable) Pump to 25% Reduction Sys. (Repair)

Installation Requirements/Conditions
Septic Tank Size: 1000 gallons
Pump Tank Size: 1000 gallons
Number of trenches: 1
Exact length of each trench: 180 feet
Trench Spacing: 9 Feet on Center
Soil Cover: 6 inches
Maximum Trench Depth: 18-24 inches
Aggregate Depth: inches below pipe, inches above pipe, inches total

**If applicable: I understand the system type specified is different from the type specified on the application. I accept the specifications of this permit.
Owner/Legal Representative Signature: Date:

This Construction Authorization is subject to revocation if the site plan, plat, or the intended use changes. The Construction Authorization shall not be transferred when there is a change in ownership of the site. This Construction Authorization is subject to compliance with the provisions of the Laws and Rules for Sewage Treatment and Disposal and to the conditions of this permit. SEE ATTACHED SITE SKETCH

Authorized State Agent: [Signature] Date: 05-27-09 06-30-09
Construction Authorization Expiration Date: 05-27-2013

HTE# 08500-19225RR

Permit # 25505

Harnett County Department of Public Health Site Sketch

ISSUED TO: HPH Const.

PROPERTY LOCATOR: 1125

SUBDIVISION FOREST OAKS

LOT # 159

Authorized State Agent:

J. L. [Signature]

Date: 05-27-09 06:30-09

NOTE All utilities must enter home here

Road 151

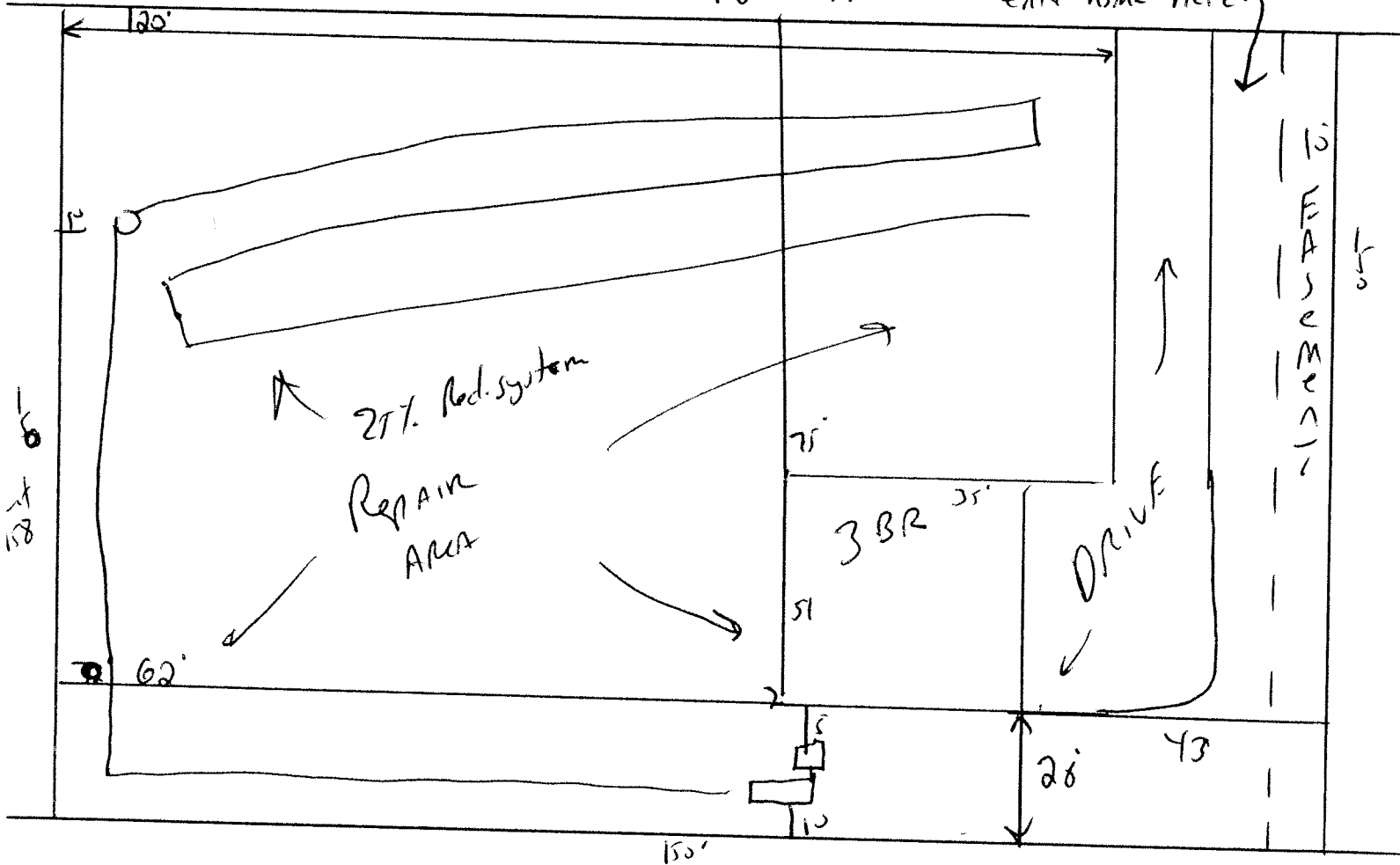

Meet onsite for Final layout

Maintain all set BACK

NOTE All utilities must Enter home as shown

INSTALL 180' of 25% Reduction system At 18"-24" Deep.