

HTE# 07-500-19043R

Harnett County Department of Public Health

24472

Improvement Permit

A building permit cannot be issued with only an Improvement Permit

ISSUED TO: Caviness Land PROPERTY LOCATION: 1125
 SUBDIVISION: FOREST OAKS LOT # 143
 NEW REPAIR EXPANSION
 Type of Structure: SFO-58x48-3BR Site Improvements required prior to Construction Authorization Issuance:
 Proposed Wastewater System Type: Pump to 25% Reduction sys.
 Projected Daily Flow: 360 GPD
 Number of bedrooms: 3 Number of Occupants: 6 max
 Basement Yes No
 Pump Required: Yes No May be required based on final location and elevations of facilities
 Type of Water Supply: Community Public Well Distance from well 50 feet Permit valid for: Five years
 Permit conditions: STUBOUT Plumbing where shown maintain all set backs meet onsite No expiration

Authorized State Agent: Ju Wani Date: 02-13-08 SEE ATTACHED SITE SKETCH
 The issuance of this permit by the Health Department in no way guarantees the issuance of other permits. The permit holder is responsible for checking with appropriate governing bodies in meeting their requirements. This site is subject to revocation if the site plan, plat, or the intended use changes. The Improvement Permit shall not be affected by a change in ownership of the site. This permit is subject to compliance with the provisions of the Laws and Rules for Sewage Treatment and Disposal and to conditions of this permit.

Construction Authorization

(Required for Building Permit)

The construction and installation requirements of Rules .1950, .1952, .1954, .1955, .1956, .1957, .1958, and .1959 are incorporated by references into this permit and shall be met. Systems shall be installed in accordance with the attached system layout.

ISSUED TO: Caviness Land PROPERTY LOCATION: 1125
 SUBDIVISION: FOREST OAKS LOT # 143
 Facility Type: SFO-58x48-3BR New Expansion Repair
 Basement? Yes No Basement Fixtures? Yes No
 Type of Wastewater System** Pump to 25% Red. sys. (Initial) Wastewater Flow: 360 GPD
 (See note below, if applicable 25% Reduction system (Repair))

Installation Requirements/Conditions

Septic Tank Size 1000 gallons Exact length of each trench 1x180 feet Trench Spacing: 9 Feet on Center
 Pump Tank Size 1000 gallons Trenches shall be installed on contour at a Soil Cover: 6 inches
 Maximum Trench Depth of: 18-24 inches (Maximum soil cover shall not exceed 36" above the trench bottom)
 (Trench bottoms shall be level to +1-1/4" in all directions)
 Pump Requirements: _____ ft. TDH vs. _____ GPM Aggregate Depth: _____ inches below pipe
 _____ inches above pipe
 _____ inches total
 Conditions: _____

**If applicable: *I understand the system type specified is different from the type specified on the application. I accept the specifications of this permit.*

Owner/Legal Representative Signature: _____ Date: _____

This Construction Authorization is subject to revocation if the site plan, plat, or the intended use changes. The Construction Authorization shall not be transferred when there is a change in ownership of the site. This Construction Authorization is subject to compliance with the provisions of the Laws and Rules for Sewage Treatment and Disposal and to the conditions of this permit.

Authorized State Agent: Ju Wani Date: 02-13-08 SEE ATTACHED SITE SKETCH
 Construction Authorization Expiration Date: 02-13-2013

HTE# 07-500-19243R

Permit # 24472

Harnett County Department of Public Health Site Sketch

ISSUED TO: CAVINESS LAND

PROPERTY LOCATOR: 1125

SUBDIVISION FOREST OAKS

LOT # 147

Authorized State Agent: [Signature]

Date: 02-17-08

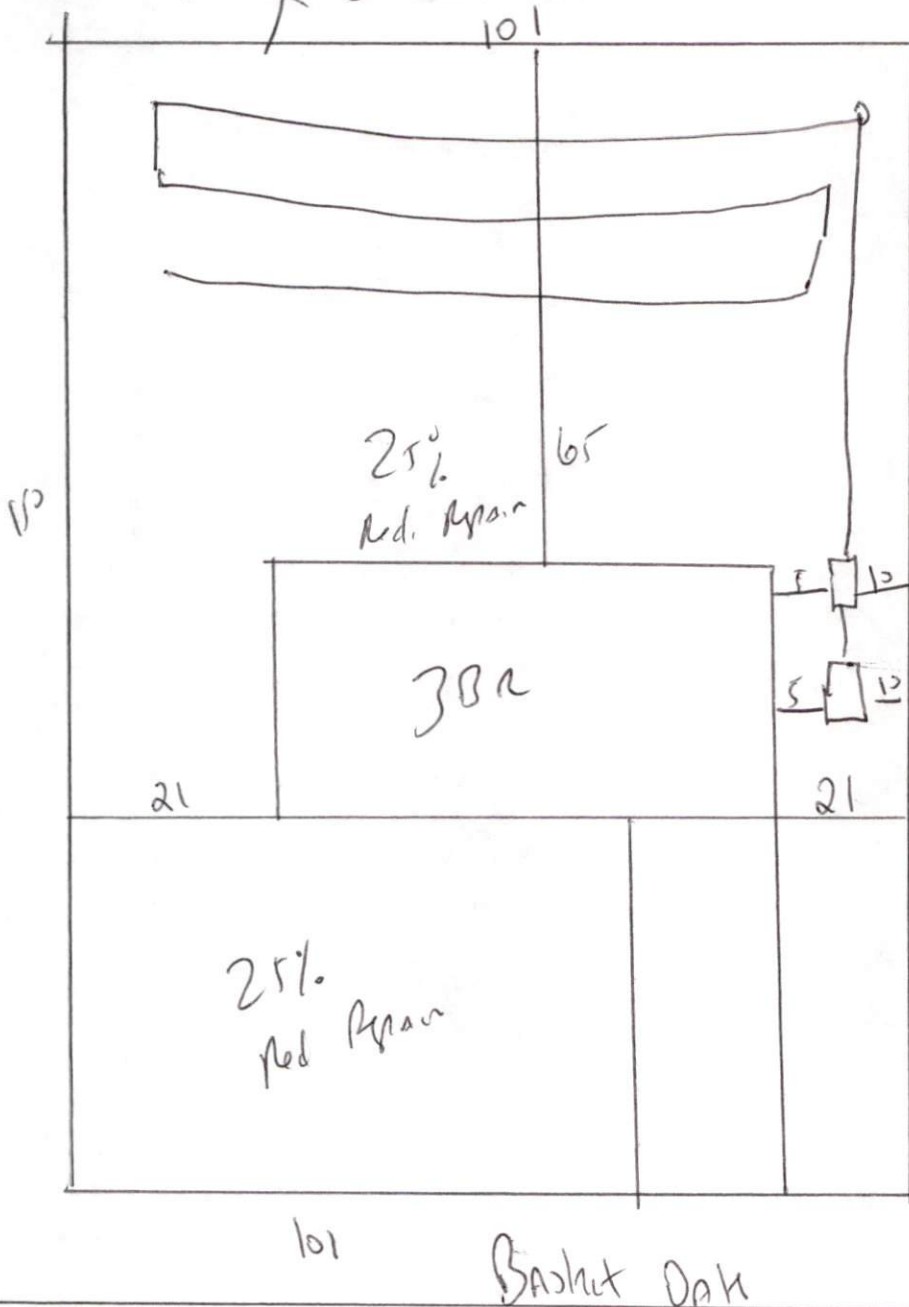

Stub out
Plumbing
Where shown

Maintain All

Set Back,

Install

X180 1
25% Reduction
system

At 18 to 24