

HTE# 07-5-18887

Harrick County Department of Public Health

24563

Improvement Permit

A building permit cannot be issued with only an Improvement Permit

ISSUED TO: Scott Lee Homes
PROPERTY LOCATION: SR 1452 Truveland Rd
SUBDIVISION: Jonathan Ridge LOT # 17
NEW [X] REPAIR [] EXPANSION []
Type of Structure: SFD 50' x 40'
Proposed Wastewater System Type: Pump to Accepted System
Projected Daily Flow: 360 GPD
Number of bedrooms: 3 Number of Occupants: 6 max
Basement [] Yes [X] No
Pump Required: [X] Yes [] No [] May be required based on final location and elevations of facilities
Type of Water Supply: [] Community [X] Public [] Well Distance from well _____ feet
Permit valid for: [X] Five years [] No expiration
Permit conditions: _____

Authorized State Agent: Ryan M. Lewis, P.E. Date: 2/27/2008 SEE ATTACHED SITE SKETCH
The issuance of this permit by the Health Department in no way guarantees the issuance of other permits. The permit holder is responsible for checking with appropriate governing bodies in meeting their requirements. This site is subject to revocation if the site plan, plat, or the intended use changes. The Improvement Permit shall not be affected by a change in ownership of the site. This permit is subject to compliance with the provisions of the Laws and Rules for Sewage Treatment and Disposal and to conditions of this permit.

Construction Authorization

(Required for Building Permit)

The construction and installation requirements of Rules .1950, .1952, .1954, .1955, .1956, .1957, .1958, and .1959 are incorporated by references into this permit and shall be met. Systems shall be installed in accordance with the attached system layout.

ISSUED TO: Scott Lee Homes
PROPERTY LOCATION: SR 1452
SUBDIVISION: Jonathan Ridge LOT # 17
Facility Type: SFD 50' x 40' [X] New [] Expansion [] Repair
Basement? [] Yes [X] No Basement Fixtures? [] Yes [] No
Type of Wastewater System: Pump to Accepted Sys. (Initial) Wastewater Flow: 360 GPD
(See note below, if applicable [])
Drip NO Pretreatment (Repair)

Installation Requirements/Conditions

Septic Tank Size 1000 gallons Exact length of each trench 1 x 225 feet Trench Spacing: 9 Feet on Center
Pump Tank Size 1000 gallons Trenches shall be installed on contour at a Soil Cover: 6 inches
Maximum Trench Depth of: 12 inches (Maximum soil cover shall not exceed 36" above the trench bottom)
in all directions)

Pump Requirements: _____ ft. TDH vs. _____ GPM _____ inches below pipe
Aggregate Depth: _____ inches above pipe

Conditions: Ditches to be NO DEEPER than 12 inches & run on contour
6 inches of cover required over system Contractor to call before starting system

**If applicable: I understand the system type specified is different from the type specified on the application. I accept the specifications of this permit.

Owner/Legal Representative Signature: _____ Date: _____

This Construction Authorization is subject to revocation if the site plan, plat, or the intended use changes. The Construction Authorization shall not be transferred when there is a change in ownership of the site. This Construction Authorization is subject to compliance with the provisions of the Laws and Rules for Sewage Treatment and Disposal and to the conditions of this permit.

Authorized State Agent: Ryan M. Lewis, P.E. Date: 2/27/2008 SEE ATTACHED SITE SKETCH
Construction Authorization Expiration Date: 2/27/2013

HTE# 07-5-18887

Permit # 24563

Harnett County Department of Public Health Site Sketch

ISSUED TO: Scott Lee Homes PROPERTY LOCATOR: SR 1452 True Love Rd.
SUBDIVISION Jonathan Ridge LOT # 17

Authorized State Agent: Bryan McLean, R.S. Date: 2/27/2008

Line lengths

- ① 40'
- ② 55'
- ③ 70'
- ④ 25'
- ⑤ 35'

* Contractor to meet on site to verify system area

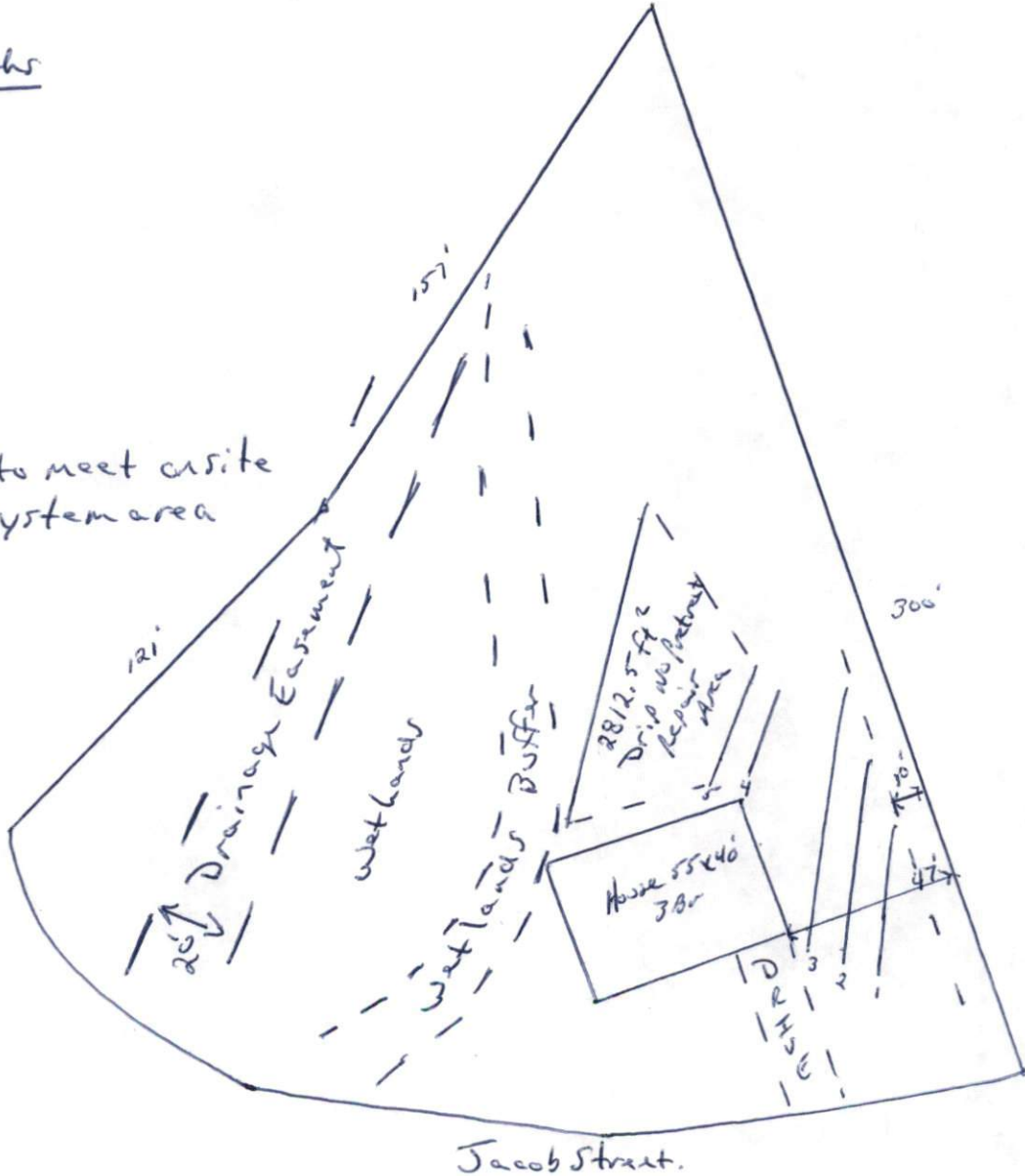

Jonathan Ridge Lots 17 + 1

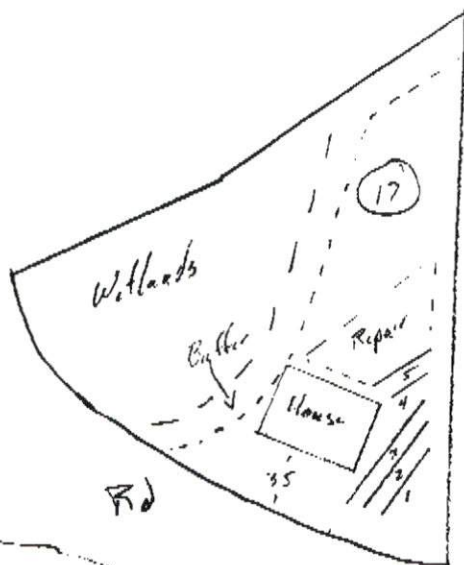

Lot 17 3BDRM 55x38
 .4 LTAR
 Initial 25% Reduction

	C	L
1	Y	40
2	B	55
3	R	70
4	Y	25
5	B	35

225' total

Repair - Drip No Pretreatment
 1800ft² - 2400ft²

Thomas/Bayer RS.
 L551241

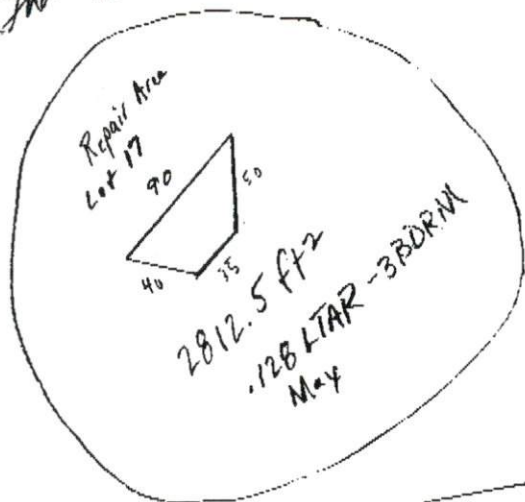

Lot 1 3BDRM 53'x54'
 .5 LTAR

	C	L	Initial Reduction
1	R	15	35% Reduction
2	B	25	
3	Y	25	Repair
4	R	70	25% Reduction
5	B	65	Accepted

