

9/07

11/19
5

A RECORDED SURVEY MAP, RECORDED DEED (OR OFFER TO PURCHASE) AND PLAT ARE REQUIRED WHEN APPLYING FOR LAND USE APPLICATION
Please use Blue or Black Ink ONLY

"This application expires 6 months from the initial date if no permits have been issued"

Signature of Owner or Owner's Agent

Date

11/6/67

If permits are granted I agree to conform to all ordinances and laws of the State of North Carolina regulating such work and the specifications of plans submitted. I hereby state that foregoing statements are accurate and correct to the best of my knowledge. Permit subject to revocation if false information is provided.

Required Residential Property Line Setbacks:

Front	Minimum	35	Actual	40' 36"
Rear		25		20' 8" 23' 11"
Closest Side		10		10' 44" 11'
Sidestreet/corner lot		-		-
Nearest Building		-		-
on same lot				

Comments:

Water Supply: County Well (No. dwellings) MUST have operable water before final

Sewage Supply: New Septic Tank (Complete New Tank Checks) Existing Septic Tank County Sewer

Property owner of this tract or land that contains a manufactured home w/in five hundred feet (500') of tract listed above? YES NO

Structures (existing or proposed): Single family dwellings Manufactured Homes Other (specify)

PROPOSED USE: SFD (Size 57 x 110) # Bedrooms 3 # Baths 2 1/2 Basement (w/w/o bath) Garage 24x24 Back patio Crawl Space / Slab

Mod (Size x) # Bedrooms x # Baths x Basement (w/w/o bath) Garage site built? Deck site built? ON Frame / OFF

Duplex No. Buildings No. Bedrooms/Unit

Manufactured Home: SW DW TW (Size x) # Bedrooms x Garage site built? Deck site built? # Employees x

Home Occupation Use # Rooms Use Hours of Operation: Employees

Addition/Accessory/Other (Size x) Use Closets in addition (yes) (no)

LANDOWNER: Cumberland Homes Mailing Address: PO Box 727 Home #: 910 892-4345 Contact #: 910 892-4345

APPLICANT: Cumberland Homes Mailing Address: Sum Home #: 28335 State: NC Zip: 28335 Contact #: 910 892-4345

PROPERTY LOCATION: Subdivision: Laurie Valley State Road #: 27W State Road Name: NC 27W Parcel: 031558 (015 1b)

Zoning: Map Flood Zone: X Watershed: N/L Deed Book & Page: 2395, 363-365

SPECIFIC DIRECTIONS TO THE PROPERTY FROM LILLINGTON: 27 West / TD in Laurie Valley Subd.

Map Book & Page: 2007-500 PIN: 9576-78-4387, 000 2007 1A19

Initial Application Date: 11/19/07 Application #: 0750018840R

CU

COUNTY OF HARNETT RESIDENTIAL LAND USE APPLICATION
Central Permitting 108 E. Front Street, Lillington, NC 27546 Phone: (910) 893-7525 Fax: (910) 893-2793 www.harnett.org

Env. Rec'd 11/20/07

**CUMBERLAND HOMES, INC.
 THE CAPE WITH SUNROOM
 LOT # 27 LAUREL VALLEY
 SCALE: 1"=50'**

SITE PLAN APPROVAL
 DISTRICT R120R
 #BEDROOMS 3 USE SFD
910 11/19/07
 ZONING ADMINISTRATOR

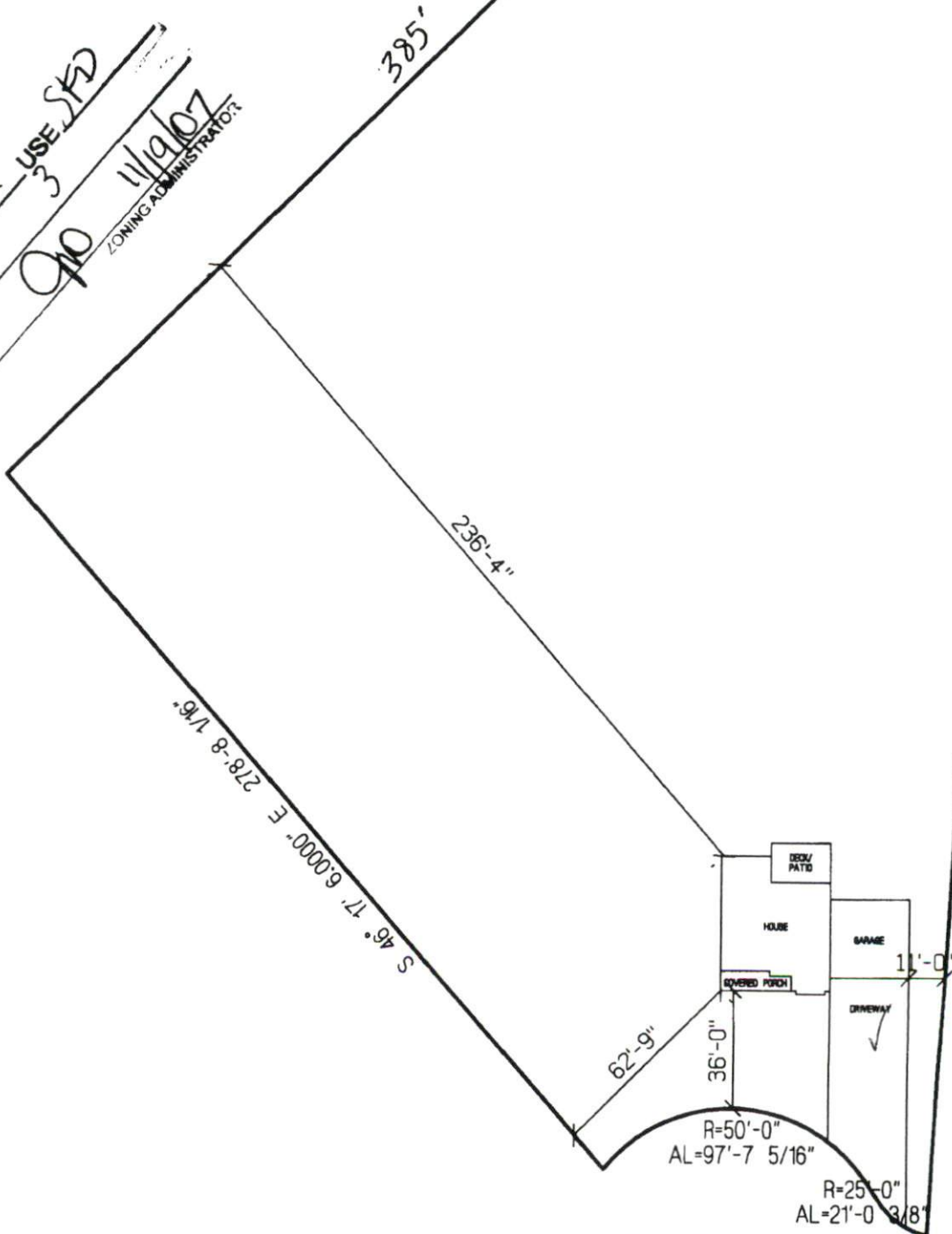

S 46° 17' 6.0000" E 278'-8 1/16"

43° 9' 1/16" W 2000' 9 1/16"

N 1° 43' 48.0000" W 474'-2 3/16"

WELSHIRE DRIVE