

HTE# 07-500-1800R

Harnett County Department of Public Health 24466

Improvement Permit

A building permit cannot be issued with only an Improvement Permit

ISSUED TO: H&H Const. PROPERTY LOCATION: 1125
 SUBDIVISION: FOREST OAKS LOT # 204
 NEW REPAIR EXPANSION
 Type of Structure: SFO - 48x48 3BR
 Proposed Wastewater System Type: 25% Reduction System
 Projected Daily Flow: 360 GPD
 Number of bedrooms: 3 Number of Occupants: 06 max
 Basement Yes No
 Pump Required: Yes No May be required based on final location and elevations of facilities
 Type of Water Supply: Community Public Well Distance from well 50 feet
 Permit conditions: STUB out Plumbing shallow, at ground level or higher where shown. MAINTAIN ALL SETBACKS Permit valid for: Five years No expiration

Authorized State Agent: J. LARS Date: 02-12-08 SEE ATTACHED SITE SKETCH
 The issuance of this permit by the Health Department in no way guarantees the issuance of other permits. The permit holder is responsible for checking with appropriate governing bodies in meeting their requirements. This site is subject to revocation if the site plan, plat, or the intended use changes. The Improvement Permit shall not be affected by a change in ownership of the site. This permit is subject to compliance with the provisions of the Laws and Rules for Sewage Treatment and Disposal and to conditions of this permit.

Construction Authorization

(Required for Building Permit)

The construction and installation requirements of Rules .1950, .1952, .1954, .1955, .1956, .1957, .1958, and .1959 are incorporated by references into this permit and shall be met. Systems shall be installed in accordance with the attached system layout.

ISSUED TO: H&H Const PROPERTY LOCATION: 1125
 SUBDIVISION: FOREST OAKS LOT # 204
 Facility Type: SFO - 48x48 - 3BR New Expansion Repair
 Basement? Yes No Basement Fixtures? Yes No
 Type of Wastewater System** 25% Reduction Sys (Initial) Wastewater Flow: _____ GPD
 (See note below, if applicable 25% Reduction Sys (Repair)

Installation Requirements/Conditions

Septic Tank Size 1000 gallons Exact length of each trench 1x225 feet Trench Spacing: 9 Feet on Center
 Pump Tank Size _____ gallons Trenches shall be installed on contour at a Soil Cover: 6 inches
 Maximum Trench Depth of: 18 inches (Maximum soil cover shall not exceed 36" above the trench bottom)
 (Trench bottoms shall be level to +/- 1/4" in all directions)
 Pump Requirements: _____ ft. TDH vs. _____ GPM Aggregate Depth: _____ inches below pipe
 Conditions: _____ inches above pipe
 _____ inches total

**If applicable: *I understand the system type specified is different from the type specified on the application. I accept the specifications of this permit.*

Owner/Legal Representative Signature: _____ Date: _____

This Construction Authorization is subject to revocation if the site plan, plat, or the intended use changes. The Construction Authorization shall not be transferred when there is a change in ownership of the site. This Construction Authorization is subject to compliance with the provisions of the Laws and Rules for Sewage Treatment and Disposal and to the conditions of this permit.

Authorized State Agent: J. LARS Date: 02-12-08 SEE ATTACHED SITE SKETCH
 Construction Authorization Expiration Date: 02-12-2013

HTE# 07-500-18800R

Permit # 24466

Harnett County Department of Public Health Site Sketch

ISSUED TO: H&M Const.

PROPERTY LOCATOR: 1125

SUBDIVISION: FOREST DAKES

LOT # 204

Authorized State Agent: J. L. Amy

Date: 2-12-08

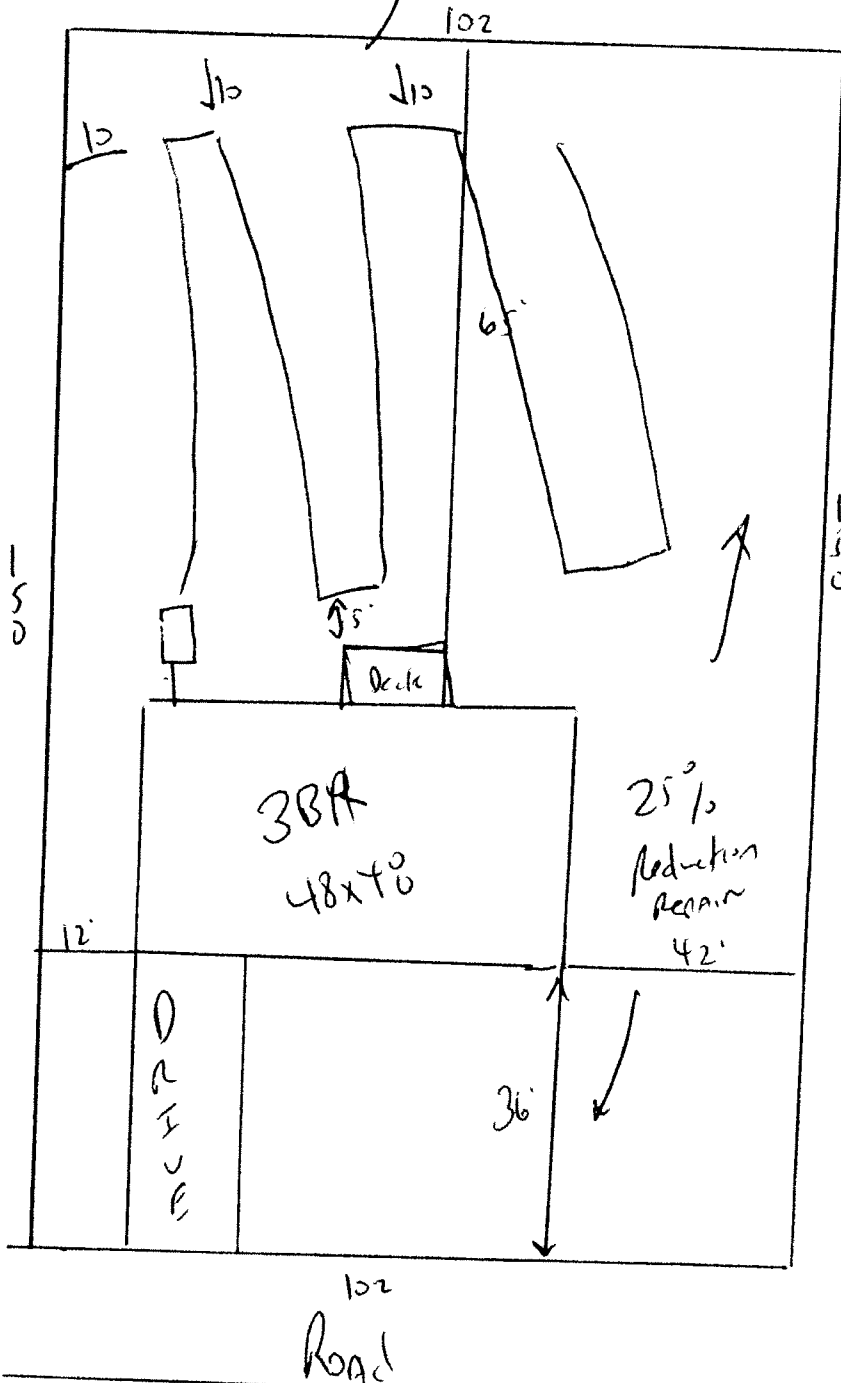

STUB Out Plumbing
Shallows, at ground
level or higher where
shown maintain
All set BACKS

Meet on site ~~(at)~~
for Final layout
MAINTAIN ALL
set BACKS

Install 1x225' of 25%
Reduction system at
18" Deep.