

HTE# 07-5-18629R

Harrison County Department of Public Health

24506

Improvement Permit

A building permit cannot be issued with only an Improvement Permit

ISSUED TO: WYNN CONSTRUCTION
PROPERTY LOCATION: PIONEER FARMS LOT # 4
Type of Structure: NEW [X] REPAIR [] EXPANSION []
Proposed Wastewater System Type: Pump To 25% Reduction
Projected Daily Flow: 360 GPD
Number of bedrooms: 3 Number of Occupants: 6 max
Basement: [] Yes [X] No
Pump Required: [X] Yes [] No
Type of Water Supply: [] Community [X] Public [] Well
Distance from well: 100 feet
Permit valid for: [X] Five years [] No expiration

Authorized State Agent: [Signature] Date: 11/28/07 SEE ATTACHED SITE SKETCH
The issuance of this permit by the Health Department in no way guarantees the issuance of other permits. The permit holder is responsible for checking with appropriate governing bodies in meeting their requirements. This site is subject to revocation if the site plan, plat, or the intended use changes. The Improvement Permit shall not be affected by a change in ownership of the site. This permit is subject to compliance with the provisions of the Laws and Rules for Sewage Treatment and Disposal and to conditions of this permit.

Construction Authorization

(Required for Building Permit)

The construction and installation requirements of Rules .1950, .1952, .1954, .1955, .1956, .1957, .1958, and .1959 are incorporated by references into this permit and shall be met. Systems shall be installed in accordance with the attached system layout.

ISSUED TO: WYNN CONSTRUCTION
PROPERTY LOCATION: PIONEER FARMS LOT # 4
Facility Type: SFO (37'x49'4") [X] New [] Expansion [] Repair
Basement? [] Yes [X] No
Basement Fixtures? [] Yes [X] No
Type of Wastewater System: Pump To 25% Red. (Initial)
Wastewater Flow: 360 GPD
(See note below, if applicable []) LPP (Repair)

Installation Requirements/Conditions

Septic Tank Size: 1000 gallons
Pump Tank Size: 1000 gallons
Exact length of each trench: 240 feet (1 TRENCH)
Trench Spacing: 9 Feet on Center
Soil Cover: 6-8 inches
Maximum Trench Depth: 18-20 inches (Maximum soil cover shall not exceed 36" above the trench bottom)
Pump Requirements: _____ ft. TDH vs. _____ GPM
Aggregate Depth: _____ inches below pipe _____ inches above pipe _____ inches total
Conditions: _____

**If applicable: I understand the system type specified is different from the type specified on the application. I accept the specifications of this permit.

Owner/Legal Representative Signature: _____ Date: _____

This Construction Authorization is subject to revocation if the site plan, plat, or the intended use changes. The Construction Authorization shall not be transferred when there is a change in ownership of the site. This Construction Authorization is subject to compliance with the provisions of the Laws and Rules for Sewage Treatment and Disposal and to the conditions of this permit.

SEE ATTACHED SITE SKETCH
Authorized State Agent: [Signature] Date: 11/28/07
Construction Authorization Expiration Date: 11/28/12

HTE# 07-5-18629R

Permit # 24506

Harnett County Department of Public Health Site Sketch

ISSUED TO: Wynn Construction PROPERTY LOCATOR: _____
SUBDIVISION PIONEER FARMS LOT # 4
Authorized State Agent: [Signature] RS (OLIVER TOLKSPORF) Date: 11/28/07

DRAWING
NTS

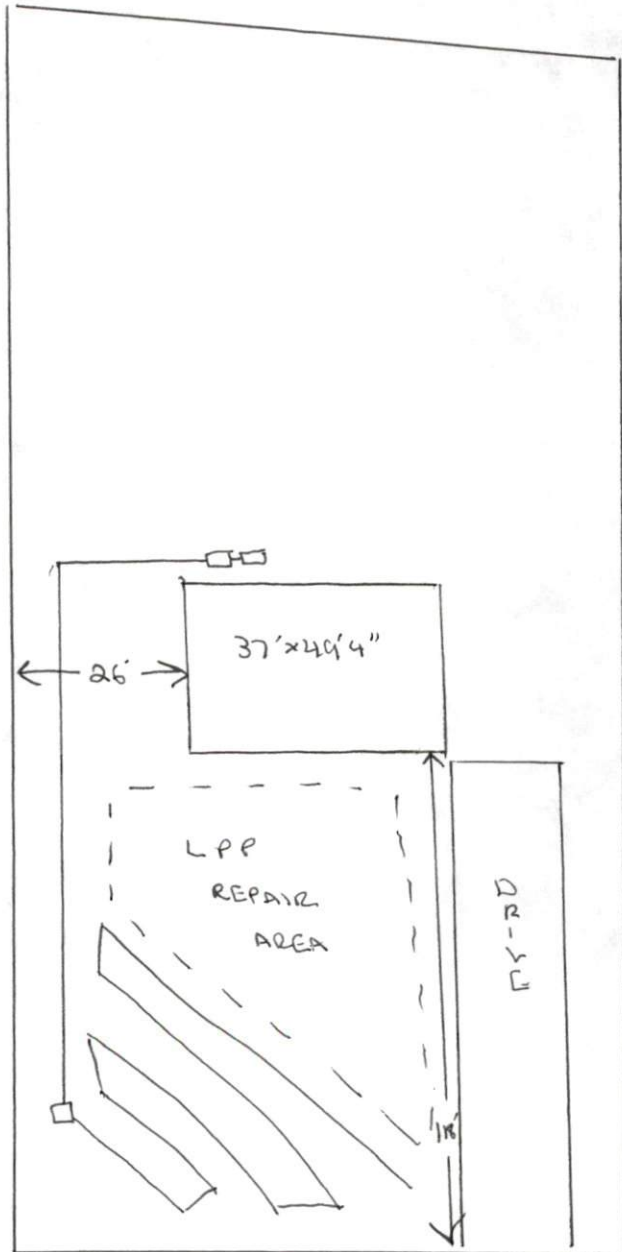

100'
LETCHER LN

292'